

F.A. RTL.	SECTION	COUNTY	TOTAL SHEETS	SHEET NO.
..	..	WILLIAMSON	917	402
STA. 12+75.0000 TO STA. 13+25.0000				
FED. ROAD DIST. NO. ILLINOIS FED. AID PROJECT				
* I-57, 81 O.C.D. IL 13 (FAU 9629)				
** (X1-6-2)VB-2,(X1-6)HBK-2				

DATE _____ BY _____
 SURVEYED _____
 FINAL SURVEY _____
 NOTE BOOK _____
 TEMPLATE _____
 AREAS CHECKED _____
 NO. _____

DATE _____ BY _____
 SURVEYED _____
 ORIGINAL SURVEY _____
 PLOTTED _____
 AREAS CHECKED _____
 NO. _____

DATE = 11/18/2005
 FILE NAME = c:\prow\prow\98950\13.rvt
 PLOT SCALE = 1/8"=1'-0"
 USER NAME = lrfwchrd

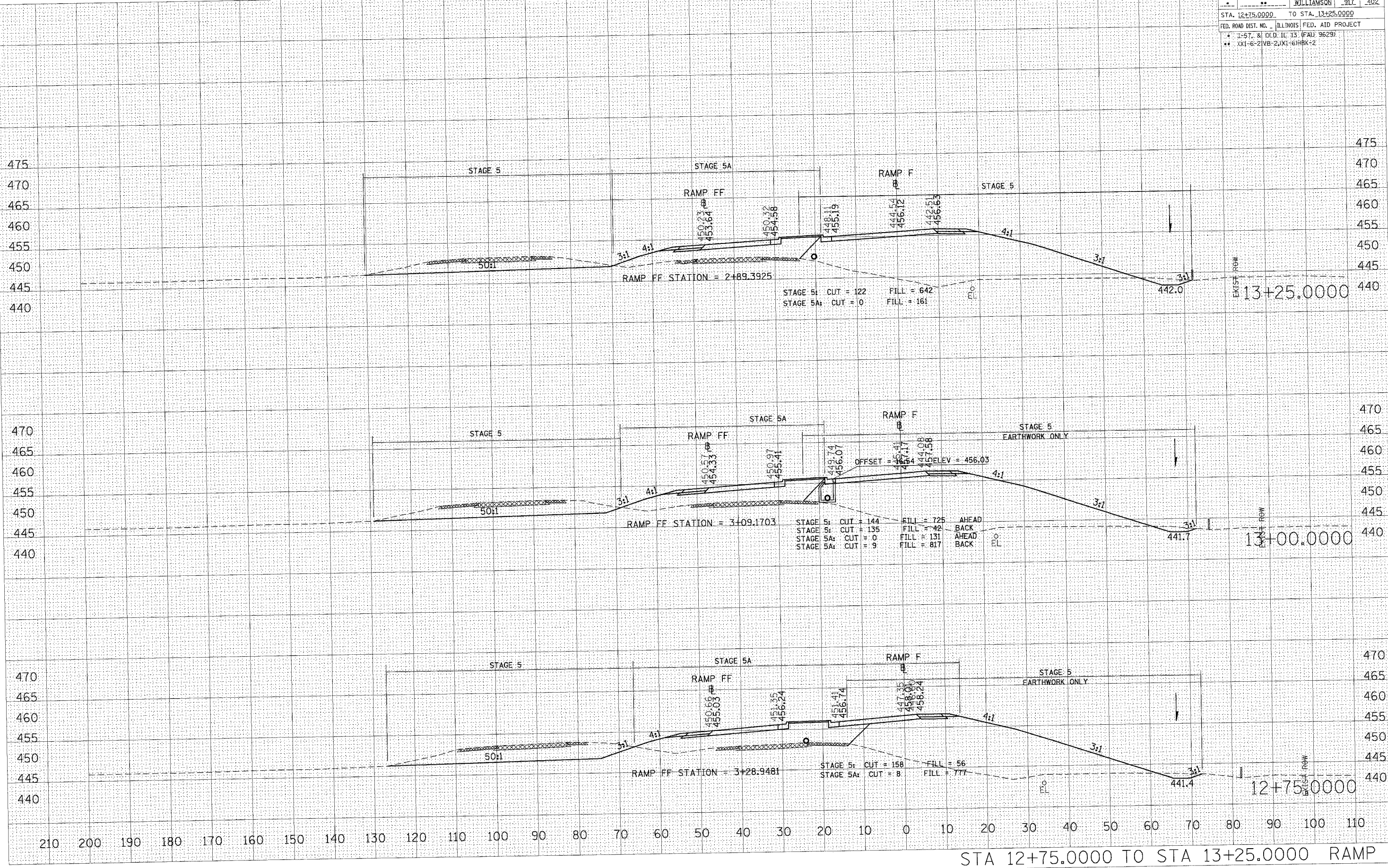

STA 12+75.0000 TO STA 13+25.0000 RAMP F