

F.A. RTE.	SECTION	COUNTY	TOTAL SHEETS	SHEET NO.
**	**	WILLIAMSON	317	403
STA. 13+50.0000 TO STA. 14+00.0000				
FED. ROAD DIST. NO. ILLINOIS FED. AID PROJECT				
* I-57, & OLD IL 13 (FAU) 9629				
** 0X1-6-21VB-2, 2X1-6JHEK-2				

DATE	
BY	
APPROVED	
SURVEY	
NOTE BOOK	
AREAS CHECKED	
NO.	

DATE	
BY	
APPROVED	
SURVEY	
NOTE BOOK	
AREAS CHECKED	
NO.	

PLOT DATE = 11/01/2006
 PLOT SCALE = 10.0000' / IN.
 USER NAME = jefwchd

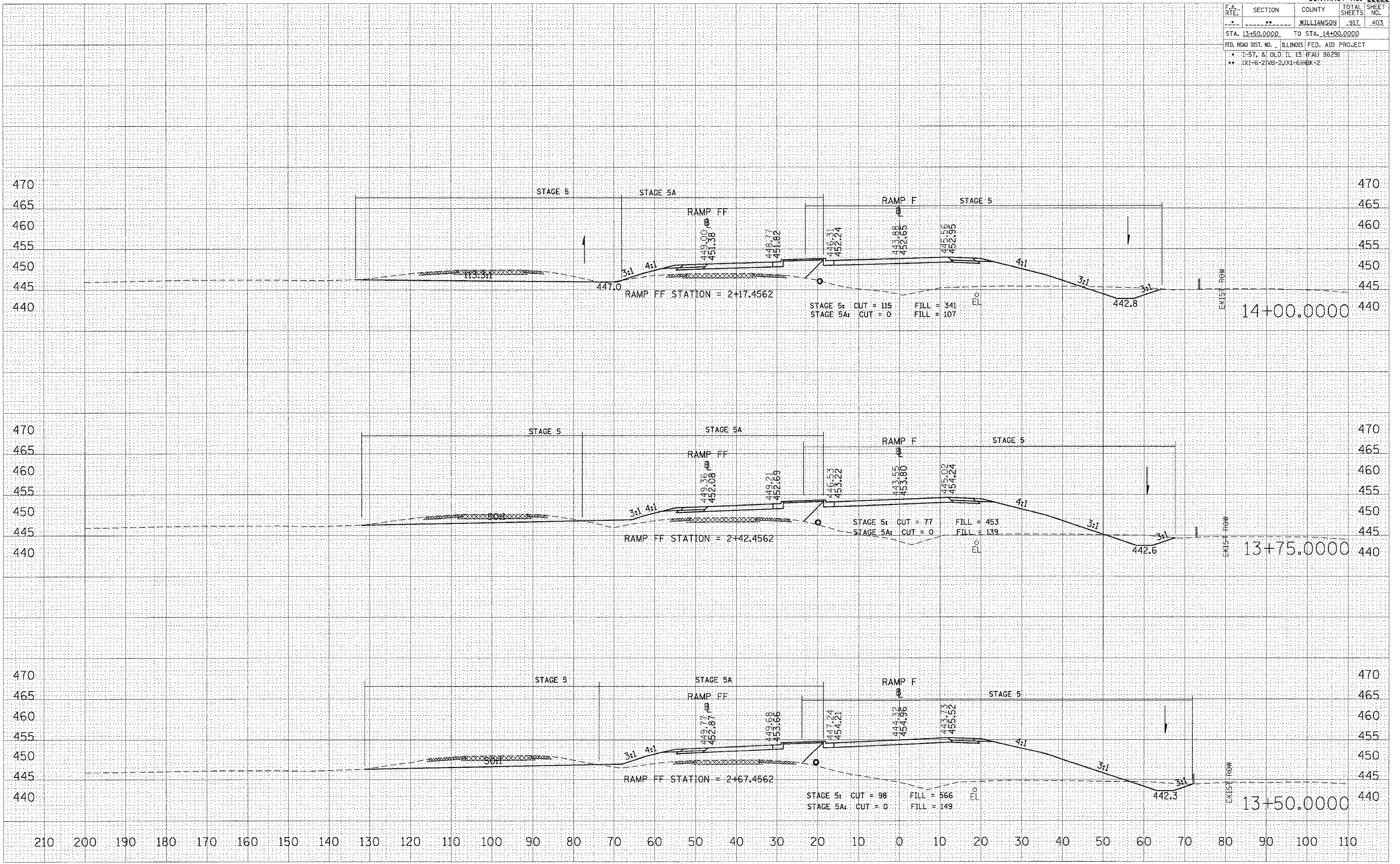

STA 13+50.0000 TO STA 14+00.0000 RAMP F