

F.A. RTE.	SECTION	COUNTY	TOTAL SHEETS	SHEET NO.
*	**	WILLIAMSON	917	521

STA.	TO STA.
FED. ROAD DIST. NO.	ILLINOIS FED. AID PROJECT

* I-57, & OLD IL 13 (FAU 9629)
 ** (X1-6-2)VB-2, (X1-6)HBK-2

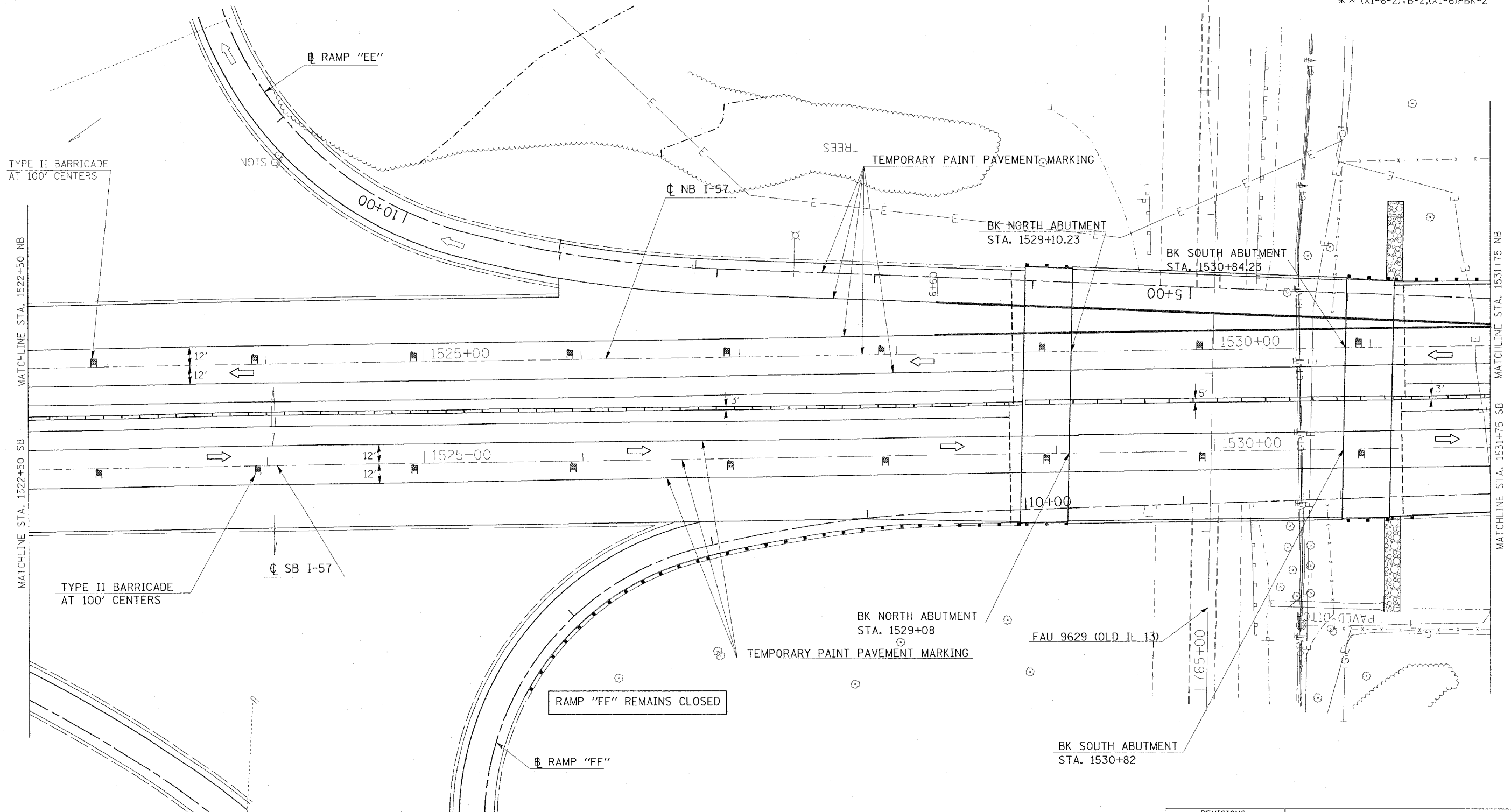

TYPE II BARRICADE AT 100' CENTERS

TYPE II BARRICADE AT 100' CENTERS

RAMP "FF" REMAINS CLOSED

REVISIONS	
NAME	DATE

ILLINOIS DEPARTMENT OF TRANSPORTATION
FAI-57
STAGE 7B
STA. 1522+50 TO STA. 1531+75
SHEET 9 OF 12

SCALE: VERT. APPROX. 30
 DATE: HORIZ.
 DRAWN BY CNH
 CHECKED BY

PLOT DATE = 12/05/2006
 FILE NAME = c:\proj\pervia\982802\01\13\57\stage7b.dgn
 PLOT SCALE = 3/8"=1' IN.
 USER NAME = headon