

F.A.P. RTE.	SECTION	COUNTY	TOTAL SHEETS	SHEET NO.
857	101BR-6	WHITE	100	10
STA. 160+00		TO STA. 174+00		
FED. ROAD DIST. NO.		ILLINOIS	FED. AID PROJECT	

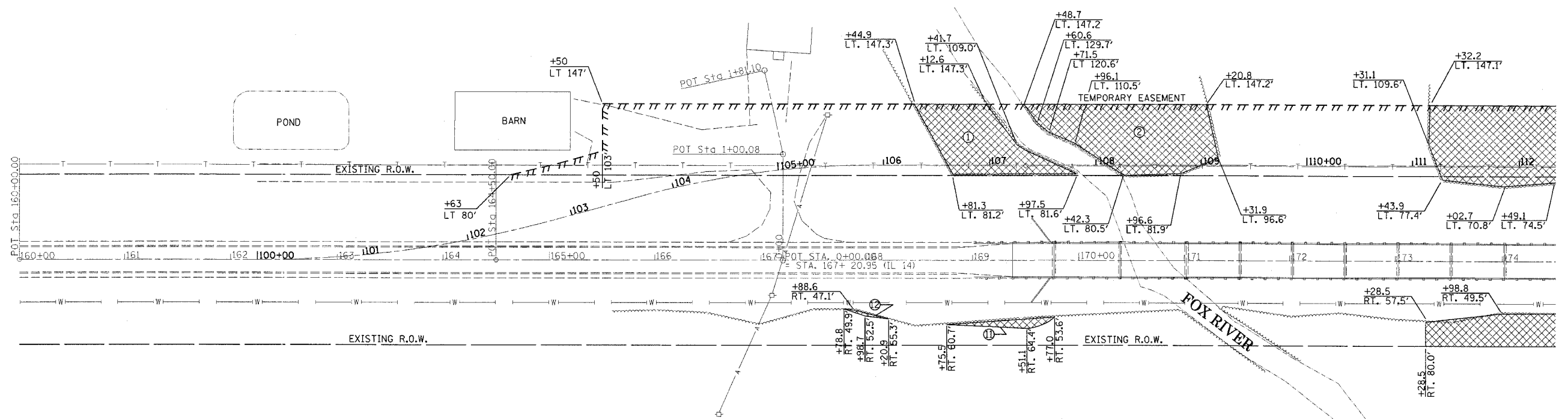

TREE REMOVAL ACRES

- 1 = 5,372.08 SQ. FT.
 - 2 = 8,874.90 SQ. FT.
 - 3 = 29,821.13 SQ. FT.
 - 4 = 120.85 SQ. FT.
 - 5 = 115.44 SQ. FT.
 - 6 = 32.71 SQ. FT.
 - 7 = 884.79 SQ. FT.
 - 8 = 78.36 SQ. FT.
 - 9 = 1,630.44 SQ. FT.
 - 10 = 17,215.26 SQ. FT.
 - 11 = 497.16 SQ. FT.
 - 12 = 66.70 SQ. FT.
- TOTALS = 64,709.82 SQ. FT. = 1.49 ACRE

TREE REMOVAL, ACRES

REVISIONS	
NAME	DATE

ILLINOIS DEPARTMENT OF TRANSPORTATION

Tree Removal Plan

SCALE: VERT.
HORIZ.
DATE

DRAWN BY
CHECKED BY

PLOT DATE = 10/6/2006
FILE NAME = c:\p\projects\94675\tree_removal.dgn
PLOT SCALE = 50.0000' / IN.
USER NAME = sdrstpr