

STATE OF ILLINOIS
DEPARTMENT OF TRANSPORTATION

ROUTE NO.	SECTION	COUNTY	SHEET NO.	SHEET NO.	SHEET NO.
F.A.P. 857	101BR-6	WHITE	100	49	6 SHEETS
FED. ROAD DIST. NO. 7	ILLINOIS	FED. AID PROJECT	Contract #98960		

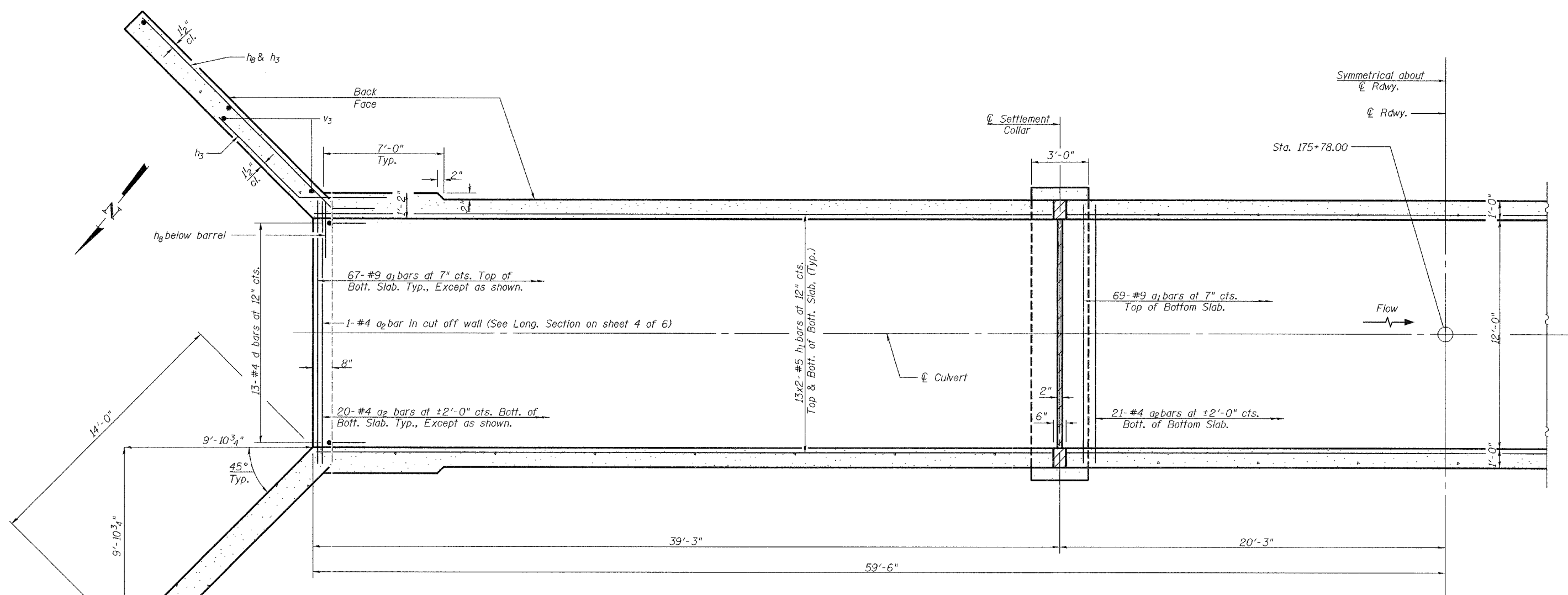

MIN. BAR LAP
#7 Bar = 2'-9"
#5 Bar = 1'-8"

PLAN-BOTTOM SLAB

Notes:
A distance of 7'-0" of the barrel shall be poured monolithically with the wingwalls.
Bars indicated thus 13x2-#5 etc. indicates 13 lines of bars with 2 lengths per line.
For Settlement Collar details, see sheet 6 of 6.
For Section Thru Barrel, bar details, and Bill of Material see sheet 5 of 6.

DESIGNED	Angela J. Bryant
CHECKED	Fess Teklehaimanot
DRAWN	Greg D. Farmer
CHECKED	AJB/FT

December 4, 2006
EXAMINED *Thomas J. Domagalaki*
PASSED *Ralph E. Anderson*
ENGINEER OF BRIDGES AND STRUCTURES

CULVERT DETAILS
F.A.P. RT. 857 SEC. 101BR-6
WHITE COUNTY
STATION 175+78.00
STRUCTURE NO. 097-2014