

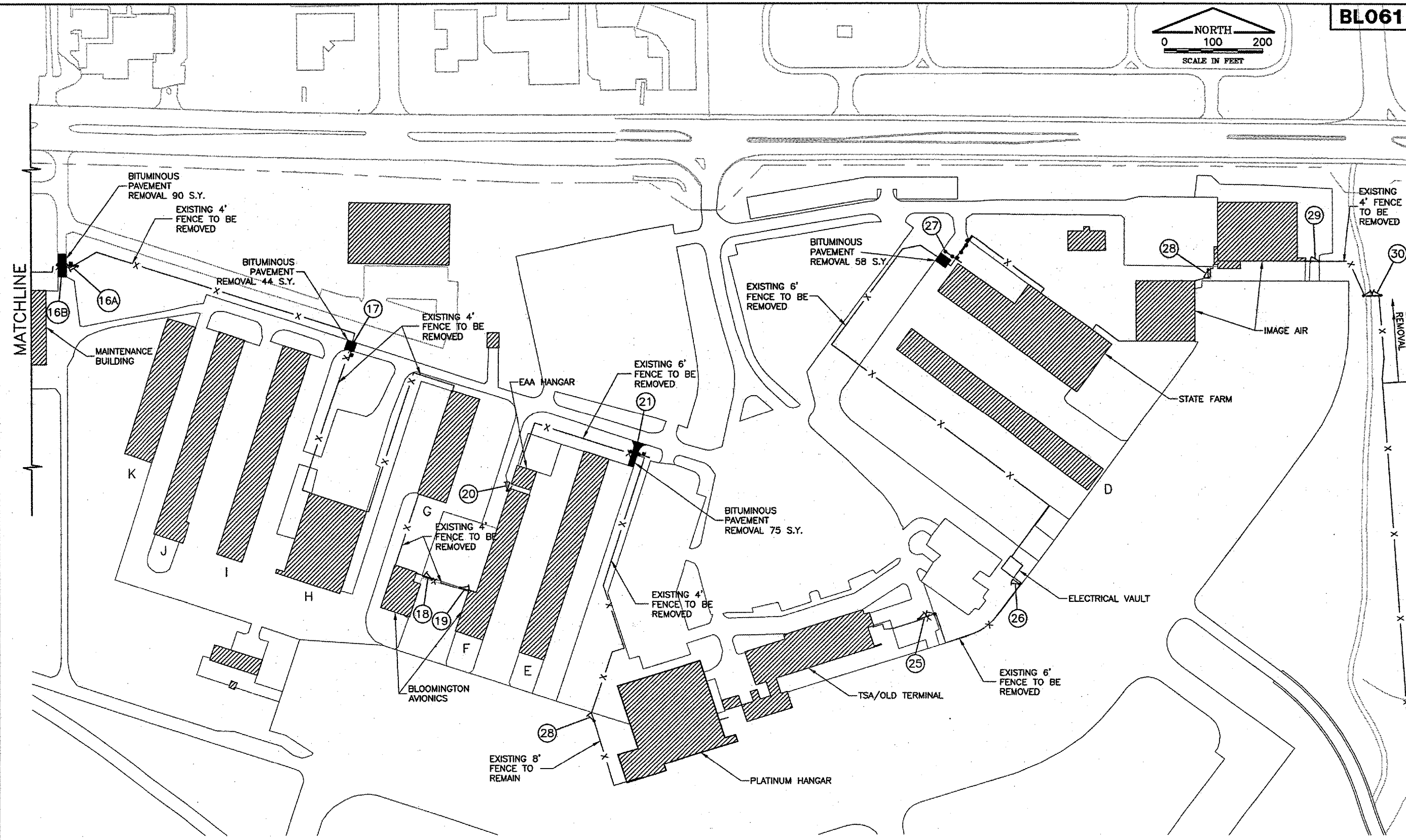

K:\Bloomington\0608503\Draw\Sheets\FILE: 06_ExistFencePlan1.dwg
UPDATE BY: odrughan
SURVEY BOOK #
DATE: Wed 1/10/07 5:35pm
XREF DWG: C:\info.dwg
Security-Base.dwg
surveytopo.DWG
IMAGE FILES: cv-006.tif

REVISIONS		
NUMBER	BY	DATE

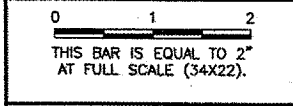

**BLOOMINGTON-NORMAL AIRPORT AUTHORITY
CENTRAL ILLINOIS REGIONAL AIRPORT
BLOOMINGTON, ILLINOIS**

**UPGRADE PERIMETER FENCE PHASE 1
EXISTING FENCE PLAN 1**

NOTES:

1. SEE GATE TABLE SHEET FOR EXISTING GATE TYPE AND PROPOSED IMPROVEMENTS.
2. NEW FENCE WILL BE INSTALLED IN THE SAME LOCATION AS THE EXISTING FENCE UNLESS SHOWN OTHERWISE.
3. SEE PROPOSED GATE PAVEMENT IMPROVEMENT SHEET FOR LIMITS OF PAVEMENT REMOVAL.

LEGEND

- EXISTING MANUAL VEHICLE GATE
- EXISTING MANUAL PEDESTRIAN GATE
- EXISTING ELECTRIC VEHICLE GATE
- EXISTING GATE LOCATION
- EXISTING FENCE
- BITUMINOUS PAVEMENT REMOVAL

© Copyright CMT, Inc.
CMT
CRAWFORD, MURPHY & TILLY, INC.
CONSULTING ENGINEERS
License No. 84-000618

DESIGN BY:	CBG
DRAWN BY:	CMT
CHECKED BY:	RLV
APPROVED BY:	RLV
DATE:	1/12/2007
JOB No:	06085-03-00
ILLINOIS PROJECT BMI-3653 A.I.P. PROJECT 3-17-0006-47	
SHEET 6 OF 26 SHEETS	