

SEE SHEET NO. 21

PROJECT ENDS
ILLINOIS ROUTE 31 BYPASS
STA. 170+08

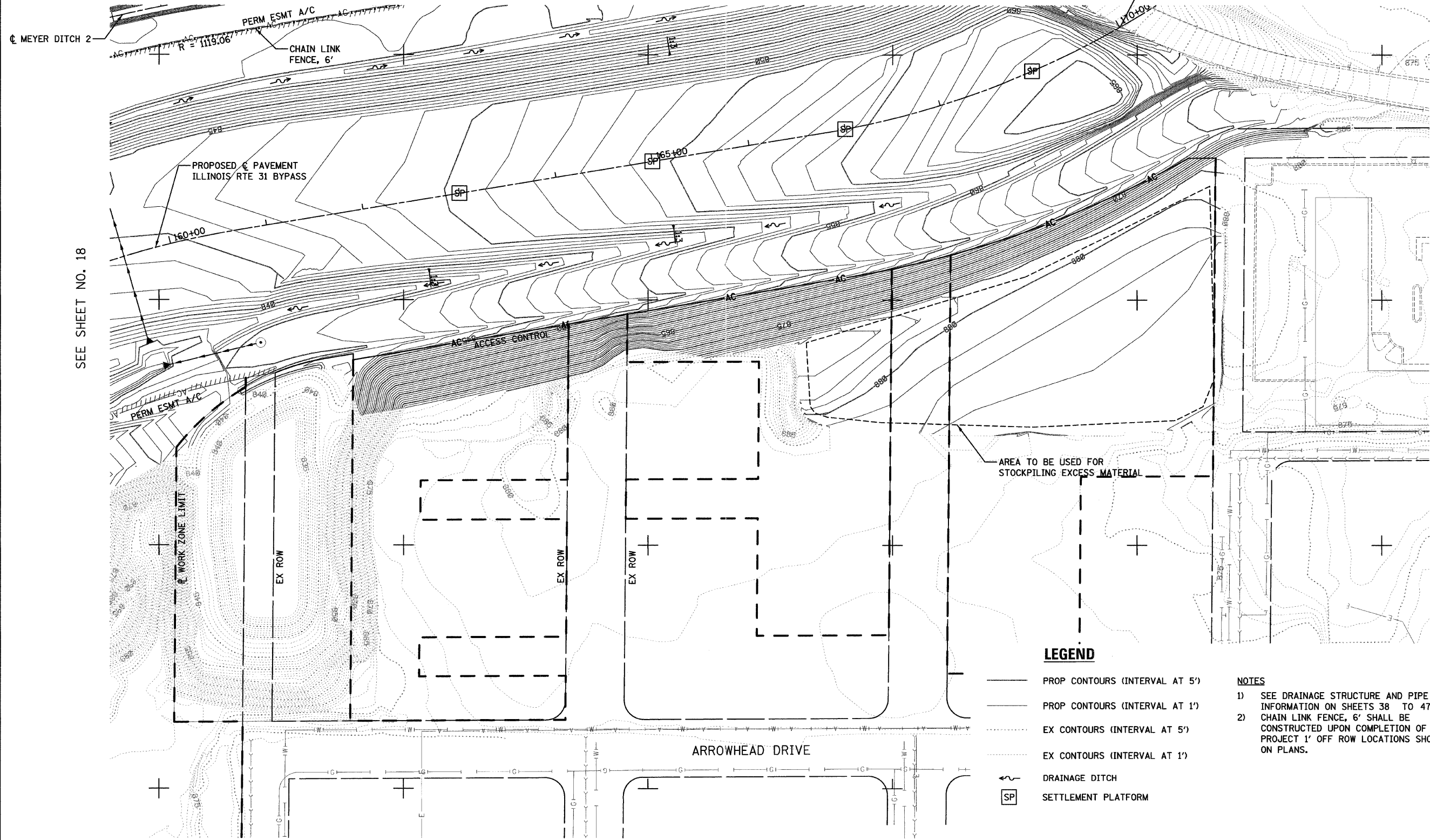

N2007000

N2006750

N2006500

N2006250



- LEGEND**
- PROP CONTOURS (INTERVAL AT 5')
 - PROP CONTOURS (INTERVAL AT 1')
 - - - EX CONTOURS (INTERVAL AT 5')
 - - - EX CONTOURS (INTERVAL AT 1')
 - ~ ~ ~ DRAINAGE DITCH
 - SP SETTLEMENT PLATFORM

- NOTES**
- 1) SEE DRAINAGE STRUCTURE AND PIPE INFORMATION ON SHEETS 38 TO 47.
 - 2) CHAIN LINK FENCE, 6' SHALL BE CONSTRUCTED UPON COMPLETION OF THE PROJECT 1' OFF ROW LOCATIONS SHOWN ON PLANS.

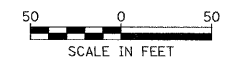

FILE NAME = ...XD160F78-shd-grading-08.dgn

USER NAME = ctb
 PLOT SCALE = 600.0000' / 1" f.t.
 PLOT DATE = 1/27/2012

DESIGNED - KWH
 DRAWN - JES
 CHECKED - GAB
 DATE - 1/20/2012

REVISED -
 REVISED -
 REVISED -
 REVISED -

**STATE OF ILLINOIS
 DEPARTMENT OF TRANSPORTATION**

GRADING PLAN
 SCALE: 1" = 50' SHEET NO. 8 OF 10 SHEETS STA. TO STA.

F.A. RTE.	SECTION	COUNTY	TOTAL SHEETS	SHEET NO.
	18A-1	MCHEMRY	115	19
CONTRACT NO. 60F78				
ILLINOIS FED. AID PROJECT				