

PLAN	SUBMITTED	DATE
	PLOTTED	
	CHECKED	
	BY	
	NO.	
	FILE NAME	

PROFILE	SUBMITTED	DATE
	PLOTTED	
	CHECKED	
	BY	
	NO.	
	FILE NAME	

FILE NAME = P:\2007\ME070802\_Ver-Var-Ph11\Cadd\W030\_IL\_R1\Sh1a\08-D160P38-sh1-prf.dgn  
 PLOT SCALE = 1"=50'  
 USER NAME = Kilianna Professional Services

- NOTES:
- PROPOSED LEVELING BINDER (MACHINE METHOD), IL-9.5, N70, (3/4").  
 PROPOSED POLYMERIZED HMA SURFACE COURSE, MIX. F, N90, 1 3/4"
  - SEE BRIDGE PLANS FOR ELEMENTS OF DESIGN ASSOCIATED WITH THE BRIDGE AND APPROACH SLABS.

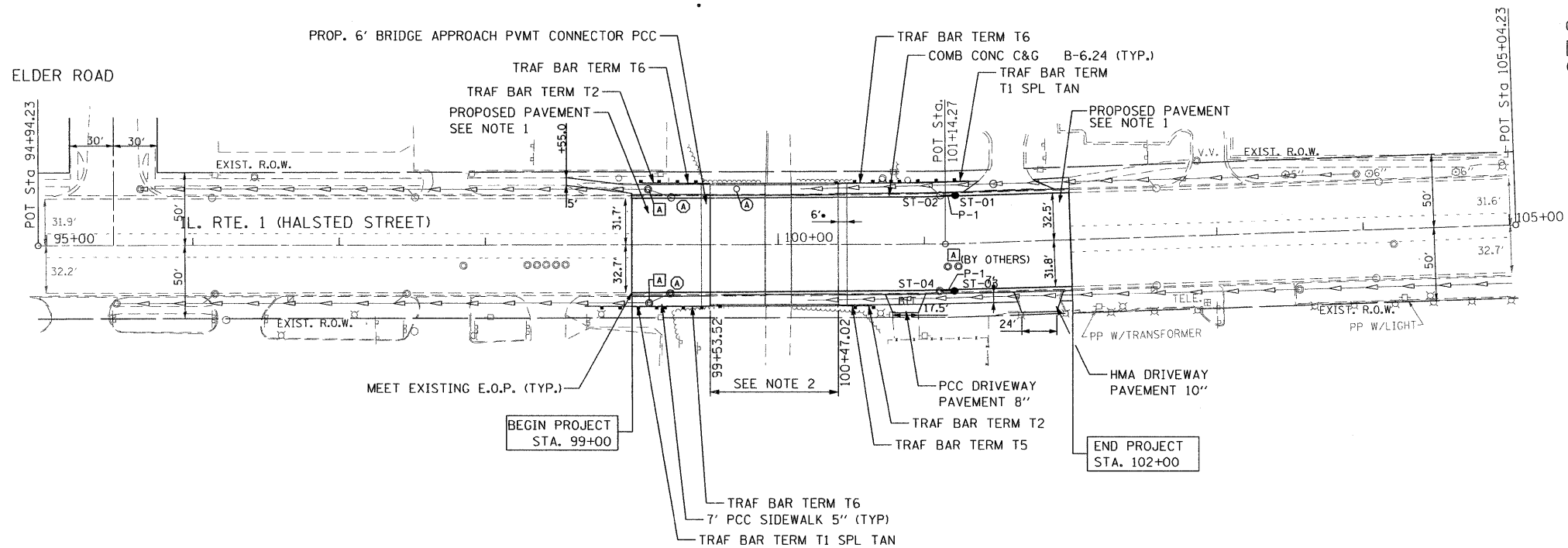

- (A) FRAME AND LID TO BE ADJUSTED
  - (B) FRAMES AND GRATES TO BE ADJUSTED
  - (C) WATER VALVES TO BE ADJUSTED
- ST-01  
 STA 101+21 . 32.0 'LT  
 2' CB TYPE C  
 W/ FR & LIDS T1, QL  
 RIM = 635.95  
 INV (S) = 632.45
- ST-02 EXISTING CB  
 STA 101+11 . 32.0 'LT  
 FR&LID TO BE ADJUSTED  
 RIM = 635.95  
 INV(SW) = 631.14 AS-BUILT
- ST-03  
 STA 101+21 . 32.0 'RT  
 2' CB TYPE C  
 W/ FR & LIDS T1, QL  
 RIM = 635.95  
 INV (S) = 632.45
- ST-04 EXISTING CB  
 STA 101+11 . 32.0 'RT  
 FR&LID TO BE ADJUSTED  
 RIM = 635.95  
 INV(SW) = 631.14 AS-BUILT
- P-1  
 8 LF - 12" RCP  
 CL A. TY-1, BF = 2.5 CY

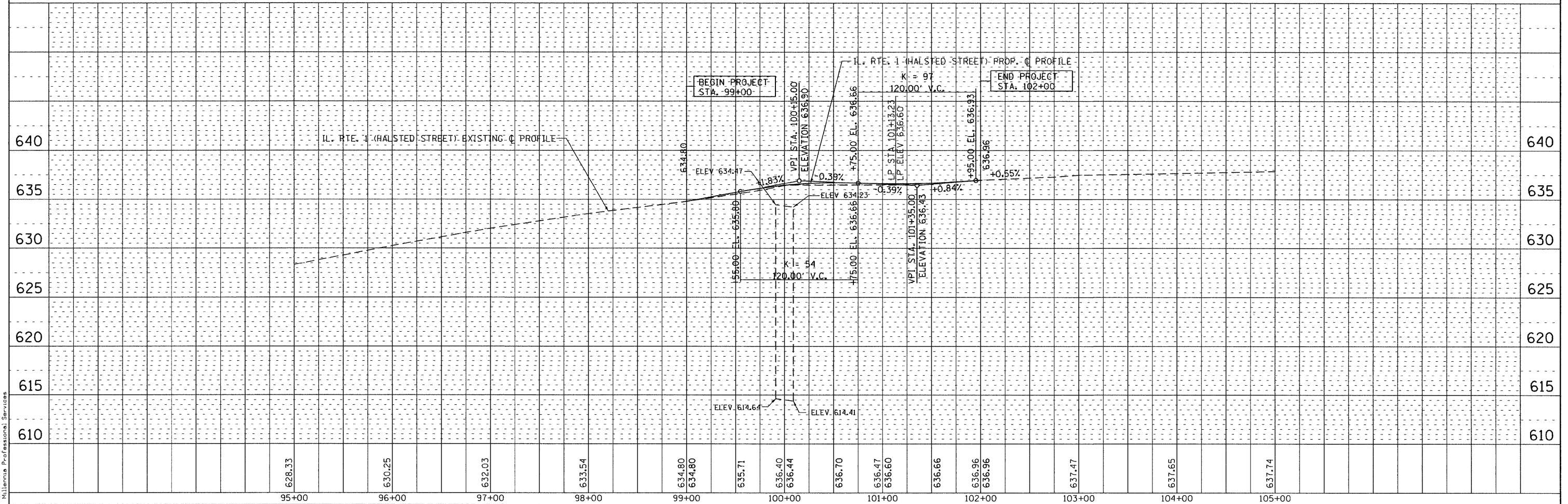

DESIGNED - CJD	REVISED -	<b>STATE OF ILLINOIS</b> <b>DEPARTMENT OF TRANSPORTATION</b> <b>ILLINOIS ROUTE 1 (HALSTED ST)</b> <b>OVER IC RR (ABANDONED) (SN 016-2859)</b>	<b>PLAN AND PROFILE</b>		F.A.P. RTE. 876	SECTION 2011-032-BR	COUNTY COOK	TOTAL SHEETS 41	SHEET NO. 8
DRAWN - CJD	REVISED -		SCALE: 1"=50'		CONTRACT NO. 60P38				
CHECKED - TVN	REVISED -		SHEET NO. 1 OF 1 SHEETS		FED. ROAD DIST. NO. 1 ILLINOIS FED. AID PROJECT				
DATE - 11/14/2011	REVISED -		STA. 99+00 TO STA. 102+00		P:\2007\ME070802_Ver-Var-Ph11\Cadd\W030_IL_R1\Sh1a\08-D160P38-sh1-prf.dgn				



200 22ND Street, Suite 216, Lombard, IL 60148  
 630.705.0110 voice, 630.839.2566 fax  
 WWW.MPS-IL.COM  
**MILLENNIA PROFESSIONAL SERVICES**