

- LEGEND:**
- CLASS D PATCHES, TYPE III, 10 INCH
 - DRIVEWAY PAVEMENT REMOVAL
 - EARTH EXCAVATION
 - SHOULDER RUMBLE STRIP REMOVAL
 - LINEAR ITEMS REMOVAL

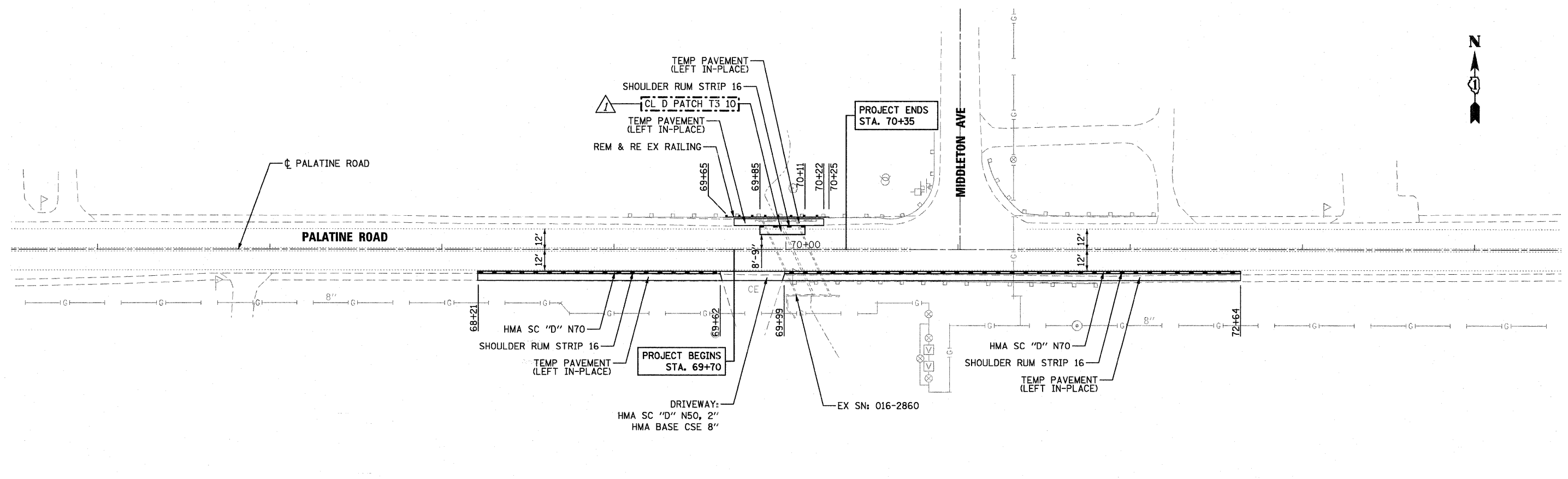

FILE NAME =
...D168P39-sht-plan.dgn



DESIGNED - ADW	REVISED - RJD 11/15/2011
DRAWN - GEW	REVISED - 2/14/2012, A.D.W.
CHECKED - RJD	REVISED -
DATE - 12/12/2011	REVISED -

**STATE OF ILLINOIS
DEPARTMENT OF TRANSPORTATION**

**PALATINE ROAD OVER SALT CREEK
EXISTING & PROPOSED PLAN**

SCALE: 1"=30' SHEET NO. 1 OF 1 SHEETS STA. 69+70 TO STA. 70+35

F.A.U. RTE. 1285	SECTION 2011-033-T	COUNTY COOK	TOTAL SHEETS 18	SHEET NO. 6
CONTRACT NO. 60P39			ILLINOIS FED. AID PROJECT	