

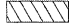

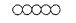

LEGEND

-  WORK ZONE
-  IMPACT ATTENUATOR, TEMPORARY
-  TEMPORARY CONCRETE BARRIER
-  SIGN
-  TYPE II BARRICADE, DRUM, OR VERTICAL BARRICADE WITH STEADY BURN MONODIRECTIONAL LIGHT
-  ARROWBOARD

STAGE I CONSTRUCTION:

1. PERFORM OVERNIGHT WESTBOUND I-90 RIGHT LANE CLOSURE IN ACCORDANCE WITH HIGHWAY STANDARD 701400-05 AND AS SHOWN IN THE PLANS.
2. INSTALL PROTECTIVE SHIELD SYSTEM IN ACCORDANCE WITH STRUCTURAL PLANS.

NOTES:

1. LEFT AND CENTER LANE ON I-90 SHALL BE IN CLOSED ACCORDANCE WITH HIGHWAY STANDARDS 701400-05, 701401-06 AND 701446-03 AS REQUIRED.

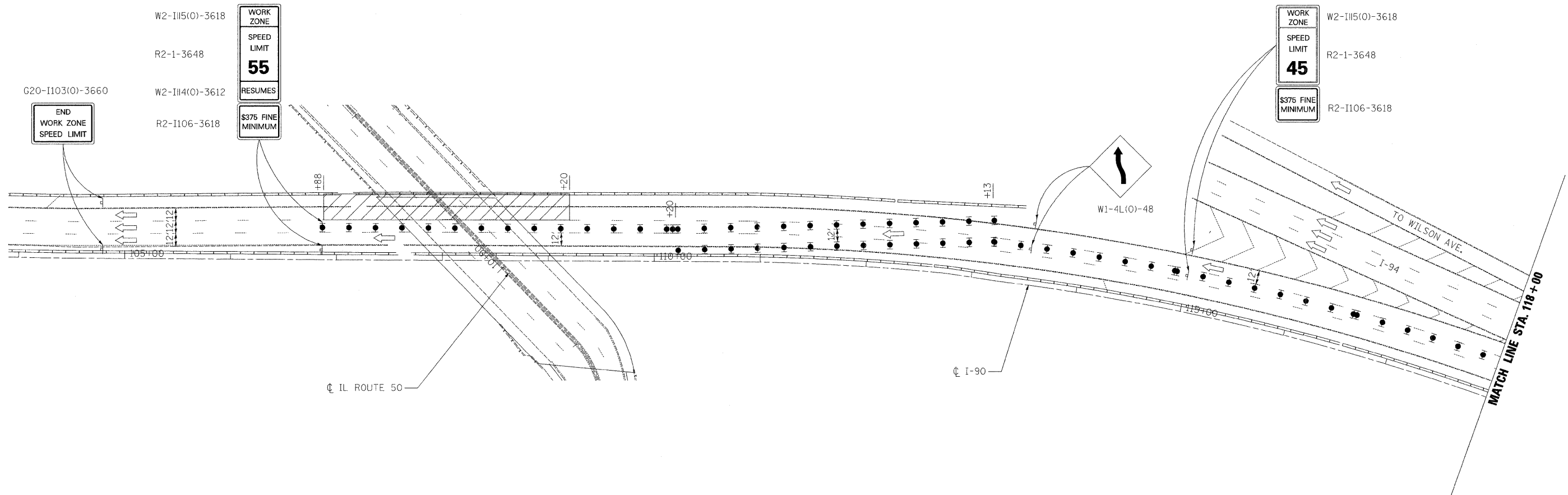

USER NAME = Plotted by Fred 576
 DESIGNED - SEW
 DRAWN - RK
 CHECKED - SEW
 DATE - 1/2012

REVISIED -
 REVISIED -
 REVISIED -

**STATE OF ILLINOIS
 DEPARTMENT OF TRANSPORTATION**

**MAINTENANCE OF TRAFFIC - I-90
 F.A.I. 90 (I-90) AT ILL 50 (CICERO AVENUE)**

SCALE: 1"=50' SHEET NO. 1 OF 2 SHEETS STA. 104+00 TO STA. 118+00

F.A.P. RTE.	SECTION	COUNTY	TOTAL SHEETS	SHEET NO.
350	2011-063-I	COOK	18	5A
FED. ROAD DIST. NO. 1 ILLINOIS FED. AID PROJECT			CONTRACT NO. 60P82	