

STAGE I REMOVAL & CONSTRUCTION

(Looking North)

* Contractor shall take precaution so as not to damage the existing utilities during excavation and backfill. Temporary support shall be provided if required cost included with structure excavation.

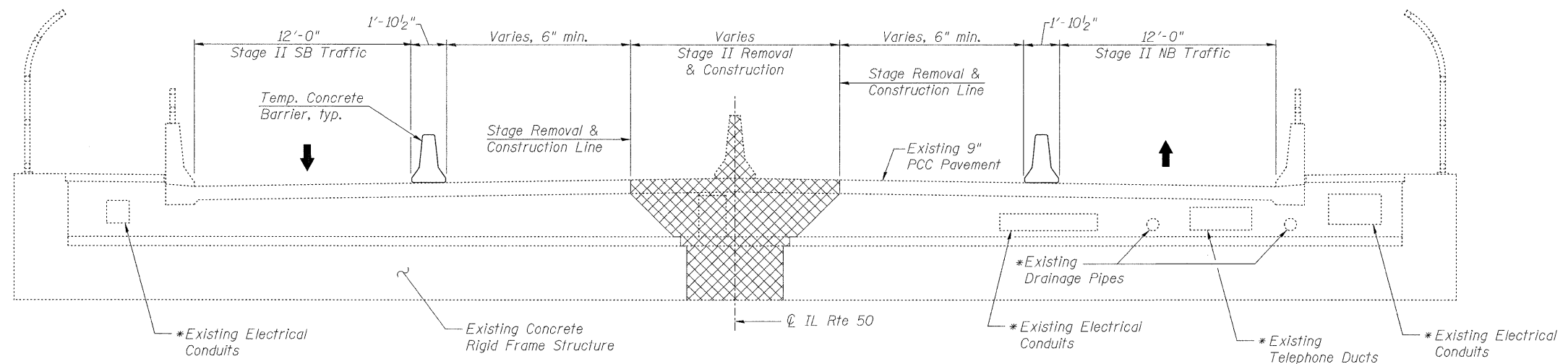

STAGE II REMOVAL & CONSTRUCTION

(Looking North)

PROTECTIVE SHIELDING/FALSEWORK NOTES

A protective shield system shall be provided per Article 501.03 of the Standard Specifications prior to the partial removal of the concrete superstructure. The design loading shall be determined by the Contractor's Illinois Licensed Structural Engineer. This system may also be designed and act as falsework for pouring the new concrete per Articles 503.05 and 503.06 of the Standard Specifications.

The system shall extend a minimum of one foot beyond the width of concrete removal areas that have been approved by the Engineer and shall extend full length from face of pier to face of abutment wall. The system shall allow for a minimum vertical clearance of 13'-6" to be maintained during construction. Please refer to other notes in the plans or in the special provisions regarding required signage when reducing the existing clearance on I-90.

A temporary lane closure on I-90 will be allowed for the placement and removal of the system. No permanent lane closures will be allowed on I-90. Refer to the special provisions for the allowable temporary closures on I-90. Protective shielding may be required to protect live traffic during the temporary lane closure. All work on the structure shall be performed from above on IL Route 50. The Contractor has the option of supporting the system from above the rigid frame structure.

The Contractor shall submit detailed plans for the system, prepared and sealed by an Illinois Licensed Structural Engineer, for examination and approval by the Engineer. Cost of all work relating to the Protective Shielding / Falsework shall be included in the pay item Concrete Superstructure.

Notes:

See sheet 3 of 7 for details of Temporary Concrete Barrier.
See Roadway plans for quantities of Temporary Concrete Barrier.
Cross hatched area indicates removal of PCC Pavement, Sidewalk or Barrier, and excavation of PGE Material as required to access deteriorated portion of rigid frame structure.



USER NAME =	DESIGNED - TBP	REVISED -
FILE NAME =	CHECKED - MTH	REVISED -
PLOT SCALE =	DRAWN - AJF	REVISED -
PLOT DATE =	CHECKED - MTH	REVISED -

**STATE OF ILLINOIS
DEPARTMENT OF TRANSPORTATION**

**STAGE CONSTRUCTION DETAILS
STRUCTURE NO. 016-0400**

SHEET NO. 2 OF 7 SHEETS

F.A.P. RTE.	SECTION	COUNTY	TOTAL SHEETS	SHEET NO.
350	2011-063-1	COOK	18	8
			CONTRACT NO. 60P82	
ILLINOIS FED. AID PROJECT				