

GENERAL NOTES:

PLAN DIMENSIONS AND DETAILS RELATIVE TO EXISTING PLANS ARE SUBJECT TO NOMINAL CONSTRUCTION VARIATIONS. THE CONTRACTOR SHALL FIELD VERIFY EXISTING DIMENSIONS AND DETAILS AFFECTING NEW CONSTRUCTION AND MAKE NECESSARY APPROVED ADJUSTMENT PRIOR TO CONSTRUCTION OR ORDERING OF MATERIALS. SUCH VARIATIONS SHALL NOT BE CAUSE FOR ADDITIONAL COMPENSATION FOR A CHANGE IN SCOPE OF THE WORK. HOWEVER, THE CONTRACTOR WILL BE PAID FOR THE QUANTITY ACTUALLY FURNISHED BASED AT THE UNIT PRICE BID FOR THE WORK.

ALL STRUCTURAL STEEL SHALL CONFORM TO AASHTO CLASSIFICATION M-270 GR. 36, UNLESS OTHERWISE NOTED.

REINFORCEMENT BARS DESIGNATED (E) SHALL BE EPOXY COATED.

EXISTING REINFORCEMENT BARS EXTENDING INTO THE REMOVAL AREA SHALL BE CLEANED, STRAIGHTENED AND INCORPORATED INTO THE NEW CONSTRUCTION. ANY REINFORCEMENT BARS THAT ARE DAMAGED DURING CONCRETE REMOVAL SHALL BE REPLACED WITH AN APPROVED BAR SPLICER OR ANCHORAGE SYSTEM. COST INCLUDED WITH CONCRETE REMOVAL.

CONCRETE SUPERSTRUCTURE SHALL HAVE A SEVEN DAY MINIMUM CURE.

JOINT OPENINGS SHALL BE ADJUSTED ACCORDING TO ARTICLE 520.04 OF THE STANDARD SPECIFICATIONS, WHEN THE DECK IS POURED AT AN AMBIENT TEMPERATURE OTHER THAN 50° F.

TOTAL BILL OF MATERIALS

ITEM	UNIT	QUANTITY
REINFORCEMENT BARS (EPOXY COATED)	POUND	1090
CONCRETE REMOVAL	CU.YD.	9.4
CONCRETE SUPERSTRUCTURE	CU.YD.	9.4
PREFORMED JOINT STRIP SEAL	FOOT	230
ELASTOMERIC BEARING ASSEMBLY, TYPE I	EACH	12
ELASTOMERIC BEARING ASSEMBLY, TYPE II	EACH	12
STRUCTURAL REPAIR OF CONCRETE (DEPTH ≤ 5")	SQ.FT.	75
FURNISHING AND ERECTING STRUCTURAL STEEL	POUND	3342
BAR SPLICERS	EACH	16
PROTECTIVE COAT	SQ.YD.	2296
JACK AND REMOVE EXISTING BEARINGS	EACH	24
ANCHOR BOLTS 1"Ø	EACH	48
SIDEWALK REMOVAL	SQ.FT.	220
PORTLAND CEMENT CONCRETE SIDEWALK 5"	SQ.FT.	220

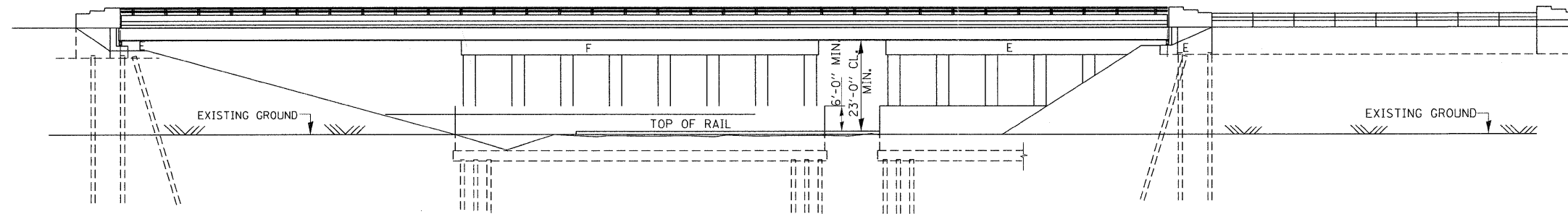

ELEVATION

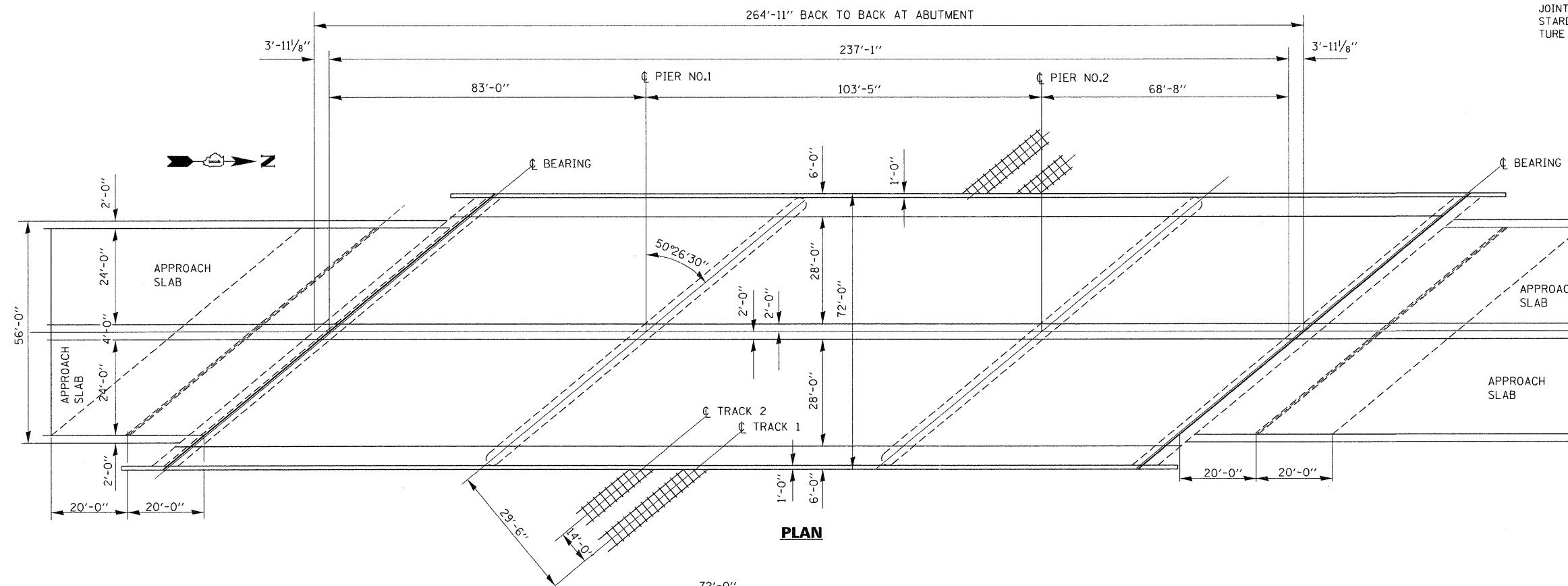

PLAN

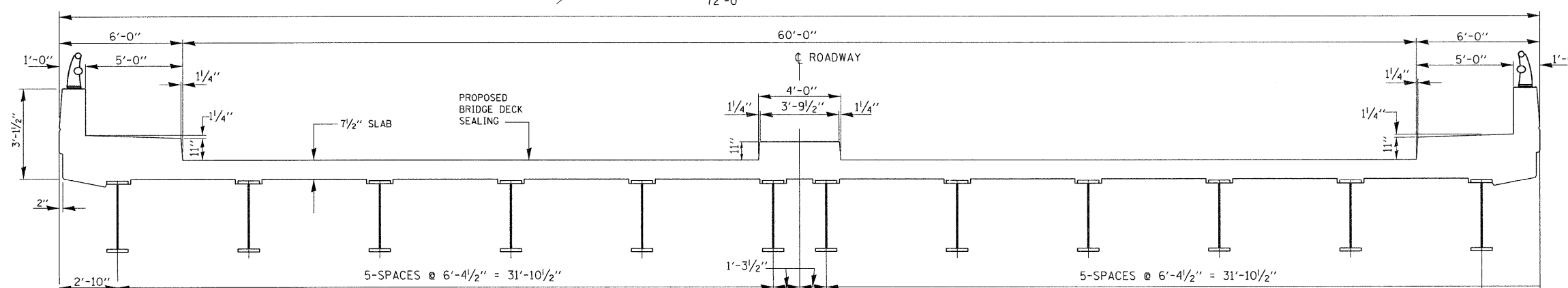

**CROSS SECTION
(LOOKING SOUTH)**



David Carl Puzey 1/24/12
Expires 1/30/12

FILE NAME =	USER NAME = curryw	DESIGNED - MVT	REVISED -	STATE OF ILLINOIS DEPARTMENT OF TRANSPORTATION	ILLINOIS 50 (CICERO AVENUE) BRIDGE OVER B&O.CTRR TRACKS GENERAL PLAN, ELEVATION AND CROSS SECTION S.N. 016-2429	F.A.P. RTE.	SECTION	COUNTY	TOTAL SHEETS	SHEET NO.
c:\pwwork\pwwork\curryw\d0282133\0162429\1-ah-t-plan.dgn	DRAWN - MVT	REVISED -	350			2011-064-1	COOK	28	4	
PLOT SCALE = 1/74.8967' / 1"	CHECKED - AWC	REVISED -	CONTRACT NO. 60P83							
PLOT DATE = 1/25/2012	DATE - 1-4-2012	REVISED -	ILLINOIS FED. AID PROJECT							