

PLAN	REVISIONS	DATE
NO.	BY	DA.
NO.	BY	DA.
NO.	BY	DA.
NO.	BY	DA.
NO.	BY	DA.
NO.	BY	DA.
NO.	BY	DA.
NO.	BY	DA.
NO.	BY	DA.
NO.	BY	DA.

PROFILE	REVISIONS	DATE
NO.	BY	DA.
NO.	BY	DA.
NO.	BY	DA.
NO.	BY	DA.
NO.	BY	DA.
NO.	BY	DA.
NO.	BY	DA.
NO.	BY	DA.
NO.	BY	DA.
NO.	BY	DA.

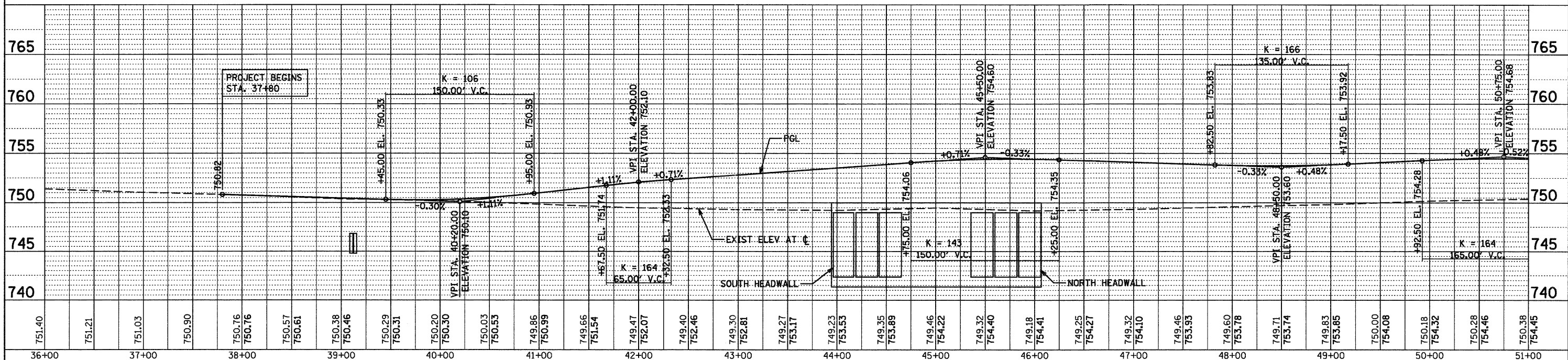
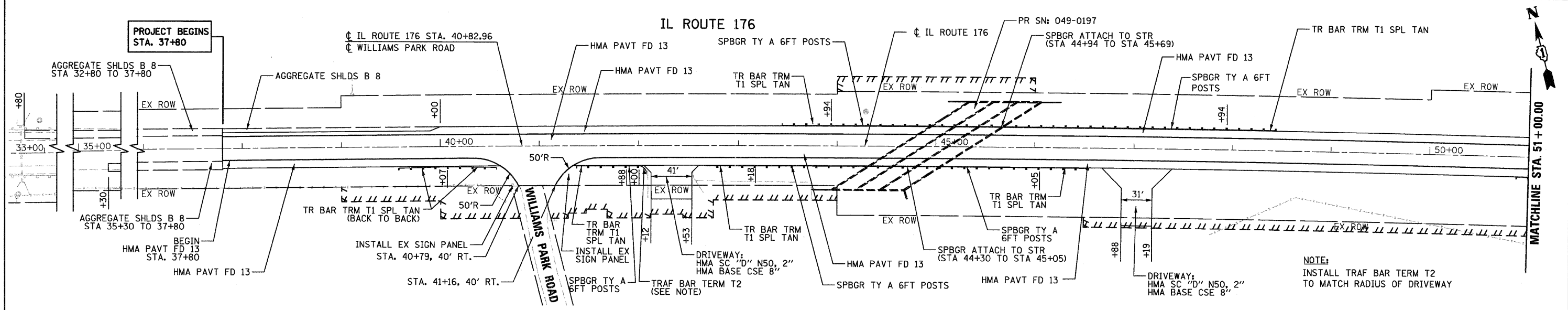
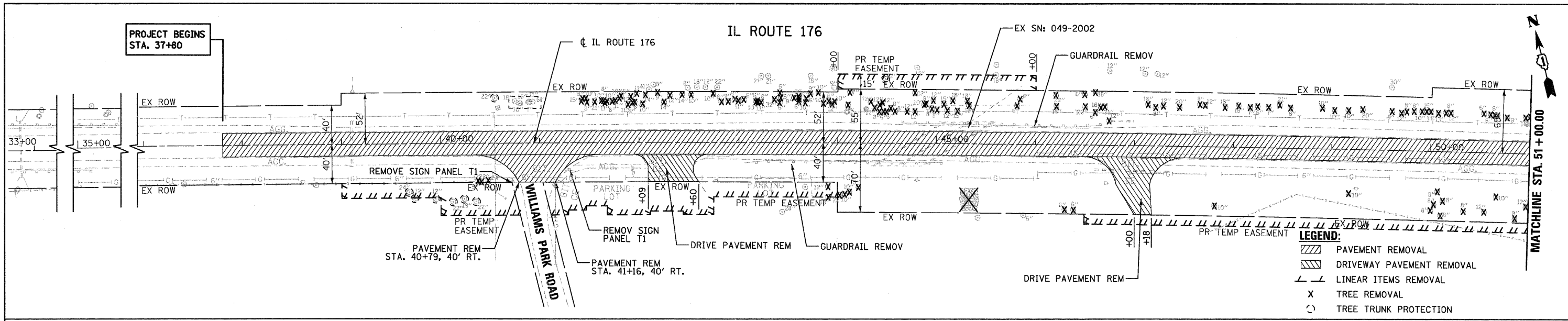

FILE NAME = ...\\D162187-sht-plnprf_01.dgn	DESIGNED ADW	REVISIONS -	STATE OF ILLINOIS DEPARTMENT OF TRANSPORTATION IL ROUTE 176 (SLOCUM LAKE ROAD) OVER BANGS LAKE DRAINAGE DITCH EXISTING & PROPOSED PLAN AND PROFILE SCALE: 1"=50' SHEET NO. 1 OF 2 SHEETS STA. 37+80 TO STA. 51+00	F.A.P. RTE. 335	SECTION 145 X-T	COUNTY LAKE	TOTAL SHEETS 80	SHEET NO. 10
	DRAWN GEW	REVISIONS -						
	CHECKED RJD	REVISIONS -						
	DATE 9/14/2011	REVISIONS -						
			CONTRACT NO. 62187 ILLINOIS FED. AID PROJECT					