

FINAL SURVEY	SURVEYED	BY	DATE
NOTE BOOK	PORTED		
NO.	AREAS CHECKED		

ORIGINAL SURVEY	SURVEYED	BY	DATE
NOTE BOOK	PORTED		
NO.	AREAS CHECKED		

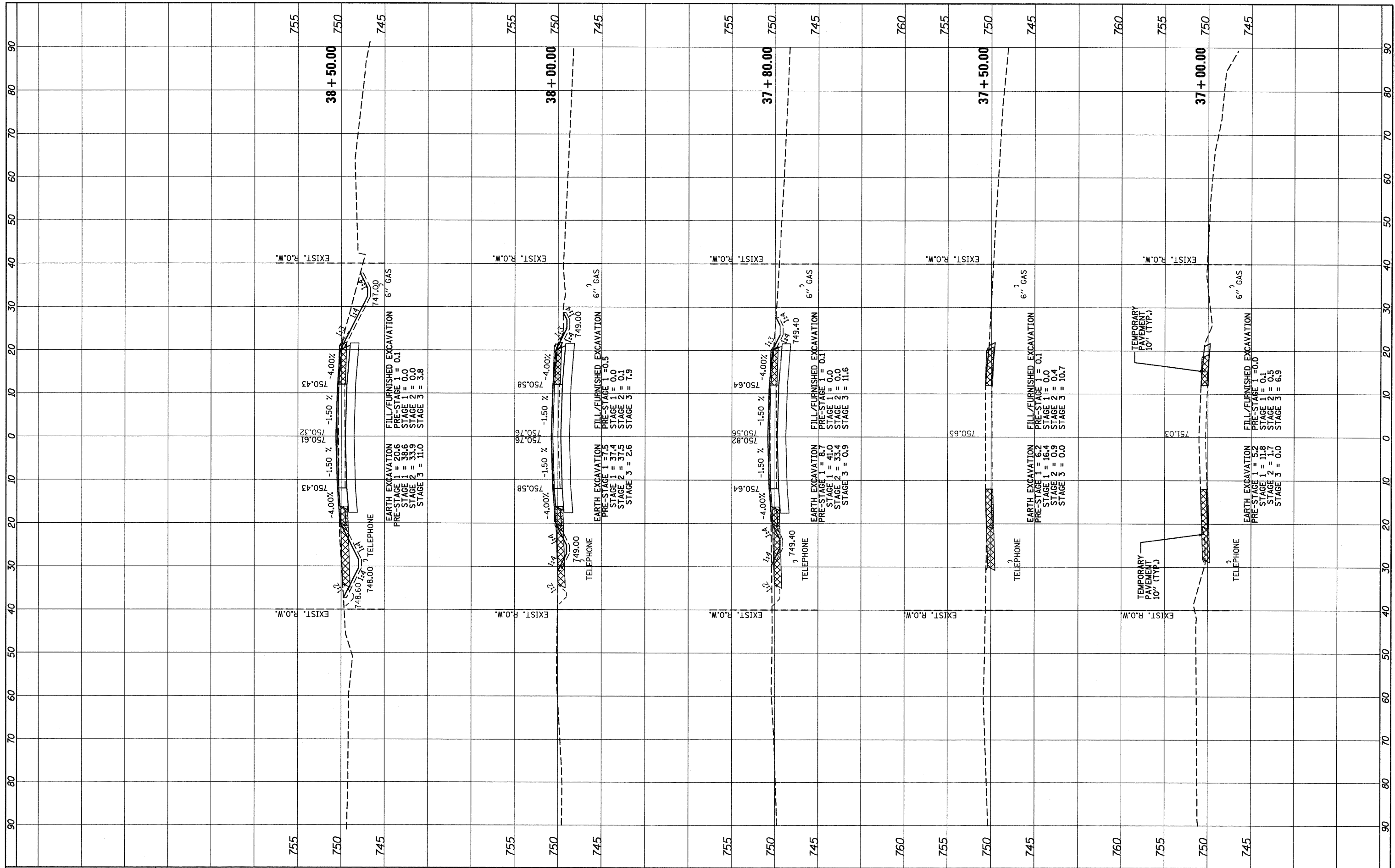

FILE NAME = ...DI62187-sht-xssht.dgn



DESIGNED	- ADW	REVISED	-
DRAWN	- GEW	REVISED	-
CHECKED	- RJD	REVISED	-
DATE	- 9/14/2011	REVISED	-

REVISED	-
REVISED	-
REVISED	-
REVISED	-

STATE OF ILLINOIS  
DEPARTMENT OF TRANSPORTATION

IL ROUTE 176 (SLOCUM LAKE ROAD) OVER BANGS LAKE DRAINAGE DITCH  
CROSS SECTIONS

SCALE: 1"=10' (HORIZ.) 1"=5' (VERT.) SHEET NO. 3 OF 16 SHEETS STA. 37+00.00 TO STA. 38+50.00

F.A.P. R.T.E.	SECTION	COUNTY	TOTAL SHEETS	SHEET NO.
335	145 X-T	LAKE	80	67
CONTRACT NO. 62187			ILLINOIS FED. AID PROJECT	