

FINAL SURVEY	SURVEYED	BY	DATE
NOTE BOOK	PLOTTED		
AREAS CHECKED	TEMPLATE		
NO.	AREAS CHECKED		

ORIGINAL SURVEY	SURVEYED	BY	DATE
NOTE BOOK	PLOTTED		
AREAS CHECKED	TEMPLATE		
NO.	AREAS CHECKED		

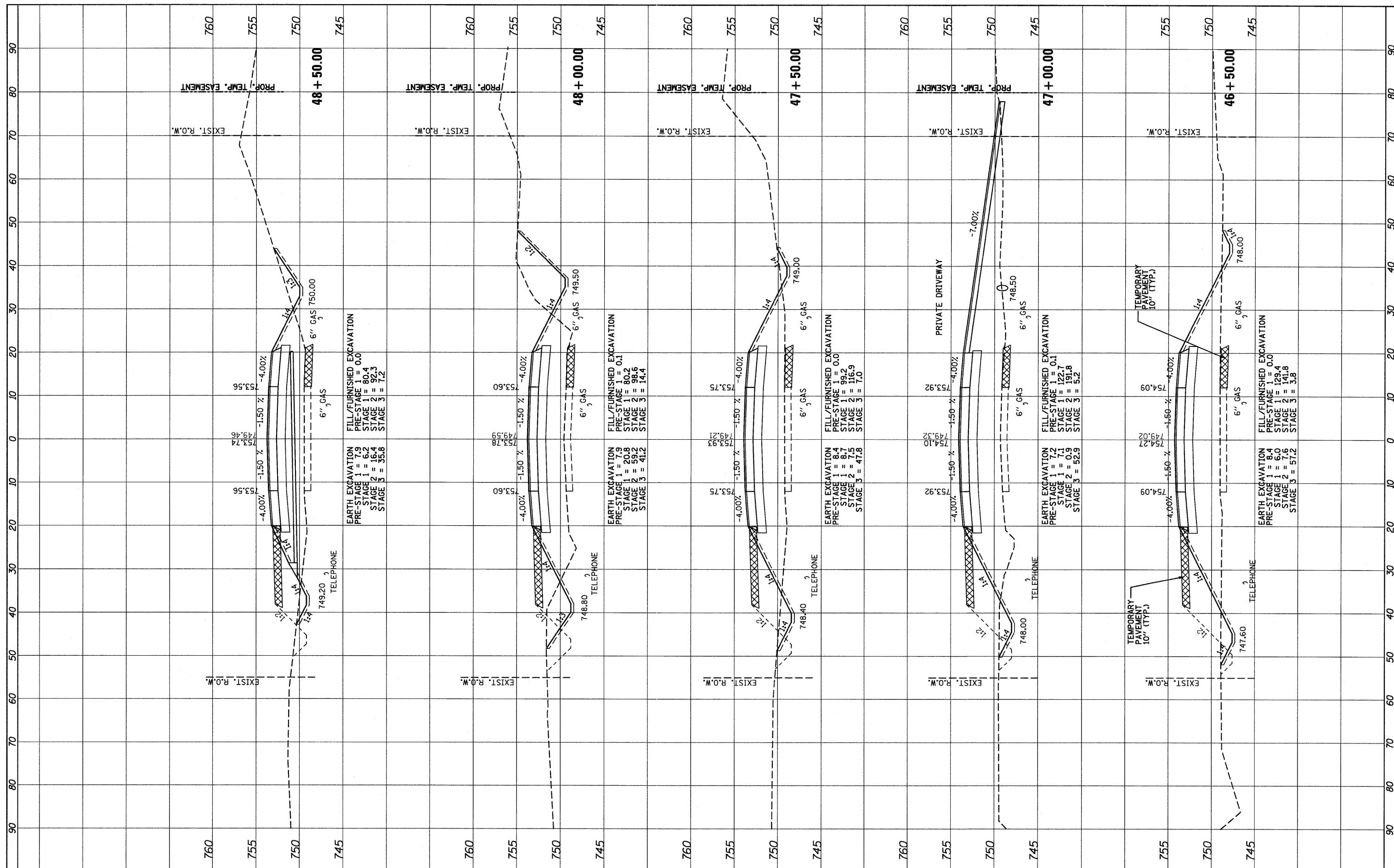

FILE NAME =
 ...\\D162187-ahf-xssht.dgn

Primera
DESIGNED - ADW
DRAWN - GEW
CHECKED - RJD
DATE - 9/14/2011

REVISED -
REVISED -
REVISED -
REVISED -

**STATE OF ILLINOIS
 DEPARTMENT OF TRANSPORTATION**

**IL ROUTE 176 (SLOCUM LAKE ROAD) OVER BANGS LAKE DRAINAGE DITCH
 CROSS SECTIONS**

SCALE: 1"=10' (HORIZ.)
 1"=8' (VERT.)

SHEET NO. 7 OF 16 SHEETS STA. 46+50.00 TO STA. 48+50.00

F.A.P. RTE. 335	SECTION 145 X-T	COUNTY LAKE	TOTAL SHEETS 80	SHEET NO. 71
CONTRACT NO. 62187			ILLINOIS FED. AID PROJECT	