

FINAL SURVEY	SURVEYED	BY	DATE
NOTE BOOK	PLOTTED		
AREAS CHECKED	TEMPLATE		
NO.	AREAS CHECKED		

ORIGINAL SURVEY	SURVEYED	BY	DATE
NOTE BOOK	PLOTTED		
AREAS CHECKED	TEMPLATE		
NO.	AREAS CHECKED		

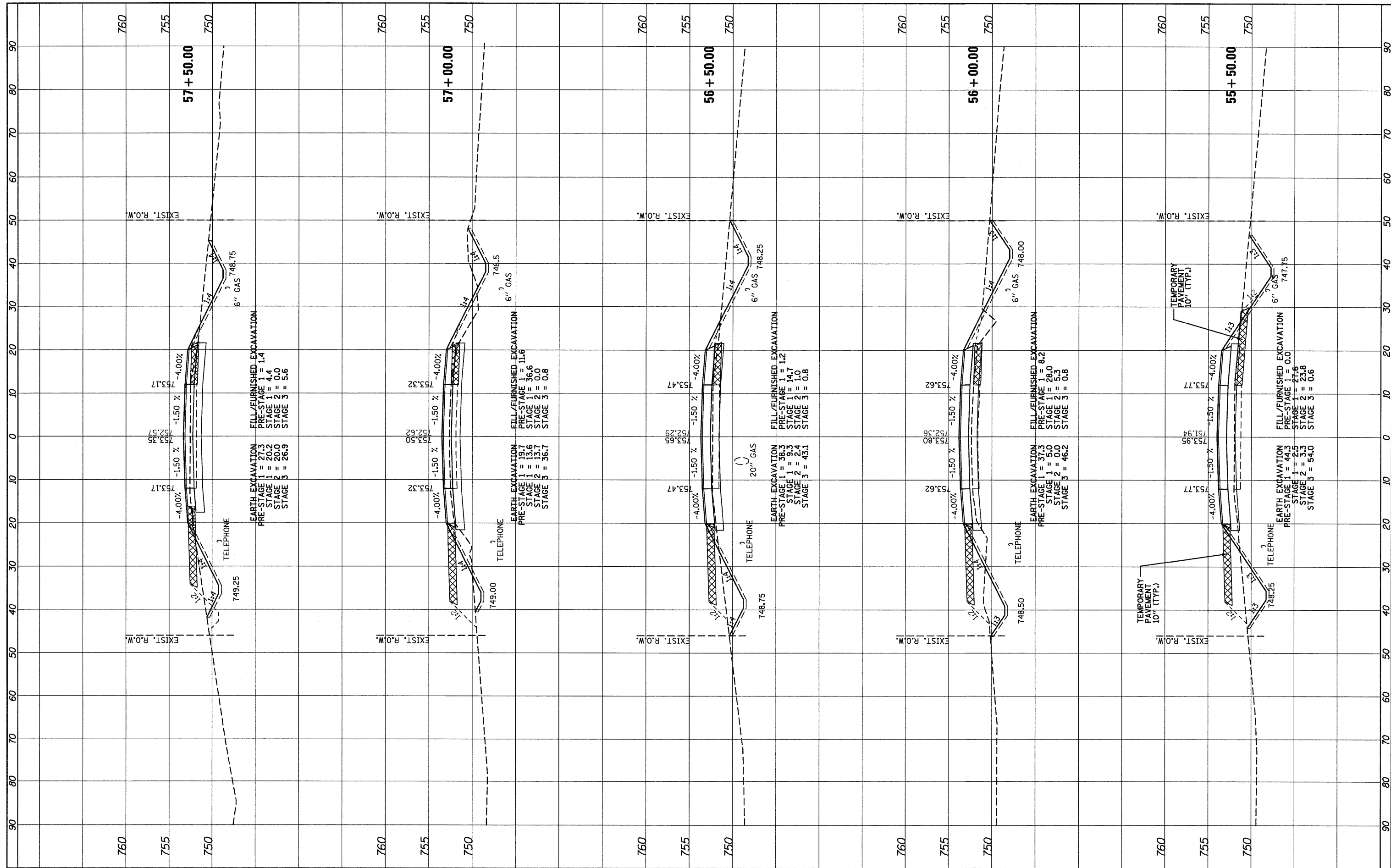

FILE NAME =
...\\D162187-sht-xssht.dgn



DESIGNED - ADW	REVISED -
DRAWN - GEW	REVISED -
CHECKED - RJD	REVISED -
DATE - 9/14/2011	REVISED -

**STATE OF ILLINOIS
DEPARTMENT OF TRANSPORTATION**

**IL ROUTE 176 (SLOCUM LAKE ROAD) OVER BANGS LAKE DRAINAGE DITCH
CROSS SECTIONS**

SCALE: 1"=30' (HORIZ.)
1"=3' (VERT.)

SHEET NO. 11 OF 16 SHEETS

STA. 55+50.00 TO STA. 57+50.00

F.A.P. RTE. 335	SECTION 145 X-T	COUNTY LAKE	TOTAL SHEETS 80	SHEET NO. 75
CONTRACT NO. 62187			ILLINOIS FED. AID PROJECT	