

FINAL SURVEY	BY	DATE
PLOTTED		
NOTE BOOK		
AREAS CHECKED		

ORIGINAL SURVEY	BY	DATE
PLOTTED		
NOTE BOOK		
AREAS CHECKED		

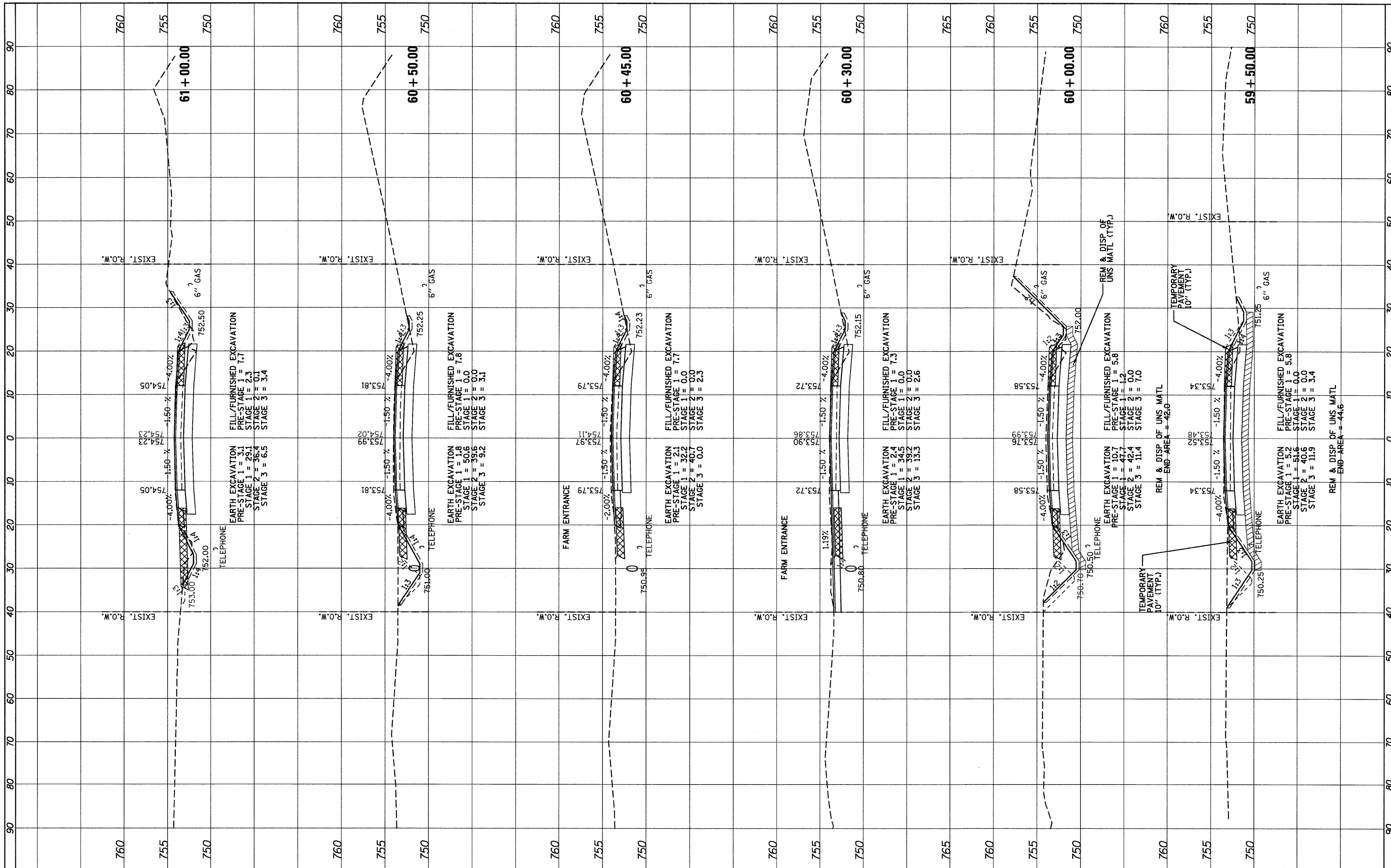

FILE NAME = ...\\D162187-sh1-xsh1.dgn



DESIGNED	- ADW	REVISED	-
DRAWN	- GEW	REVISED	-
CHECKED	- RJD	REVISED	-
DATE	- 9/14/2011	REVISED	-

STATE OF ILLINOIS
DEPARTMENT OF TRANSPORTATION

IL ROUTE 176 (SLOCUM LAKE ROAD) OVER BANGS LAKE DRAINAGE DITCH
CROSS SECTIONS

SCALE: 1"=10' (HORIZ.) 1"=5' (VERT.) SHEET NO. 13 OF 16 SHEETS STA. 59+50.00 TO STA. 61+00.00

F.A.P. RTE.	SECTION	COUNTY	TOTAL SHEETS	SHEET NO.
335	145 X-T	LAKE	80	77
CONTRACT NO. 62187			ILLINOIS FED. AID PROJECT	