

STATE OF ILLINOIS
DEPARTMENT OF TRANSPORTATION

DIVISION OF HIGHWAYS

**PROPOSED
HIGHWAY PLANS**

F.A.U. 1566 (95th ST.)
AT 104th AVE./FLAVIN RD.
INTERSECTION RECONSTRUCTION AND
TRAFFIC SIGNAL INSTALLATION
SECTION: 29 R-N-1
PROJECT: CMM-1566(004)
COOK COUNTY
C-91-026-02

F.A.U. RTE. 1566	SECTION 29 R-N-1	COUNTY COOK	TOTAL SHEETS 120	SHEET NO. 1
		ILLINOIS	CONTRACT NO. 62377	

FOR INDEX OF SHEETS, SEE SHEET NO. 2

**PROJECT LOCATED IN
PALOS TOWNSHIP**

TRAFFIC DATA:

95th St.
SPEED LIMIT - 40 MPH
2000 ADT - 11000
2020 ADT - 14000

104th AVE.
SPEED LIMIT - 40 MPH
2000 ADT - 8500
2020 ADT - 11000

FLAVIN RD.
SPEED LIMIT - 50 MPH
2000 ADT - 8500
2020 ADT - 11000

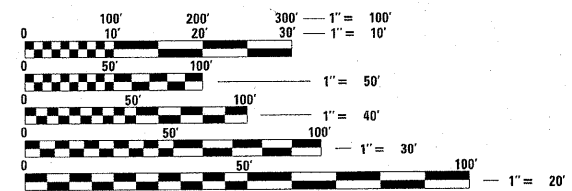

FULL SIZE PLANS HAVE BEEN PREPARED USING STANDARD ENGINEERING SCALES. REDUCED SIZED PLANS WILL NOT CONFORM TO STANDARD SCALES. IN MAKING MEASUREMENTS ON REDUCED PLANS, THE ABOVE SCALES MAY BE USED.

J.U.L.I.E.
JOINT UTILITY LOCATION INFORMATION FOR EXCAVATION
1-800-892-0123
OR 811

PROJECT ENGINEER: JENPAI CHANG (847) 705-4432
PROJECT MANAGER: KEN ENG (847) 705-4247

CONTRACT NO. 62377

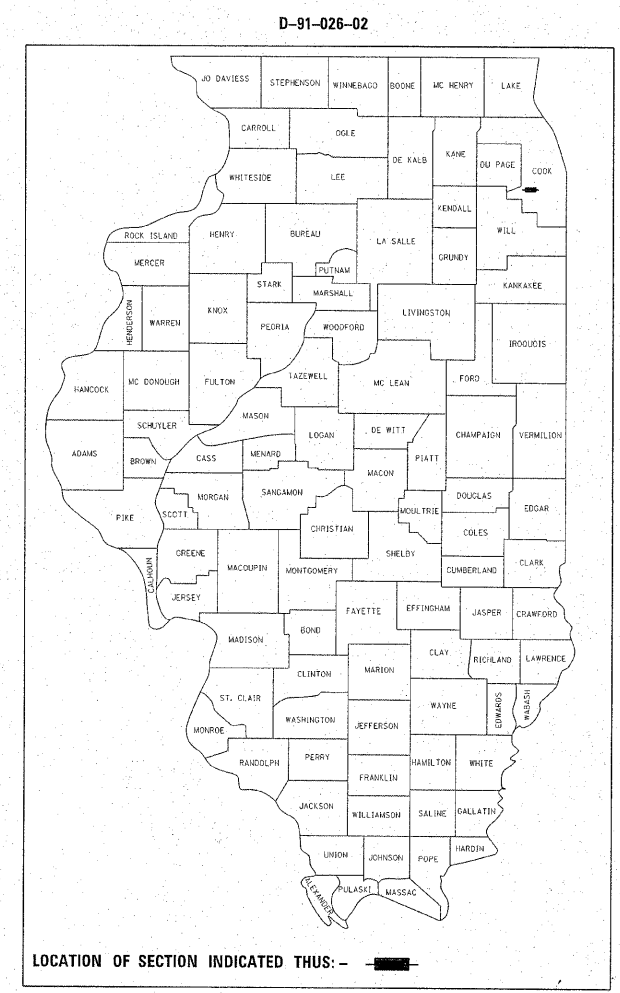
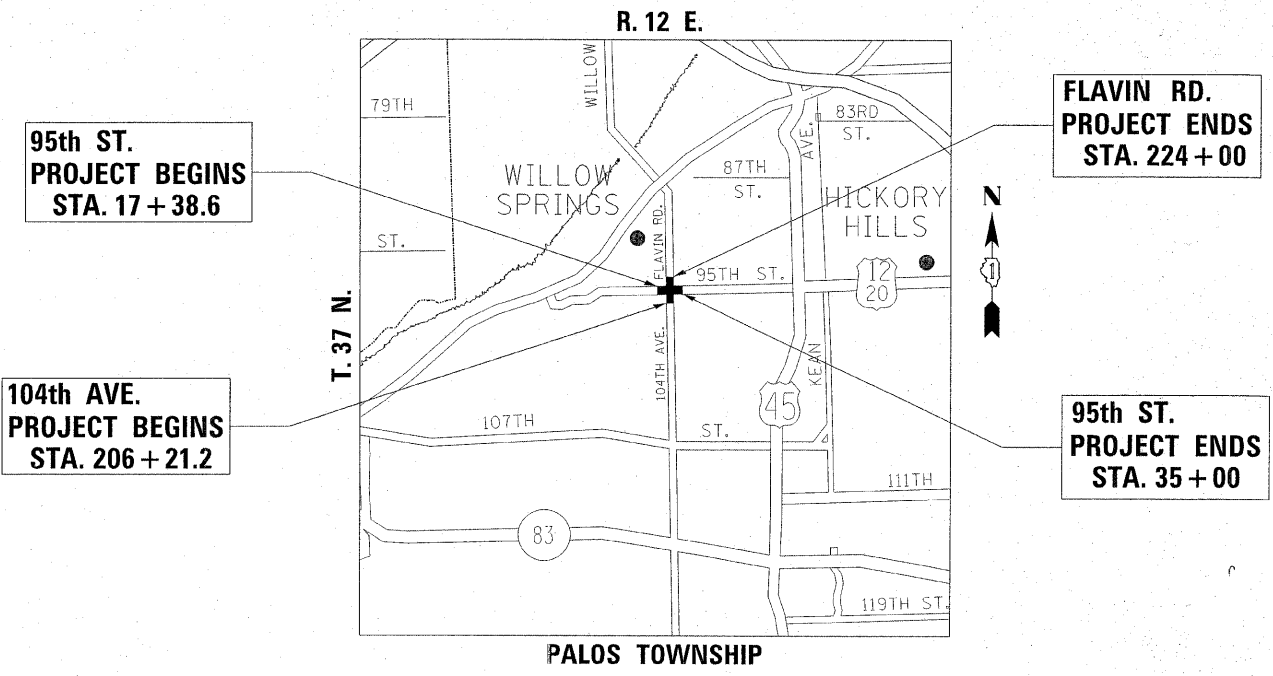

LOCATION OF SECTION INDICATED THIS: - [black rectangle] -

STATE OF ILLINOIS
DEPARTMENT OF TRANSPORTATION
DIVISION OF HIGHWAYS

SUBMITTED August 25, 2011
Diane M. O'Keefe
DEPUTY DIRECTOR OF HIGHWAYS, REGION ENGINEER

February 3, 2012
John D. Baranelli, P.E.
ENGINEER OF DESIGN AND ENVIRONMENT

February 3, 2012
William R. Frey, Jr.
DIRECTOR OF HIGHWAYS, CHIEF ENGINEER

**PRINTED BY THE AUTHORITY
OF THE STATE OF ILLINOIS**

95th ST.: GROSS AND NET LENGTH OF PROJECT - 1762 LIN FT - .33 MI
104th AVE./FLAVIN RD.: GROSS AND NET LENGTH OF PROJECT - 1779 LIN FT - .34 MI