

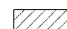

LEGEND

-  PAVEMENT REMOVAL
-  TEMPORARY PAVEMENT*
-  TRAFFIC LANE

- ① TEMPORARY PAVEMENT MARKING DOUBLE YELLOW CENTERLINE, 4"
- ② TEMPORARY PAVEMENT MARKING EDGE LINE, 4" WHITE
- ③ TEMPORARY CONCRETE BARRIER
- ④ VERTICAL PANELS OR DRUMS WITH STEADY BURNING LIGHT
- ⑤ EXISTING PAVEMENT
- ⑥ PROPOSED POLYMERIZED HOT-MIX ASPHALT SURFACE COURSE, STONE MATRIX ASPHALT, N80, 2"
- ⑦ PROPOSED POLYMERIZED HOT-MIX ASPHALT BINDER COURSE, STONE MATRIX ASPHALT, N80, 2"
- ⑧ PROPOSED POLYMERIZED HOT-MIX ASPHALT BINDER COURSE, IL-19, N90, 5/4"
- ⑨ PROPOSED AGGREGATE SUBGRADE, 12"
- ⑩ PROPOSED RETAINING WALL
- ⑪ PROPOSED HOT-MIX ASPHALT SHOULDER, 4'
- ⑫ PROPOSED HOT-MIX ASPHALT SHOULDER, 6'
- ⑬ PROPOSED HOT-MIX ASPHALT SHOULDER, 8'
- ⑭ PROPOSED STEEL PLATE BEAM GUARDRAIL
- ⑮ PROPOSED GRADING AND SHAPING DITCHES

STAGE I

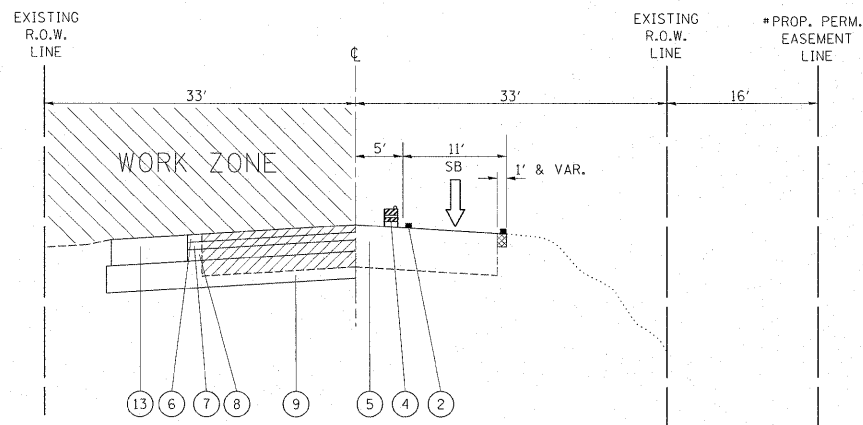

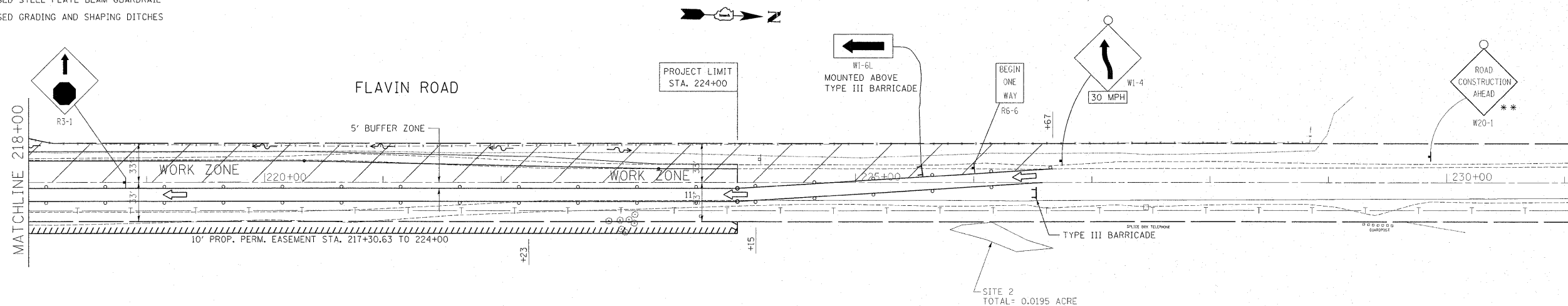

STAGE I TYPICAL SECTION (FLAVIN RD.)
STA. 215+64.3 TO STA. 226+67

NOTE:
PERMANENT EASEMENT
STA. 217+31 TO STA. 224+00
* TEMPORARY PAVEMENT
STA. 222+23 TO STA. 224+15



NOTES:

- * STRAIGHT TAPER MAY BE USED IN PLACE OF REVERSE CURVE
- ** a)  SIGN SHALL BE PLACED 500' FROM REVERSE CURVE (OR STRAIGHT TAPER)
- b) THERE SHALL BE 500' SPACING BETWEEN  AND  SIGNS

| | | | |
|---|---------------------|------------|-----------|
| FILE NAME = | USER NAME = steedpa | DESIGNED - | REVISED - |
| c:\pw_work\p1dot\stedpa\c0159915\p144499-Design.dgn | | DRAWN - | REVISED - |
| PLOT SCALE = 50.0000' / 1in. | | CHECKED - | REVISED - |
| PLOT DATE = 12/6/2011 | | DATE - | REVISED - |

STATE OF ILLINOIS
DEPARTMENT OF TRANSPORTATION

SUGGESTED STAGING AND TRAFFIC CONTROL PLAN - STAGE I
95th STREET @ 104th AVENUE / FLAVIN ROAD

SCALE: SHEET NO. OF SHEETS STA. TO STA.

| | | | | |
|---------------------------|----------|--------|--------------|-----------|
| F.A.U. RTE. | SECTION | COUNTY | TOTAL SHEETS | SHEET NO. |
| 1566 | 29 R-N-1 | COOK | 120 | 25 |
| CONTRACT NO. 62377 | | | | |
| ILLINOIS FED. AID PROJECT | | | | |