

F.A.U. RTE.	SECTION	COUNTY	TOTAL SHEETS	SHEET NO.
1566	29 R-N-1	COOK	120	51
STA.	TO STA.			
FED. ROAD DIST. NO.	ILLINOIS	FED. AID PROJECT		
D-91-026-02	CONTRACT NO. 62377			

SHEET 51 OF 56

SCOPE OF WORK:
 PERMANENT STEEL SHEET PILING RETAINING WALL
 INSTALL GUARDRAIL

DESIGN SPECIFICATIONS:
 2002 AASHTO

LOADING:
 EQUIVALENT FLUID LATERAL SOIL PRESSURE = 85 lbs/ft²

DESIGN STRESSES:
 f_c = 3500 psi
 f_y = 60,000 psi

GENERAL NOTES:
 PLAN DIMENSIONS AND DETAILS RELATIVE TO EXISTING PLANS ARE SUBJECT TO NOMINAL CONSTRUCTION VARIATIONS. THE CONTRACTOR SHALL FIELD VERIFY EXISTING DIMENSIONS AND DETAILS AFFECTIVE NEW CONSTRUCTION AND MAKE NECESSARY APPROVED ADJUSTMENTS PRIOR TO CONSTRUCTION OR ORDERING OF MATERIALS. SUCH VARIATIONS SHALL NOT BE CAUSE FOR ADDITIONAL COMPENSATION FOR A CHANGE IN SCOPE OF THE WORK, HOWEVER, THE CONTRACTOR WILL BE PAID FOR THE QUANTITY ACTUALLY FURNISHED BASED AT THE UNIT PRICE BID FOR THE WORK.
 ELEVATIONS ARE IN FEET.
 EXPOSED CONCRETE EDGES SHALL BE CHAMFERED 3/4" EXCEPT AS NOTED.
 REINFORCEMENT BARS SHALL CONFORM TO THE REQUIREMENTS OF ASTM A 706 Gr 60 SEE SPECIAL PROVISIONS.
 EFFECTIVE SECTION MODULUS - 22 in³/ft. min.

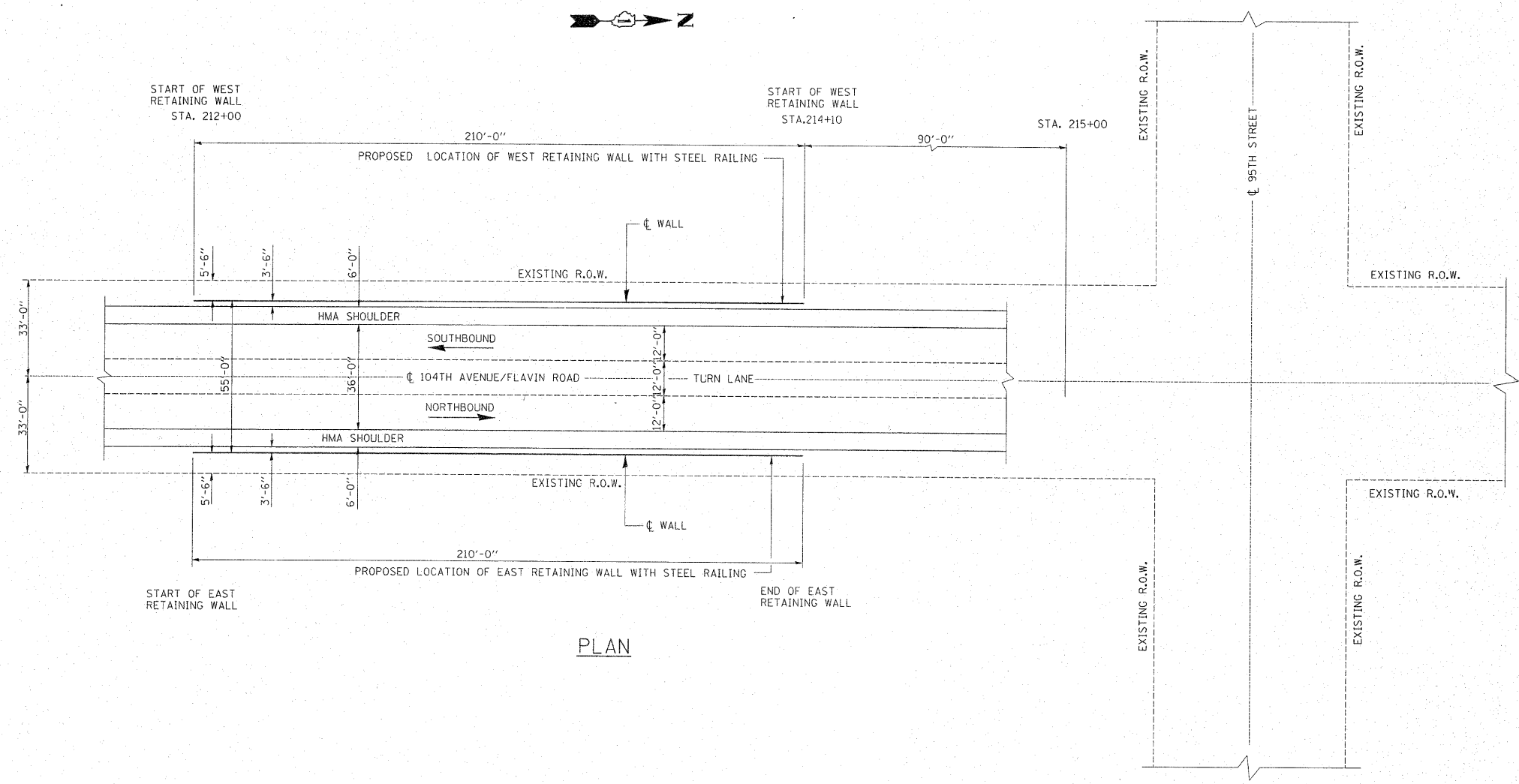

PLAN

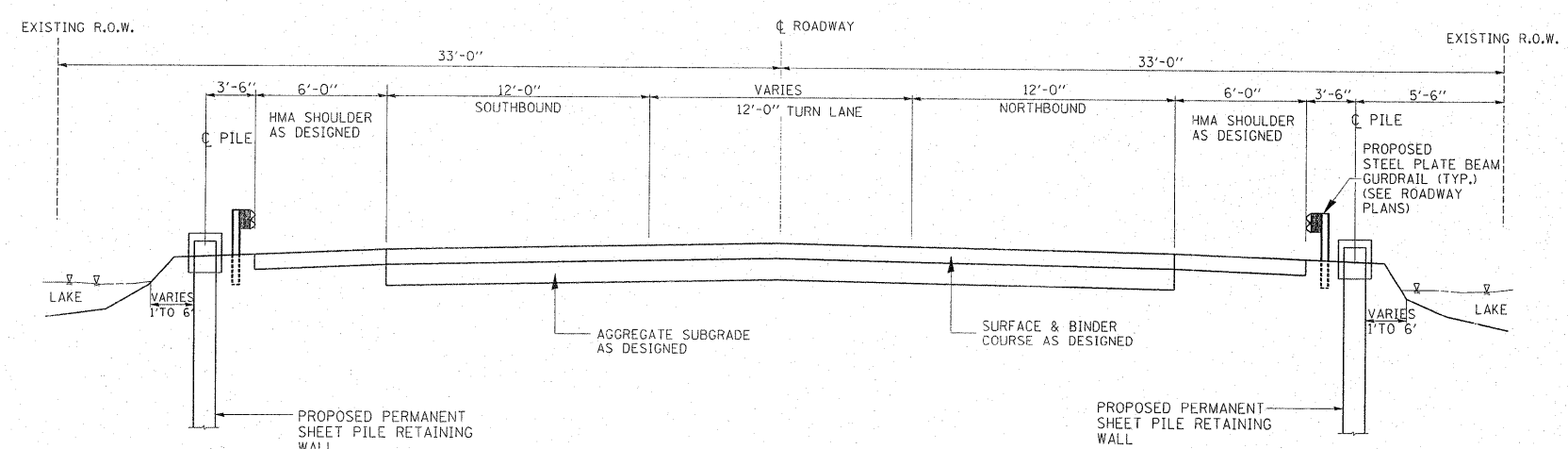

TYPICAL SECTION
(LOOKING NORTH)

TOTAL BILL OF MATERIALS

ITEM	UNIT	QUANTITY
REINFORCEMENT BARS, (EPOXY COATED)	POUND	3600
CONCRETE STRUCTURES	CU. YDS	40.8
PERMANENT STEEL SHEET PILING	SQ. FT.	7460
STUD SHEAR CONNECTORS	EACH	118

REVISIONS		ILLINOIS DEPARTMENT OF TRANSPORTATION 95TH STREET AT 104TH AVENUE/FLAVIN ROAD WEST AND EAST PROPOSED RETAINING WALLS
NAME	DATE	

SCALE: VERT. DRAWN BY: MVT
 HORIZ. CHECKED BY: RTB

2/15/2011 c:\pwworking\steedpa\101671\retainingwalls.dgn