

Removal and Disposal of Unsuitable Material and replacement with Controlled - Low Strength Material and 6" Porous Granular Embankment.

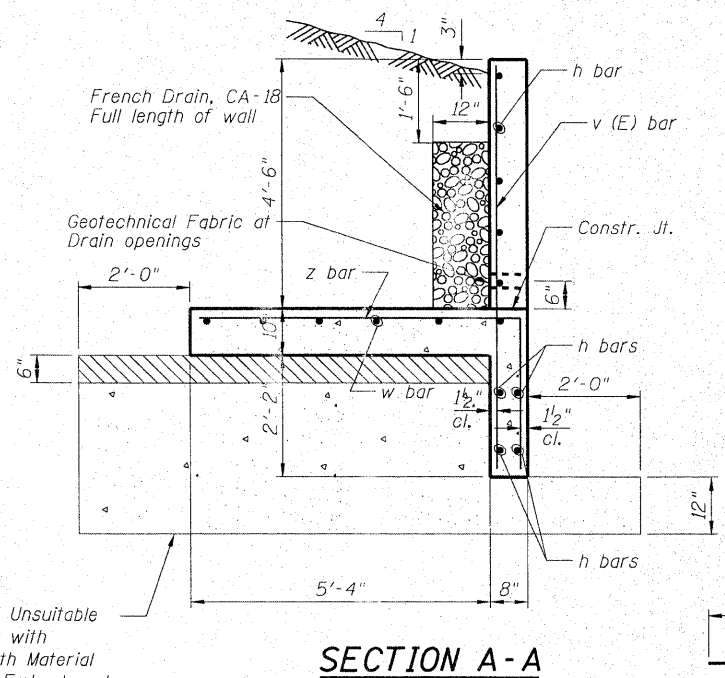

DESIGN SPECIFICATIONS

2002 AASHTO Standard Specification for Highway Bridges, 17th edition.

DESIGN STRESSES

$f_y = 60,000 \text{ psi}$
 $f'_c = 3,500 \text{ psi}$
 Allowable Net Soil Bearing Pressure = 1,500 psf Minimum

GENERAL NOTES

Reinforcement bars shall conform to requirements of ASTM A706, Gr 60. See Special Provisions.

Place reinforcing bars to provide 2 inches clear concrete cover except where shown on drawings.

Reinforcement bars designated (E) shall be epoxy coated.

All construction joints shall be bonded.

Provide 1" chamfer on all exposed edges, except where shown on drawings.

Place geotechnical fabric where shown (to be included in the work for FRENCH DRAIN, CA-18).

The limits and quantities of removal and replacement shown are based on the boring data and may be modified by the District Geotechnical and Field Engineers for variable subsurface conditions encountered in the field.

Additional undercutting beyond that shown on drawings is not anticipated, but if required to achieve the minimum allowable net soil bearing pressure, it will be paid for as REMOVAL AND DISPOSAL OF UNSUITABLE MATERIAL. Replacement material shall be paid for as CONTROLLED LOW STRENGTH MATERIAL (CLSM).

Mix design for CLSM shall be in accordance with Section 1019.05, "MIX 3".

Design scour elevation at downstream end is 690.89'.

BILL OF MATERIAL

Bar	No.	Size	Length	Shape
a	6	#5	5'-4"	—
h	9	#4	9'-8"	—
v(E)	12	#5	7'-2"	—
w	8	#5	9'-8"	—
z	10	#5	8'-4"	└
Removal and Disposal of Unsuitable Material			Cu. Yds.	5
Porous Granular Embankment			Cu. Yds.	1
Removal of Existing Structure			Eq.	1
Concrete Structures			Cu. Yds.	3.5
Reinforcement Bars			Pound	290
Reinforcement Bars, Epoxy Coated			Pound	100
Controlled Low Strength Material			Cu. Yds.	2.0
French Drain, CA-18			Cu. Yds.	1.0

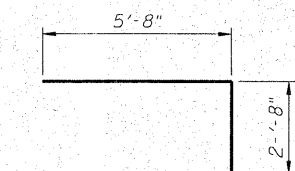

SHEET 1 OF 2