

F.A.P. RTE.	SECTION	COUNTY	TOTAL SHEETS	SHEET NO.
856	01-00170-26-TL	WILL	171	21
STA. 63+00		TO STA. 69+00		
FED. ROAD DIST. NO.		ILLINOIS FED. AID PROJECT		
CONTRACT NO: 63570				

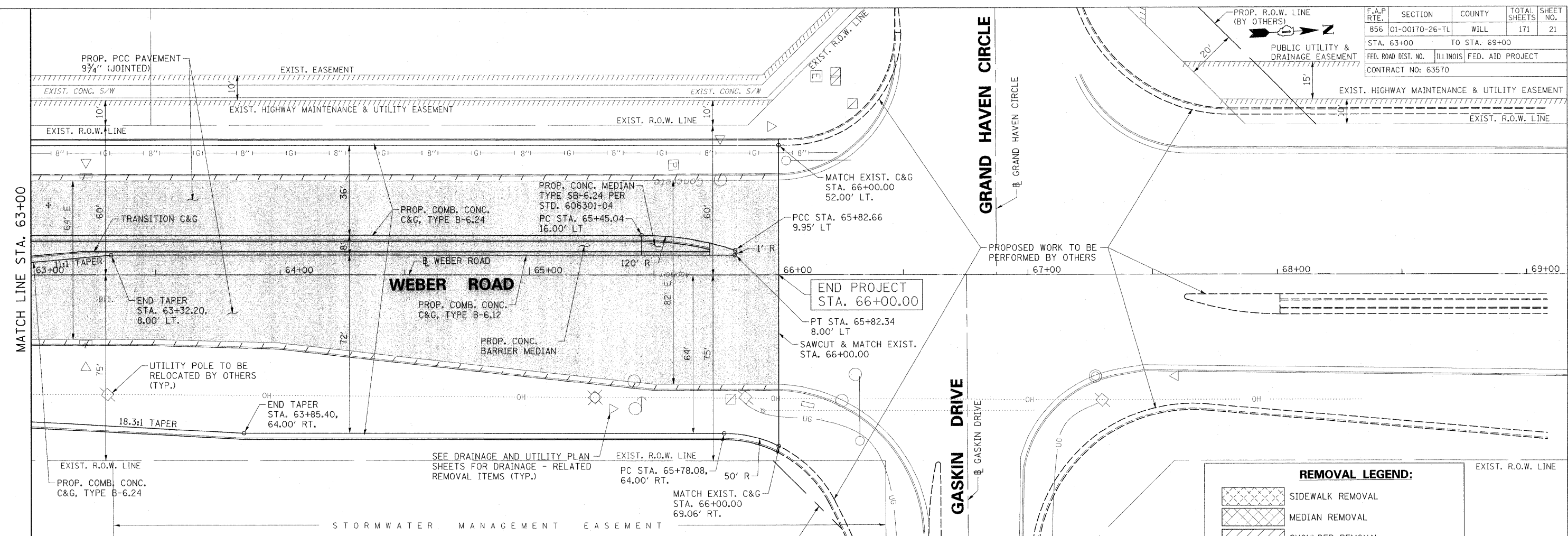

REMOVAL LEGEND:

	SIDEWALK REMOVAL
	MEDIAN REMOVAL
	SHOULDER REMOVAL
	DRIVEWAY PAVEMENT REMOVAL
	BITUMINOUS SURFACE REMOVAL
	PAVEMENT REMOVAL
	COMB. CONC. C&G REMOVAL
	TREE REMOVAL

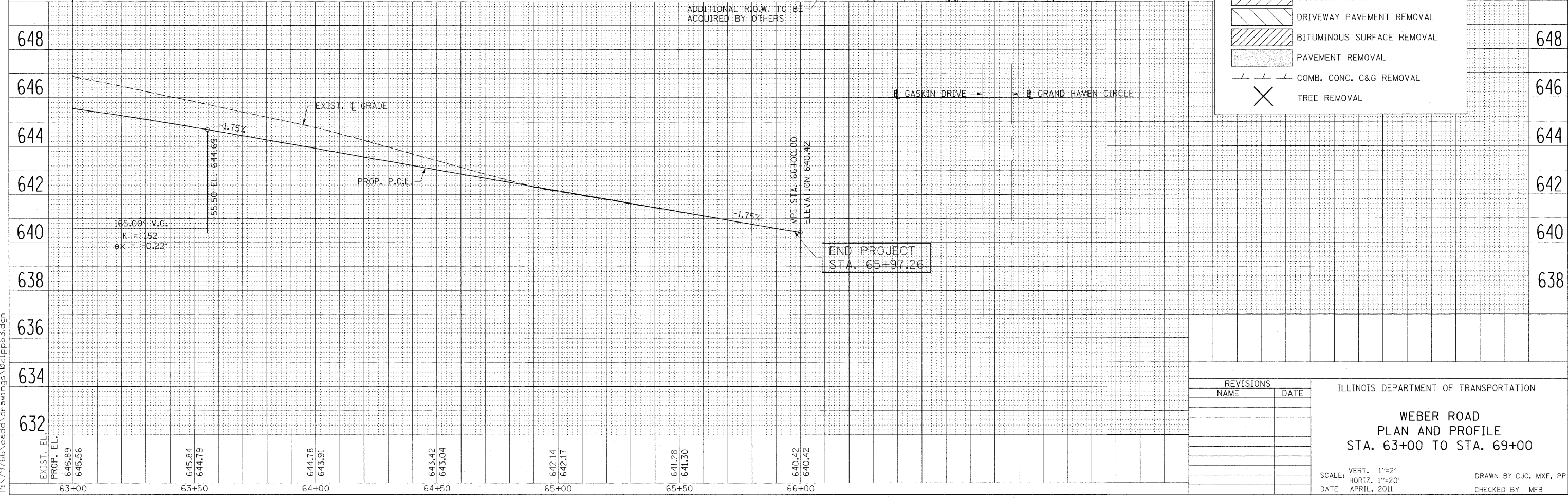

REVISIONS	
NAME	DATE

ILLINOIS DEPARTMENT OF TRANSPORTATION

WEBER ROAD
PLAN AND PROFILE
STA. 63+00 TO STA. 69+00

SCALE: VERT. 1"=2'
 HORIZ. 1"=20'

DATE: APRIL, 2011

DRAWN BY CJO, MXF, PP
 CHECKED BY MFB

8/22/2011 P:\179766\cadd\drawings\02\lpp63.dgn