

THRU LANE TO  
TURN LANE CONVERSION

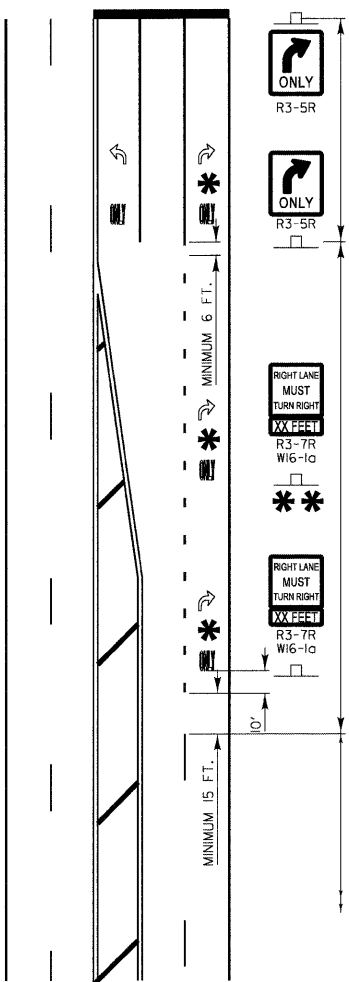

TURN BAY  
6' WHITE LINE  
(ADDITIONAL PAV'T MARKINGS AS SHOWN  
ON SHEET ONE OF THE L.C.D.O.T PAV'T  
MARKINGS DETAIL SHEETS)

TRANSITION ZONE  
6' WHITE 3'/12' SKIP DASH  
LANE LINE

THRU LANE  
4' WHITE 10'/30' SKIP DASH  
LANE LINE

TYPICAL PAVEMENT MARKINGS AND RAISED PAVEMENT MARKERS

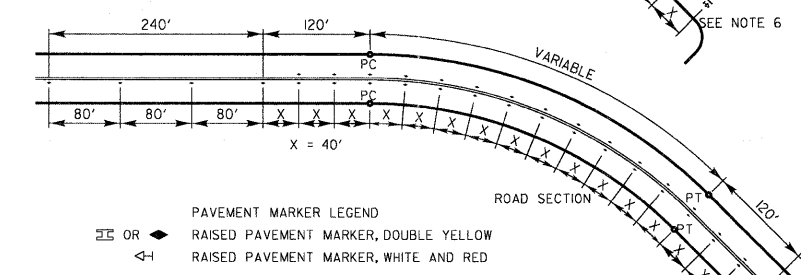
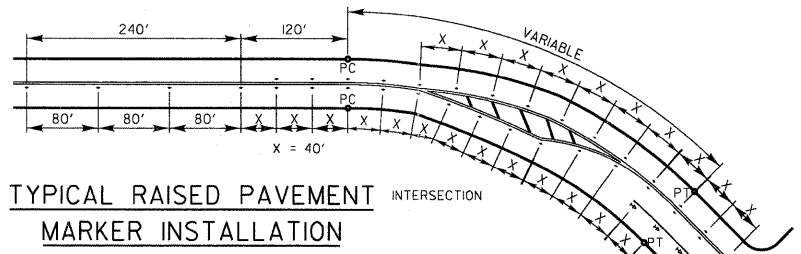

PAVEMENT MARKER LEGEND  
  
 RAISED PAVEMENT MARKER, DOUBLE YELLOW  
 RAISED PAVEMENT MARKER, WHITE AND RED

- NOTES:
- CENTERLINE RAISED PAVEMENT MARKERS (RPM'S) SHALL BE PLACED ON ALL CURVES OVER 3 1/2 DEGREES ON ALL TWO AND THREE LANE HIGHWAYS, UNLESS DIRECTED OTHERWISE BY THE ENGINEER.
  - SPACING = 40' FOR CENTERLINE MARKERS.
  - ALL RPM'S ON CENTERLINE ARE 2-WAY YELLOW. LANE LINE MARKERS ARE WHITE/RED.
  - MARKERS SHALL BE INSTALLED IN ACCORDANCE WITH F.H.W.A. MEMORANDUM HO-21.
  - MARKERS SHALL BE FIELD ADJUSTED TO BE LOCATED IN CENTER OF THE 30' GAP OF A 30'/10' SKIP/DASH CENTERLINE.
  - RPM'S WHICH ARE TO BE LOCATED WITHIN THE INTERSECTION OF A CROSS STREET, SHALL NOT BE INSTALLED.
  - A MINIMUM OF 4 WHITE/RED MARKERS SHALL BE INSTALLED ALONG THE TURN LANE LINE.
  - RPM'S INSTALLED ON MULTI-LANE ROAD SECTIONS SHALL BE INSTALLED ON THE WHITE SKIP-DASH LANE LINE ONLY. THESE RPM'S SHALL BE INSTALLED IN PAIRS AND SHALL BE 80' CENTER TO CENTER. SPACING WITHIN EACH PAIR SHALL BE 10', CENTERED WITHIN THE 30' SKIP.

MINIMUM TRANSITION ZONE LENGTH

POSTED SPEED	LENGTH
25 M.P.H.	255 FT.
30 M.P.H.	330 FT.
35 M.P.H.	405 FT.
40 M.P.H.	480 FT.
45 M.P.H.	555 FT.
50 M.P.H.	630 FT.
55 M.P.H.	705 FT.

\* LOCATION OF PAV'T MARKINGS

(MEASURED FROM BEGINNING OF TRANSITION ZONE)

POSTED SPEED	LOCATION OF PAV'T MARKINGS
25 M.P.H.	10 FT., 260 FT.
30 M.P.H.	10 FT., 170 FT., 340 FT.
35 M.P.H.	10 FT., 210 FT., 410 FT.
40 M.P.H.	10 FT., 170 FT., 330 FT., 490 FT.
45 M.P.H.	10 FT., 190 FT., 370 FT., 560 FT.
50 M.P.H.	10 FT., 170 FT., 330 FT., 490 FT., 640 FT.
55 M.P.H.	10 FT., 180 FT., 350 FT., 520 FT., 710 FT.

FOR POSTED SPEEDS 40 M.P.H. OR GREATER A SECOND R3-7/W16-1a SIGN INSTALLATION SHALL BE LOCATED HALFWAY BETWEEN THE BEGINNING OF THE TRANSITION ZONE AND THE BEGINNING OF THE TURN LANE

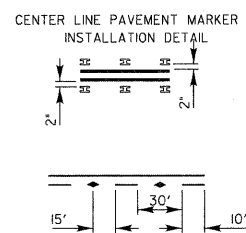
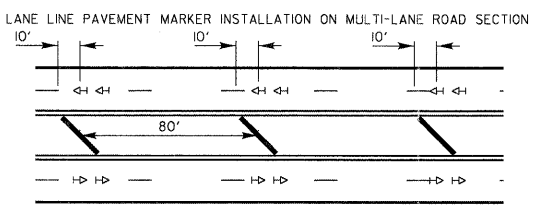

CROSSWALKS

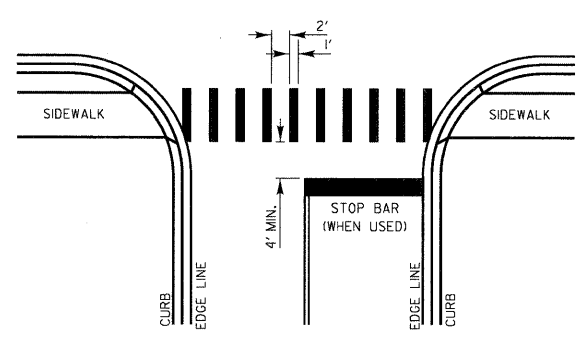

- WIDTH OF THE CROSSWALK IS GENERALLY 6' EXCEPT AT SCHOOL CROSSINGS AND BICYCLE CROSSINGS, WHICH CAN BE 8'.
- THE STOP BAR SHOULD BE INSTALLED A MINIMUM OF 4' IN ADVANCE OF THE CROSSWALK.

CURB MARKING

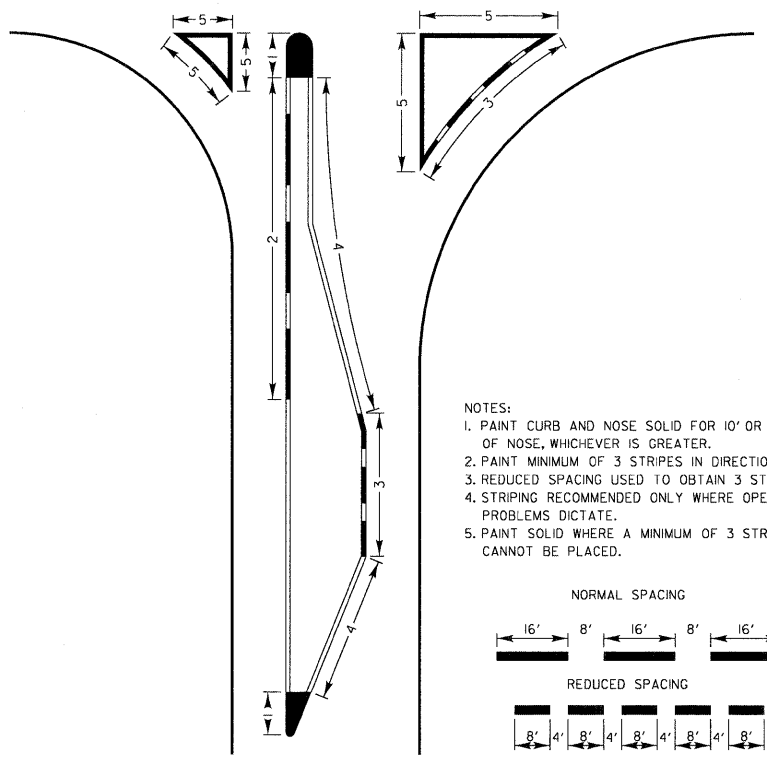

- NOTES:
- PAINT CURB AND NOSE SOLID FOR 10' OR RADIUS OF NOSE, WHICHEVER IS GREATER.
  - PAINT MINIMUM OF 3 STRIPES IN DIRECTION OF TRAFFIC.
  - REDUCED SPACING USED TO OBTAIN 3 STRIPE MINIMUM.
  - STRIPING RECOMMENDED ONLY WHERE OPERATIONAL PROBLEMS DICTATE.
  - PAINT SOLID WHERE A MINIMUM OF 3 STRIPES CANNOT BE PLACED.

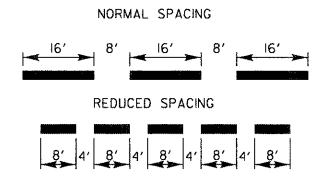

PAVEMENT CROSS SECTION SHOWING TYPICAL PAVEMENT MARKINGS (2-LANE ROADWAY)

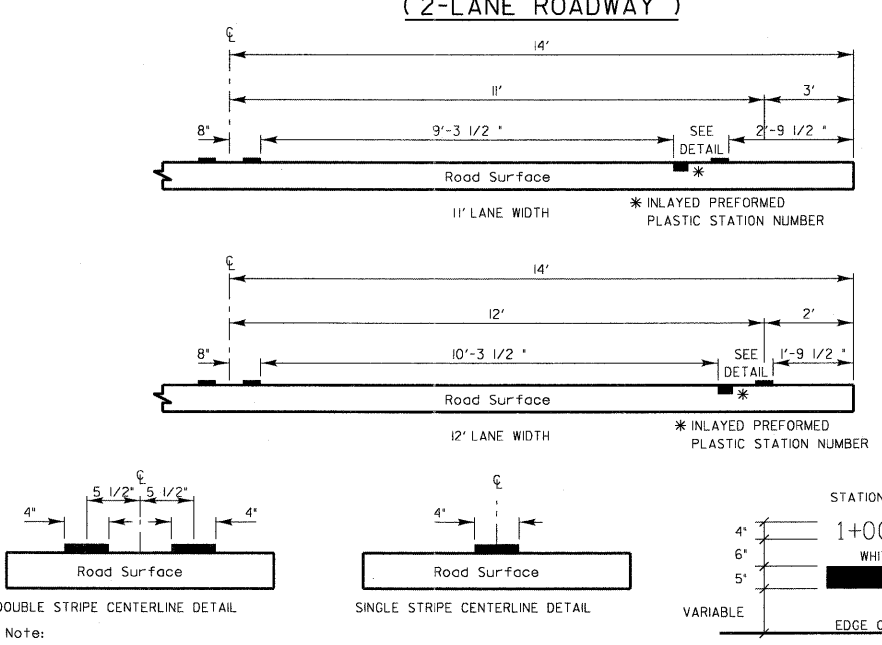

REVISIONS	DATE
Separated Railroad Sheet	06/02/08

LakeCounty  
Division of Transportation  
APPROVED BY: A. KHAWAJA  
DATE: APRIL 1, 2007

TYPICAL PAVEMENT MARKINGS  
FOR COUNTY HIGHWAYS  
SHEET 2 OF 2

LC7800