

MATCH LINE - STA. 95+50
SEE SHEET 8

ISHNALA DRIVE
MATCH LINE - STA. 9+50
SEE BELOW RIGHT

MATCH LINE - STA. 99+50
SEE SHEET 10

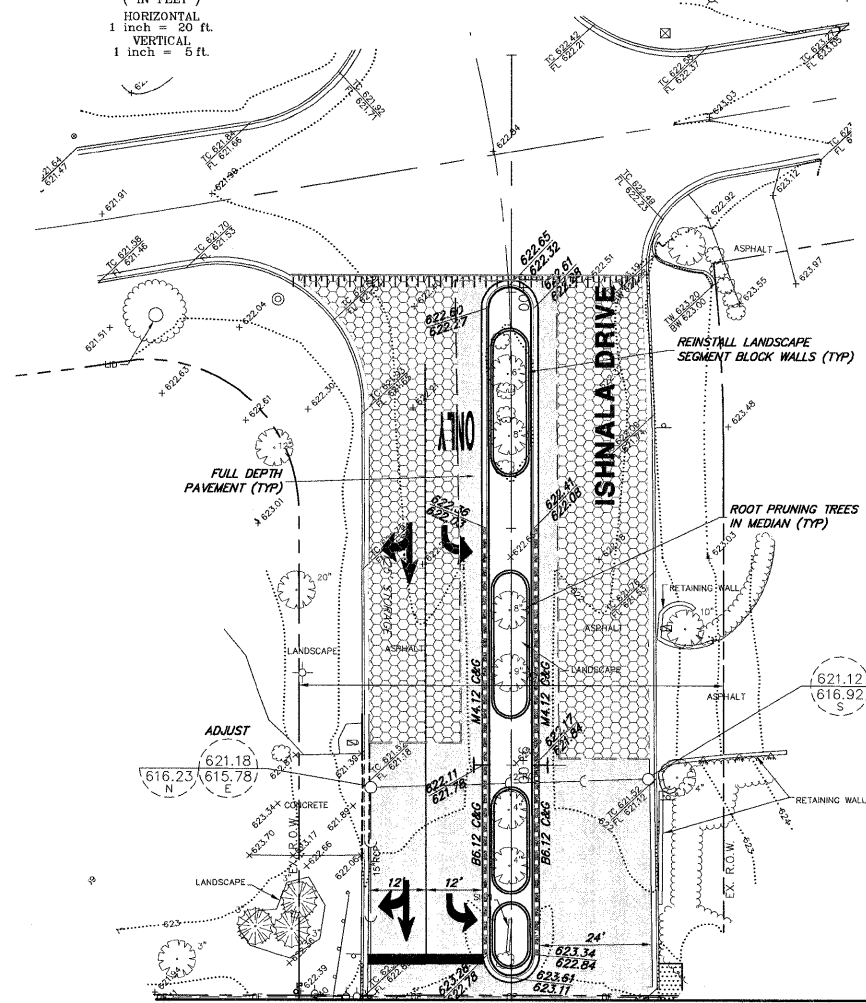
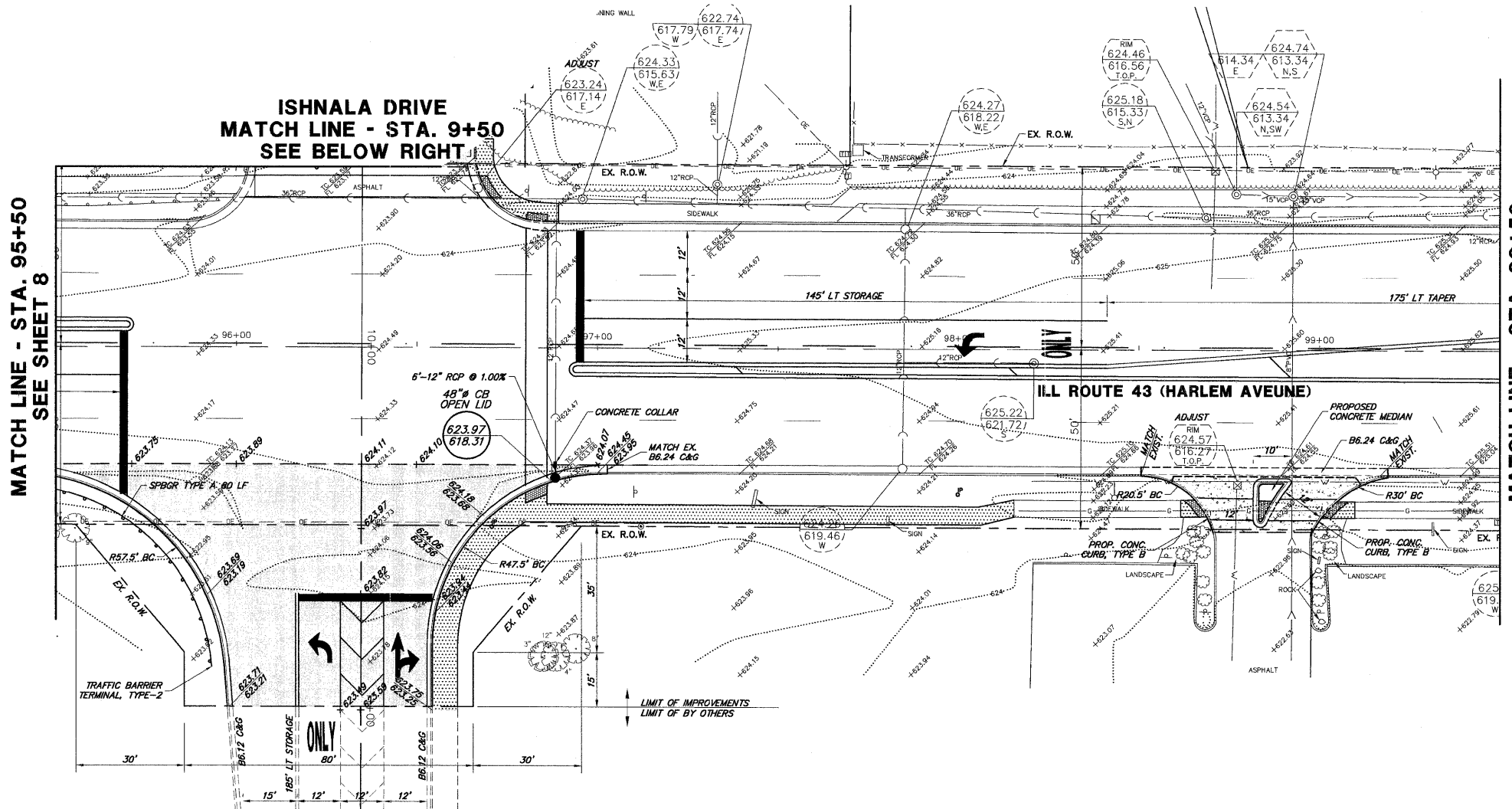
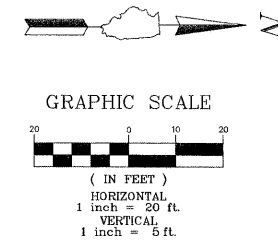

MATCH LINE - STA. 9+50
SEE ABOVE LEFT

ILL ROUTE 43 (HARLEM AVENUE)

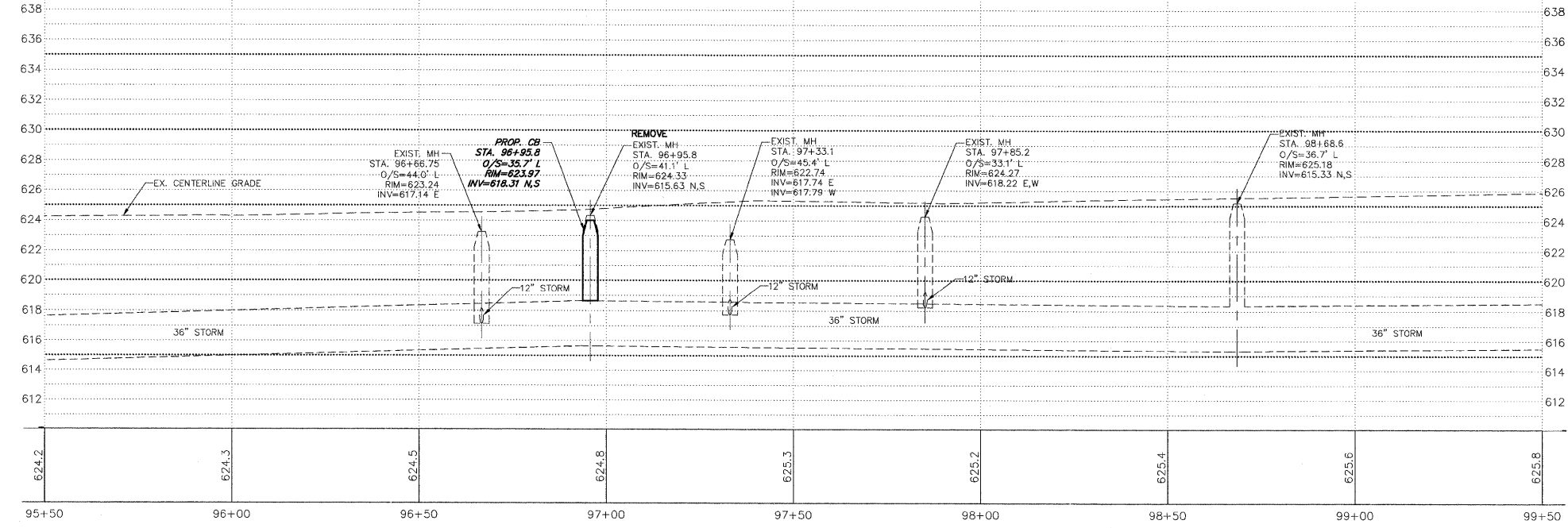

PROPOSED CONDITIONS LEGEND

- HOT-MIX ASPHALT PAVEMENT (SEE TYPICAL SECTION)
- HOT-MIX ASPHALT SURFACE COURSE, MIX 'D', N70
- PORTLAND CEMENT CONCRETE DRIVEWAY PAVEMENT, 8 INCH
- PORTLAND CEMENT CONCRETE SIDEWALK, 5 INCH
- COMBINATION CONCRETE CURB AND GUTTER
- COMBINATION CONCRETE CURB AND GUTTER (DEPRESSED)
- COMBINATION CONCRETE CURB AND GUTTER (REVERSE PITCH)
- DETECTABLE WARNINGS (SEE CURB RAMP DETAIL SHEET)

FILE NAME = 2806-240-PR6.dwg

USER NAME = GHA
PLOT SCALE = 1"=1"
PLOT DATE = 10/17/2011

DESIGNED - BVS
DRAWN - BVS
CHECKED - WCG
DATE - 11/10/2011

REVISED -
REVISED -
REVISED -
REVISED -

STATE OF ILLINOIS
DEPARTMENT OF TRANSPORTATION

PLAN AND PROFILE
ILL RTE 43 (HARLEM AVENUE) ROAD IMPROVEMENTS

FAP RTE. 348	SECTION 10-00047-00-TL	COUNTY COOK	TOTAL SHEETS 30	SHEET NO. 9
SCALE: 1"=20'			SHEET NO. OF SHEETS STA. 95+50 TO STA. 99+50	
			CONTRACT #: 63626	

GHA #2806.242

ILLINOIS FED. AID PROJECT