

DATE	
BY	
SURVEYED	
TEMPLATE	
NOTE BOOK	
AREAS CHECKED	

DATE	
BY	
SURVEYED	
TEMPLATE	
NOTE BOOK	
AREAS CHECKED	

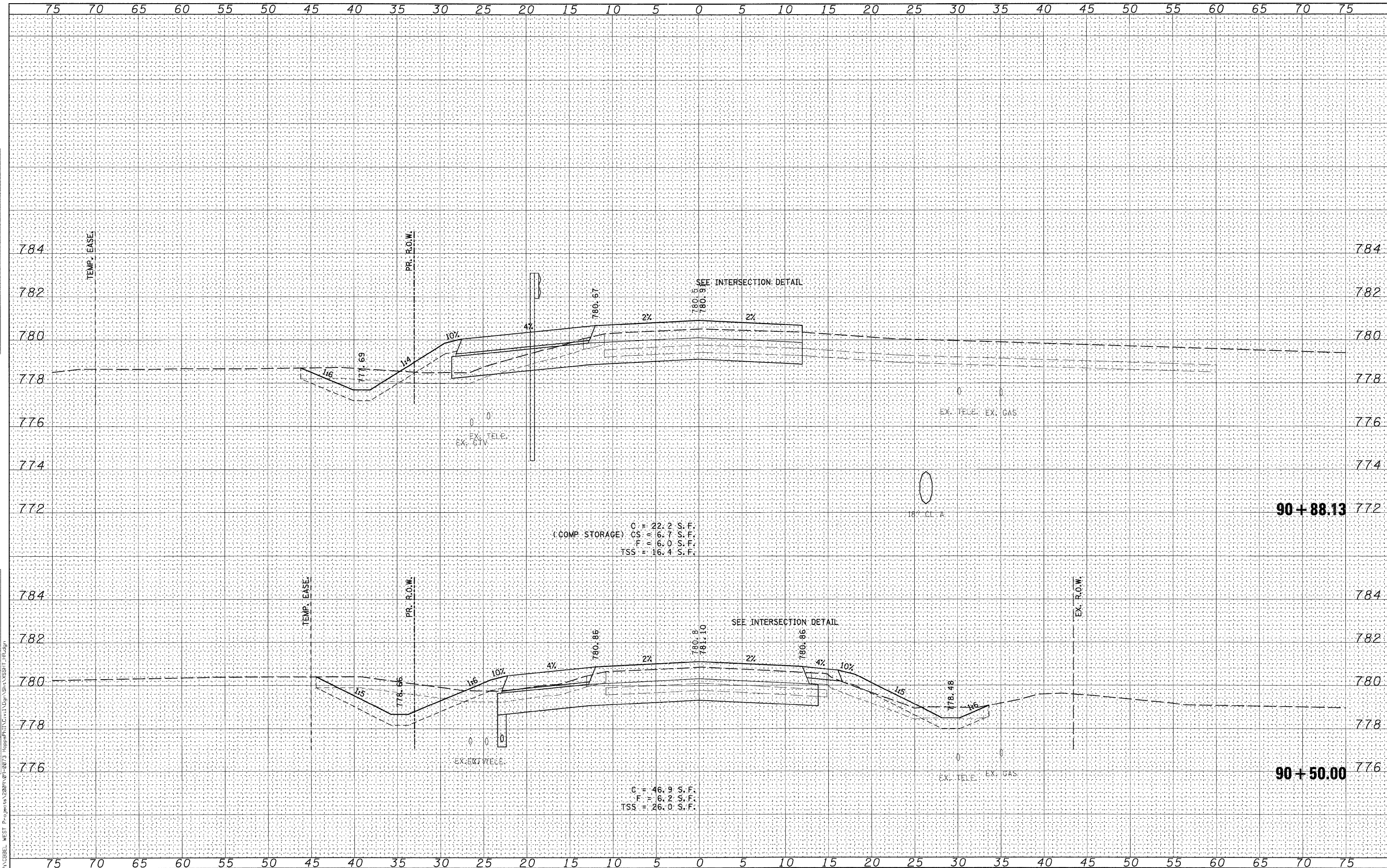

(COMP. STORAGE)
 C = 22.2 S.F.
 CS = 6.7 S.F.
 F = 6.0 S.F.
 TSS = 16.4 S.F.

C = 46.9 S.F.
 F = 6.2 S.F.
 TSS = 26.0 S.F.

WILLS BURKE KELSEY ASSOCIATES LTD.
 116 West Main Street, Suite 201
 St. Charles, Illinois 60174

USER NAME = nparris	DESIGNED - KMA	REVISED -
PLOT SCALE =	DRAWN - NDP	REVISED -
PLOT DATE = 12/16/2011	CHECKED - RPD	REVISED -
	DATE - 12/19/11	REVISED -

**STATE OF ILLINOIS
 DEPARTMENT OF TRANSPORTATION**

CROSS SECTIONS HOPPS ROAD			
SCALE:	SHEET NO.	OF 80 SHEETS	STA. 90+50.00 TO STA. 90+88.13

F.R. RTE.	SECTION	COUNTY	TOTAL SHEETS	SHEET NO.
2442	04-08107-00-BR	KANE	80	69
CONTRACT NO.63644				
FED. ROAD DIST. NO.				ILLINOIS FED. AID PROJECT

FILE NAME = P:\CIBBEL WEST Projects\2209\90+50.00\90+50.00\Shr\XSSHT_1R.dgn