

SCHEDULE OF TRAFFIC SIGNAL QUANTITIES

ITEM	UNIT	QUANTITY
DETECTOR LOOP, TYPE 1	FOOT	173

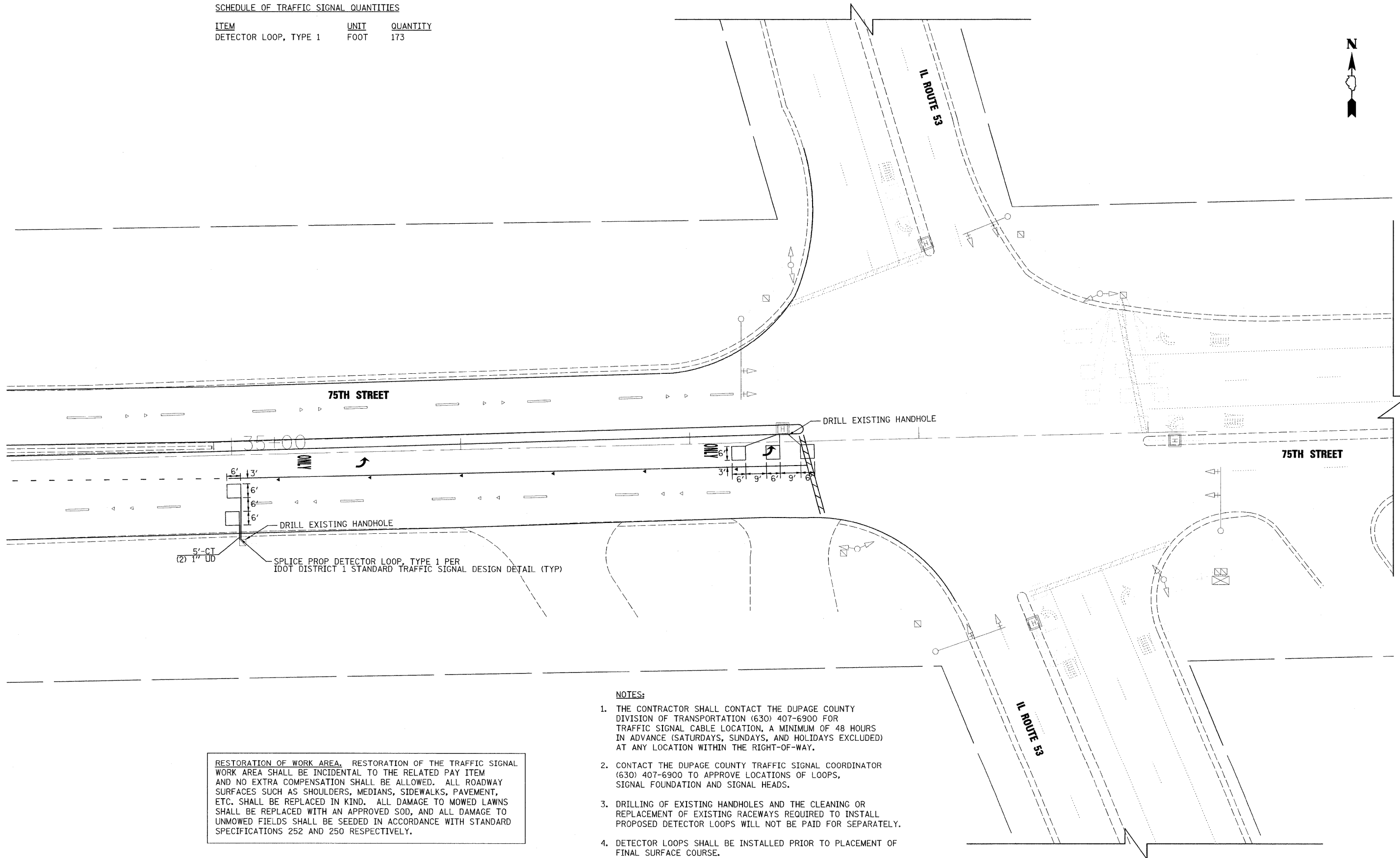

NOTES:

1. THE CONTRACTOR SHALL CONTACT THE DUPAGE COUNTY DIVISION OF TRANSPORTATION (630) 407-6900 FOR TRAFFIC SIGNAL CABLE LOCATION, A MINIMUM OF 48 HOURS IN ADVANCE (SATURDAYS, SUNDAYS, AND HOLIDAYS EXCLUDED) AT ANY LOCATION WITHIN THE RIGHT-OF-WAY.
2. CONTACT THE DUPAGE COUNTY TRAFFIC SIGNAL COORDINATOR (630) 407-6900 TO APPROVE LOCATIONS OF LOOPS, SIGNAL FOUNDATION AND SIGNAL HEADS.
3. DRILLING OF EXISTING HANDHOLES AND THE CLEANING OR REPLACEMENT OF EXISTING RACEWAYS REQUIRED TO INSTALL PROPOSED DETECTOR LOOPS WILL NOT BE PAID FOR SEPARATELY.
4. DETECTOR LOOPS SHALL BE INSTALLED PRIOR TO PLACEMENT OF FINAL SURFACE COURSE.

RESTORATION OF WORK AREA. RESTORATION OF THE TRAFFIC SIGNAL WORK AREA SHALL BE INCIDENTAL TO THE RELATED PAY ITEM AND NO EXTRA COMPENSATION SHALL BE ALLOWED. ALL ROADWAY SURFACES SUCH AS SHOULDERS, MEDIANS, SIDEWALKS, PAVEMENT, ETC. SHALL BE REPLACED IN KIND. ALL DAMAGE TO MOWED LAWNS SHALL BE REPLACED WITH AN APPROVED SOD, AND ALL DAMAGE TO UNMOWED FIELDS SHALL BE SEEDED IN ACCORDANCE WITH STANDARD SPECIFICATIONS 252 AND 250 RESPECTIVELY.

USER NAME = deupier(L.sle)	DESIGNED - TWR	REVISED -
PLOT CONFIG = PDF(Grey, Large).plt	DRAWN - TWR	REVISED -
PLOT SCALE = 1:20	CHECKED - DES	REVISED -
PLOT DATE = 1/19/2012	DATE - 12-19-2011	REVISED -

**PATRICK ENGINEERING INC.**  
 4870 VARSITY DRIVE  
 LISLE, IL 60532  
 patrickengineering.com

**DUPAGE COUNTY  
 DIVISION OF TRANSPORTATION**

**PROPOSED DETECTOR LOOP LAYOUT PLAN  
 75TH STREET OVER EAST BRANCH DUPAGE RIVER**

SCALE: 1"=20' SHEET

FAP RTE.	SECTION	COUNTY	TOTAL SHEETS	SHEET NO.
0369	08-00162-03-BR	DUPAGE	58	23
FED. ROAD DIST. NO.		ILLINOIS FED. AID PROJECT		

G:\DPC001\21158.007\Drawings\RDWY\shhs\STD\DETECTORS.dgn