

DATE	
BY	
SURVEYED	
PLOTTED	
TEMPLATE	
AREAS CHECKED	
NO.	
FINAL SURVEY	
NOTE BOOK	
NO.	

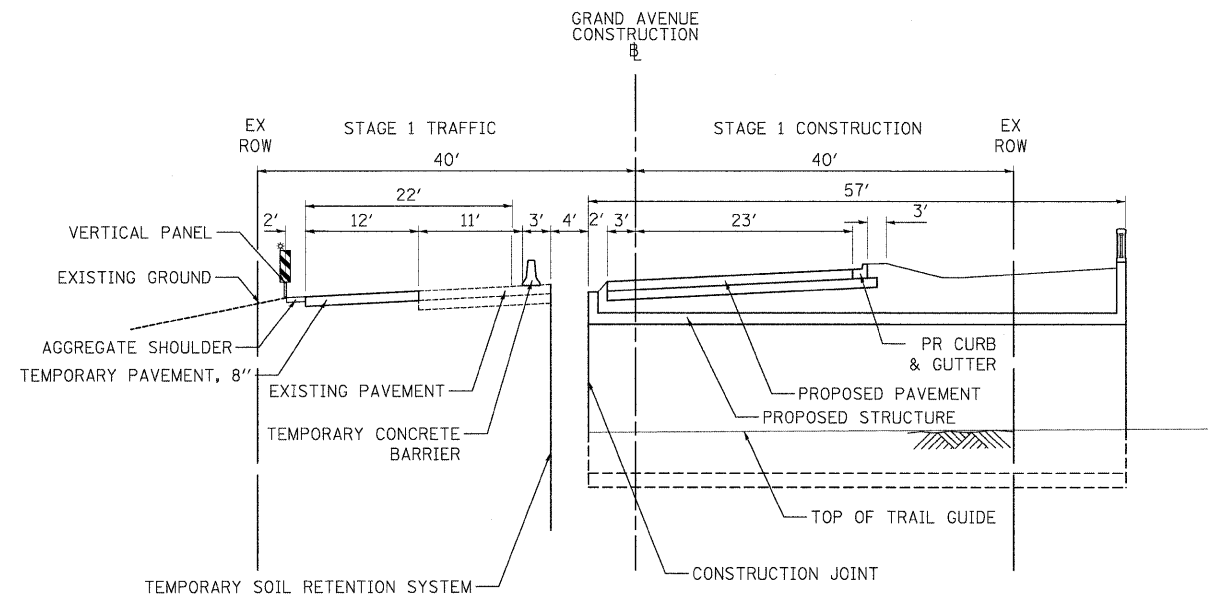

**STAGE 1 TYPICAL**  
STA. 197+40 TO STA. 199+00

**STAGE 1 - CONSTRUCT SOUTHERN SECTION OF UNDERPASS**

1. REMOVE EXISTING PAVEMENT MARKING ON GRAND AVENUE FROM STA. 183+80 TO STA. 212+60 FOR THE WB LANES AND TO STA. 208+60 FOR THE EB LANES.
2. REMOVE CURB AND GUTTER ON THE NORTH SIDE OF GRAND AVENUE FROM STA. 192+93 TO STA. 207+35.
3. PLATE INLETS LOCATED WITHIN CURB AND GUTTER REMOVAL LENGTH.
4. REMOVE CATCH BASIN LOCATED AT STA. 194+12 28.2' LT.
5. CONSTRUCT CONCRETE COLLAR ON EXISTING 12" STORM SEWER AT CATCH BASIN LOCATED AT STA. 194+12 28.2' LT.
6. EXTEND TEMPORARY 12" STORM SEWER AT STA. 194+12 28.2' LT. INTO DITCH.
7. TEMPORARILY ABANDON 12" STORM SEWER FROM STA. 193+01 LT TO 194+12 LT.
8. REMOVE FLARED END SECTION AT STA. 201+75 48.8' LT.
9. EXTEND TEMPORARY 24" STORM SEWER AT STA. 201+75 30 FEET.
10. INSTALL INLET STAND PIPE AT STA. 207+50.
11. PLACE TEMPORARY PAVEMENT ON THE NORTH SIDE OF THE ROAD FROM STA. 192+93 TO STA. 207+35.

ACCESS TO PRIVATE DRIVES MUST BE MAINTAINED AT ALL TIMES DURING CONSTRUCTION EXCEPT FOR PERIODS OF SHORT DURATION WHEN APPROVED BY THE ENGINEER AND IN ACCORDANCE WITH DETAIL LC7201.

TEMPORARY PAVEMENT MARKING TAPE, TYPE III SHALL BE USED WITHIN THE LIMITS OF EXISTING GRAND AVENUE. TEMPORARY PAINT PAVEMENT MARKINGS SHALL BE USED ON ALL TEMPORARY PAVEMENT AREAS.

THE PAVEMENT RECONSTRUCTION OF GRAND AVENUE SHALL BE CONSTRUCTED THROUGH TO BINDER COURSE WITH TEMPORARY PAVEMENT RAMPS AT EACH END AND WITH TEMPORARY PAVEMENT MARKINGS WITHIN THE CONSTRUCTION LIMITS. THE CONSTRUCTION AND REMOVAL OF THE TEMPORARY PAVEMENT RAMPS SHALL BE INCLUDED IN THE COST OF THE HMA FULL-DEPTH PAVEMENT. THE TAPER RATE SHALL BE 7.5 FEET PER 1 INCH.

**LEGEND**

- TEMPORARY PAVEMENT (HMA BINDER, IL-19.0, N50, 8")
- LIMIT OF WORKZONE FOR THIS STAGE
- SUGGESTED CONSTRUCTION ENTRANCE
- TYPE II BARRICADES WITH MONO-DIRECTIONAL STEADY-BURN LIGHTS @ 50' CNTRS (25' AT BEGINNING OF TAPER)
- VERTICAL PANELS WITH MONO-DIRECTIONAL STEADY-BURN LIGHTS @ 50' CNTRS (25' AT BEGINNING OF TAPER)
- DIRECTION OF TRAFFIC
- TEMPORARY TRAFFIC SIGN
- STRUCTURES TO BE ADJUSTED
- STRUCTURES TO BE REMOVED

DATE	
BY	
SURVEYED	
PLOTTED	
TEMPLATE	
AREAS CHECKED	
NO.	
ORIGINAL SURVEY	
NOTE BOOK	
NO.	

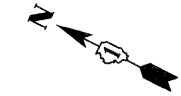
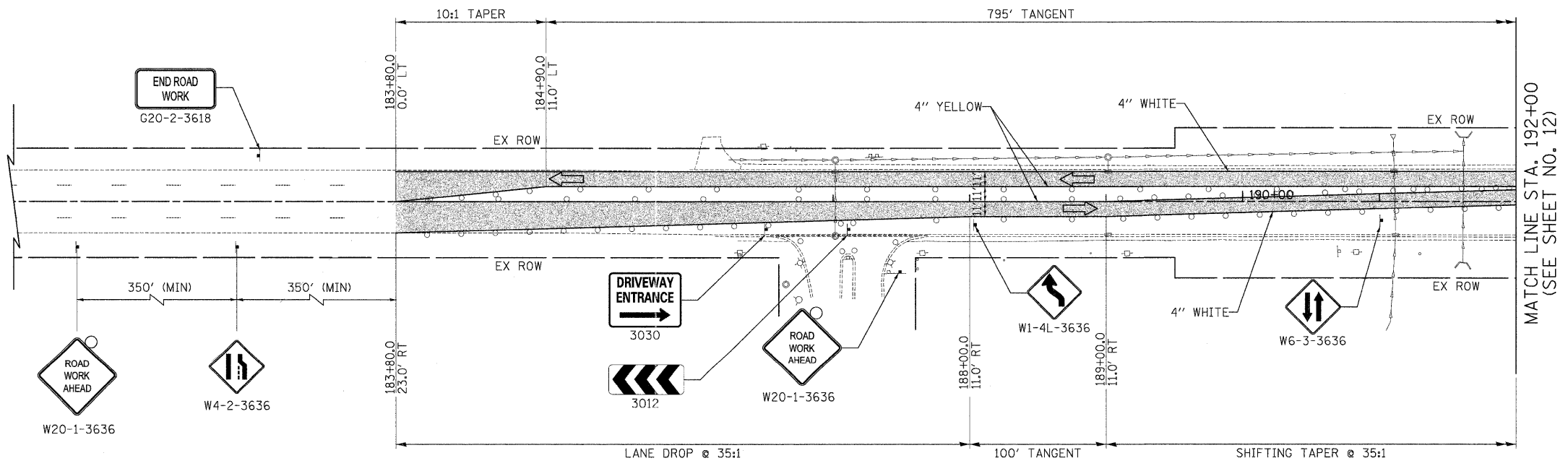

MATCH LINE STA. 192+00  
(SEE SHEET NO. 12)

USER NAME = pk	DESIGNED - PK	REVISED -	<b>STATE OF ILLINOIS DEPARTMENT OF TRANSPORTATION</b>	SCALES HORIZ.	<b>STAGES OF CONSTRUCTION - STAGE 1 GRAND AVENUE UNDERPASS</b>	F.A.P. RTE. 0541	SECTION 10-F3000-00-BT	COUNTY LAKE	TOTAL SHEETS 91	SHEET NO. 13	
FILE NAME ...\\07-MOT\2322_S0C_02_S0C1.dgn	DRAWN - PK	REVISED -				SHEET NO. 1 OF 4 SHEETS STA. 183+80 TO STA. 192+00			CONTRACT NO. 63665		
PLOT SCALE 50.0000 "/> <td>CHECKED - RTM</td> <td>REVISED -</td> <td colspan="3" style="text-align: center;">FED. ROAD DIST. NO. 1 ILLINOIS FED. AID PROJECT</td>	CHECKED - RTM	REVISED -				FED. ROAD DIST. NO. 1 ILLINOIS FED. AID PROJECT					
PLOT DATE = 12/14/2011	DATE = 12/19/2011	REVISED -									