

DATE	
BY	
NO.	
ORIGINAL SURVEY	
SUBMITTED	
PLOTTED	
TEMPLATE	
NOTE BOOK	
AREAS CHECKED	

DATE	
BY	
NO.	
ORIGINAL SURVEY	
SUBMITTED	
PLOTTED	
TEMPLATE	
NOTE BOOK	
AREAS CHECKED	

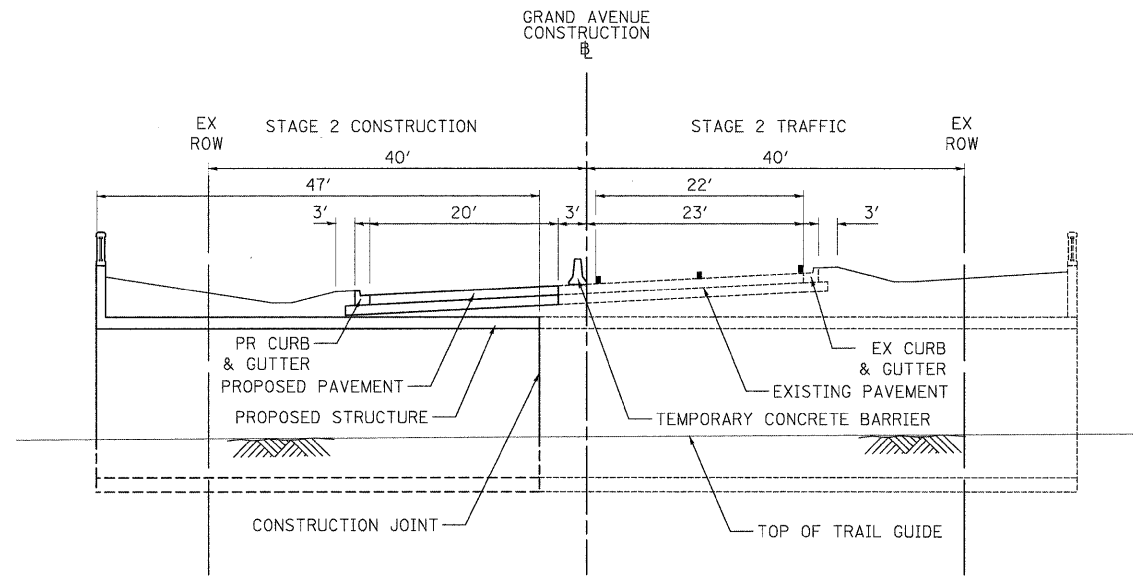

STAGE 2 TYPICAL
STA. 197+40 TO STA. 199+00

STAGE 2 – CONSTRUCT NORTHERN SECTION OF UNDERPASS

1. REMOVE TEMPORARY PAVEMENT FROM STA. 192+93 TO STA. 207+35.
2. REMOVE TEMPORARY STORM SEWER PIPE AT STA. 194+12.
3. INSTALL NEW CATCH BASIN AND CONNECT PREVIOUSLY EXISTING PIPES AT STA. 194+12.
4. REMOVE TEMPORARY STORM SEWER PIPE AT STA. 201+75.
5. INSTALL NEW FLARED END SECTION.
6. REMOVE INLET STAND PIPE AT STA. 207+50.
7. ADJUST INLETS LOCATED WITHIN CURB AND GUTTER REMOVAL LENGTH.
8. PLACE NEW COMBINATION CONCRETE CURB AND GUTTER TYPE B-6.12.

ACCESS TO PRIVATE DRIVES MUST BE MAINTAINED AT ALL TIMES DURING CONSTRUCTION EXCEPT FOR PERIODS OF SHORT DURATION WHEN APPROVED BY THE ENGINEER AND IN ACCORDANCE WITH DETAIL LC7201.

TEMPORARY PAVEMENT MARKING TAPE, TYPE III SHALL BE USED WITHIN THE LIMITS OF EXISTING GRAND AVENUE. TEMPORARY PAINT PAVEMENT MARKINGS SHALL BE USED ON ALL TEMPORARY PAVEMENT AREAS.

THE PAVEMENT RECONSTRUCTION OF GRAND AVENUE SHALL BE CONSTRUCTED THROUGH TO BINDER COURSE WITH TEMPORARY PAVEMENT RAMPS AT EACH END AND WITH TEMPORARY PAVEMENT MARKINGS WITHIN THE CONSTRUCTION LIMITS.

UPON COMPLETION OF UNDERPASS WORK AND AT THE DIRECTION OF THE ENGINEER THE TEMPORARY SOIL RETENTION SYSTEM, CONCRETE BARRIERS AND TEMPORARY PAVEMENT RAMPS SHALL BE REMOVED, FINAL SURFACE COURSE PAVING COMPLETED, ALONG WITH FINAL EARTHWORK GRADING, SHOULDER RESTORATION AND PERMANENT PAVEMENT MARKINGS WITHIN THE LIMITS OF GRAND AVENUE.

LEGEND

- TEMPORARY PAVEMENT (HMA BINDER, IL-19.0, N50, 8")
- LIMIT OF WORKZONE FOR THIS STAGE
- SUGGESTED CONSTRUCTION ENTRANCE
- TYPE II BARRICADES WITH MONO-DIRECTIONAL STEADY-BURN LIGHTS @ 50' CNTRS (25' AT BEGINNING OF TAPER)
- VERTICAL PANELS WITH MONO-DIRECTIONAL STEADY-BURN LIGHTS @ 50' CNTRS (25' AT BEGINNING OF TAPER)
- DIRECTION OF TRAFFIC
- TEMPORARY TRAFFIC SIGN
- STRUCTURES TO BE ADJUSTED
- STRUCTURES TO BE REMOVED

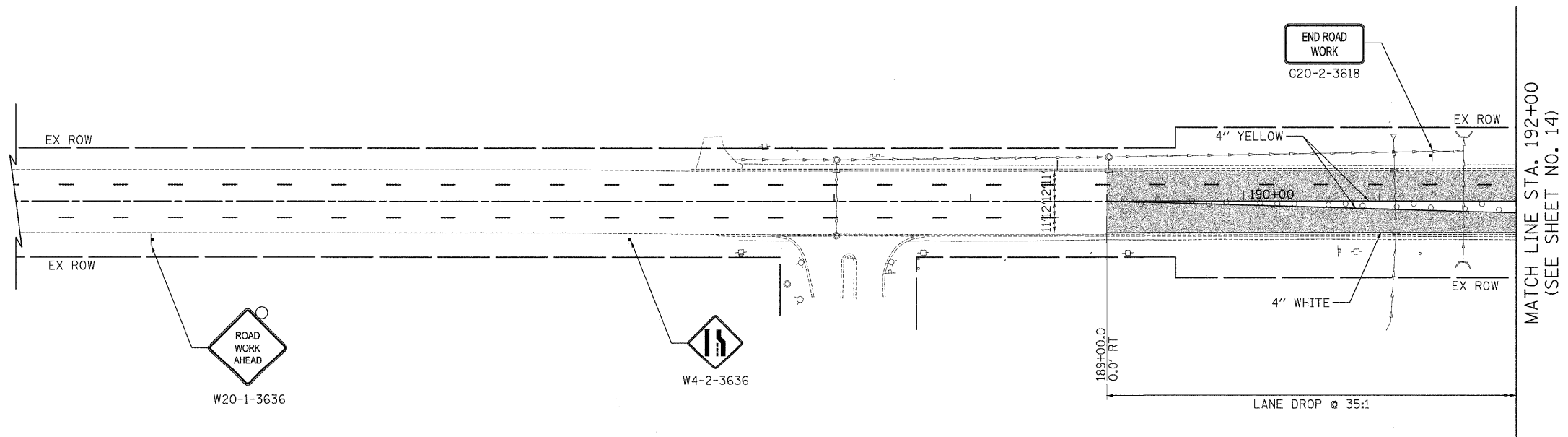

USER NAME = pk	DESIGNED - PK	REVISED -	STATE OF ILLINOIS DEPARTMENT OF TRANSPORTATION	SCALES 	STAGES OF CONSTRUCTION – STAGE 2 GRAND AVENUE UNDERPASS		F.A.P. RTE.	SECTION	COUNTY	TOTAL SHEETS	SHEET NO.
FILE NAME = ...07-M01\2322_S0C_04_S0C2.dgn	DRAWN - PK	REVISED -			0541	10-F3000-00-BT	LAKE	91	15		
PLOT SCALE = 50,0000 1/1 in.	CHECKED - RTM	REVISED -			SHEET NO. 3 OF 4 SHEETS		STA. 189+00 TO STA. 192+00		CONTRACT NO. 63665		
PLOT DATE = 12/14/2011	DATE = 12/19/2011	REVISED -			FED. ROAD DIST. NO. 1 ILLINOIS FED. AID PROJECT						