

PLAN	SURVEYED	DATE
	PLOTTED	BY
	CHECKED	
	REVISIONS	
	NO. OF WAY CHECKED	
	CADD FILE NAME	
	NO.	

PROFILE	SURVEYED	DATE
	PLOTTED	BY
	CHECKED	
	REVISIONS	
	NO. OF WAY CHECKED	
	CADD FILE NAME	
	NO.	

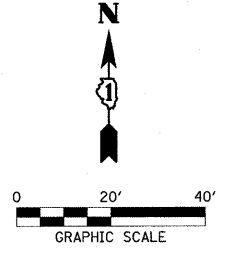

BENCHMARK *6002
WCHD DISC STAMPED "624.39" ON HEADWALL
IN SW CORNER OF 119TH ST. BRIDGE @ DUPAGE RIVER
ELEVATION 624.39

BENCHMARK *6070
CUT BOX ON SE WINGWALL OF 119TH STREET / RODEO DRIVE
BRIDGE @ DUPAGE RIVER
ELEVATION 623.96

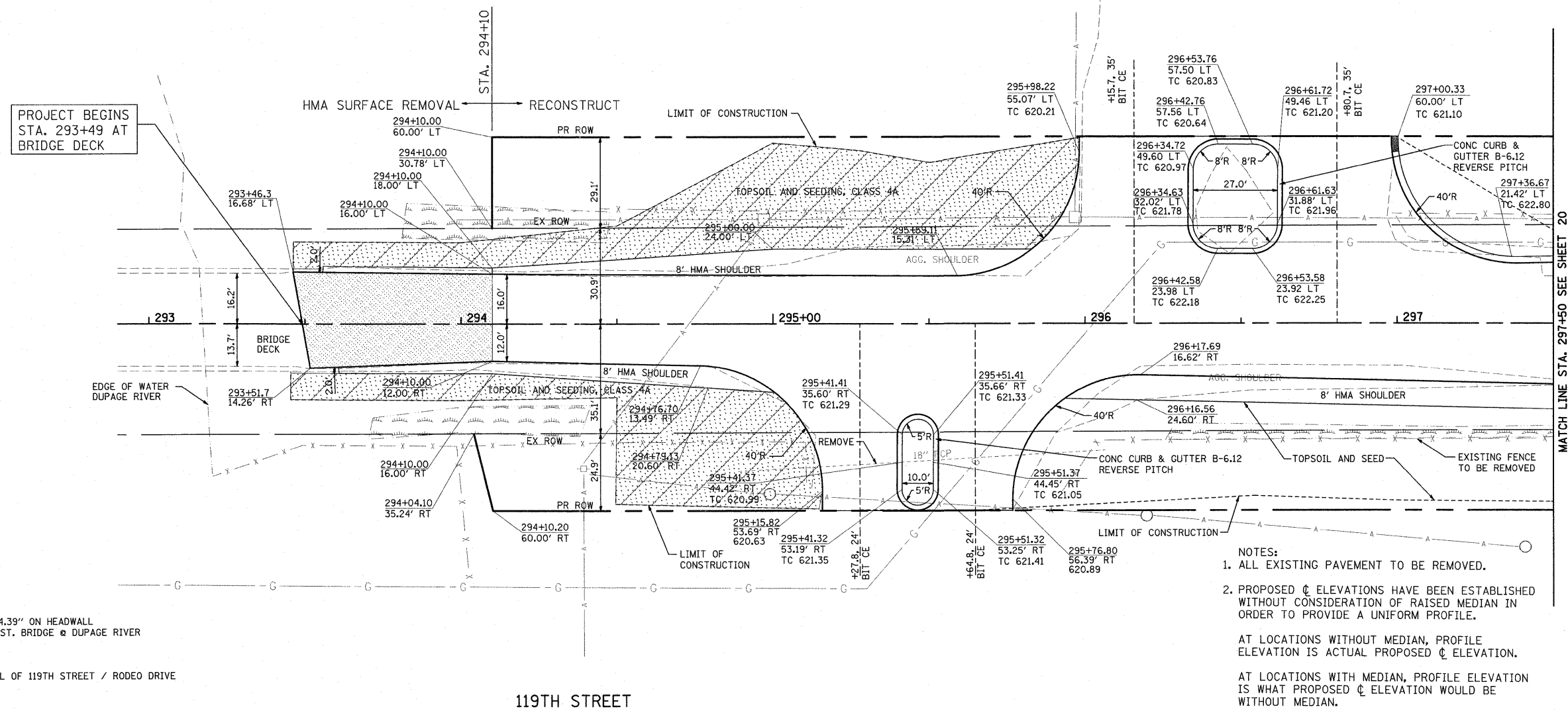

- NOTES:
- ALL EXISTING PAVEMENT TO BE REMOVED.
 - PROPOSED ϕ ELEVATIONS HAVE BEEN ESTABLISHED WITHOUT CONSIDERATION OF RAISED MEDIAN IN ORDER TO PROVIDE A UNIFORM PROFILE.
- AT LOCATIONS WITHOUT MEDIAN, PROFILE ELEVATION IS ACTUAL PROPOSED ϕ ELEVATION.
- AT LOCATIONS WITH MEDIAN, PROFILE ELEVATION IS WHAT PROPOSED ϕ ELEVATION WOULD BE WITHOUT MEDIAN.

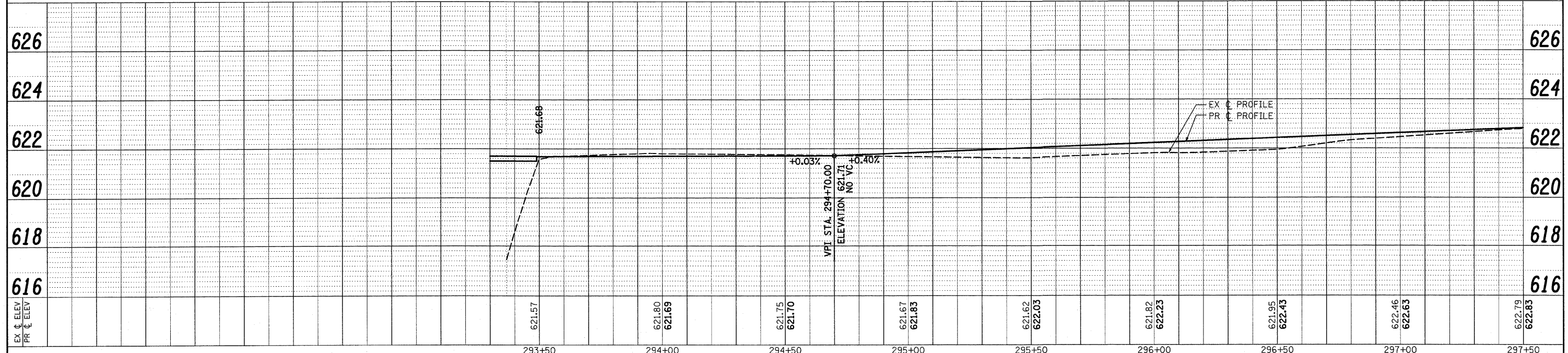

FILE NAME =	USER NAME = #USER#	DESIGNED - CM	REVISED - 09/30/2010	STATE OF ILLINOIS DEPARTMENT OF TRANSPORTATION		ROADWAY PLAN & PROFILE		F.A.U. RTE.	SECTION	COUNTY	TOTAL SHEETS	SHEET NO.
ps:\070116\cad\phase 2\dwg\070116-ah-119th	pp01.dgn	DRAWN - JM	REVISED -			3767	04-00036-22-TL	WILL	152	19		
PLOT SCALE = #SCALE#	CHECKED - CM	REVISED -	REVISED -			CONTRACT NO. 63671						
PLOT DATE = 1/5/2012	DATE - FEBRUARY 2009	REVISED -	REVISED -			ILLINOIS FED. AID PROJECT						

MATCH LINE STA. 297+50 SEE SHEET 20