

PLAN	SURVEYED	DATE
	PLOTTED	BY
	CHECKED	
	RT. OF WAY CHECKED	
	NO. OF CAD FILE NAME	

PROFILE	SURVEYED	DATE
	PLOTTED	BY
	CHECKED	
	RT. OF WAY CHECKED	
	NO. OF CAD FILE NAME	

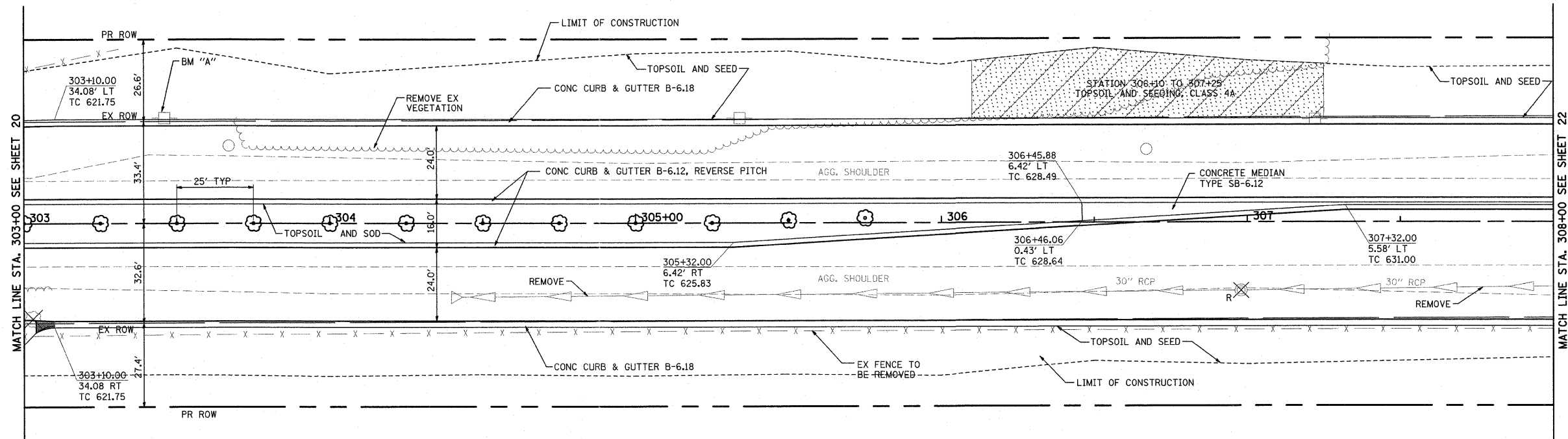
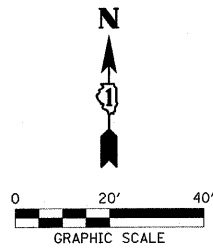

- NOTES:
- ALL EXISTING PAVEMENT TO BE REMOVED.
 - PROPOSED ϕ ELEVATIONS HAVE BEEN ESTABLISHED WITHOUT CONSIDERATION OF RAISED MEDIAN IN ORDER TO PROVIDE A UNIFORM PROFILE.
- AT LOCATIONS WITHOUT MEDIAN, PROFILE ELEVATION IS ACTUAL PROPOSED ϕ ELEVATION.
- AT LOCATIONS WITH MEDIAN, PROFILE ELEVATION IS WHAT PROPOSED ϕ ELEVATION WOULD BE WITHOUT MEDIAN.

BENCHMARK "A"
RAILROAD SPIKE IN PP #5 WEST OF
PLAINFIELD NAPERVILLE ROAD ON 119TH STREET
2.2 AGL ELEVATION 622.63

119TH STREET

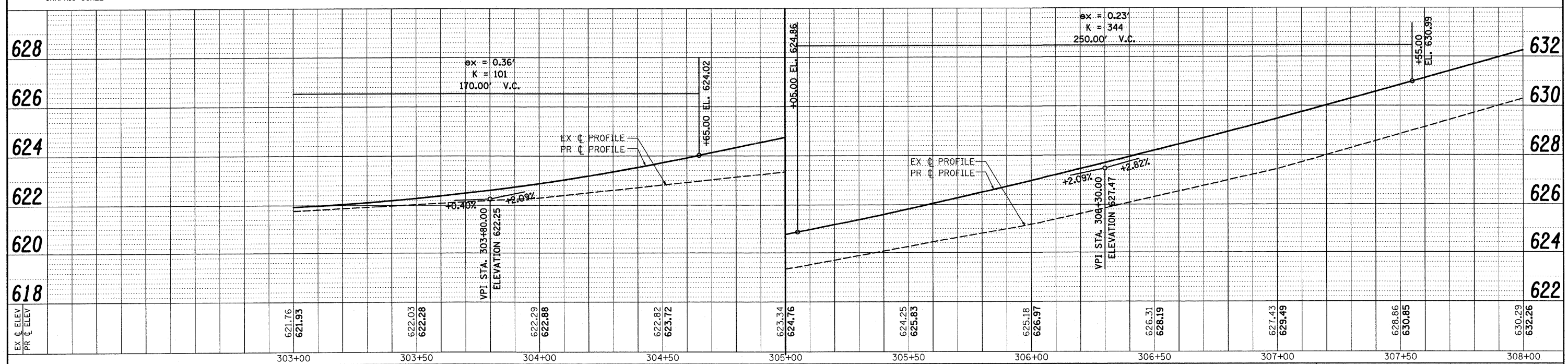

FILE NAME =	USER NAME = #USER#	DESIGNED - CM	REVISED - 09/30/2010	STATE OF ILLINOIS DEPARTMENT OF TRANSPORTATION	HLR	ROADWAY PLAN & PROFILE	F.A.U. RTE.	SECTION	COUNTY	TOTAL SHEETS	SHEET NO.
pp\07\0116\cad\phase 2\dwg\0720116-sht-119th	pp03.dgn	DRAWN - JM	REVISED -				3767	04-00036-22-TL	WILL	152	21
PLOT SCALE = #SCALE#		CHECKED - CM	REVISED -				CONTRACT NO. 63671				
PLOT DATE = 1/5/2012		DATE - FEBRUARY 2009	REVISED -				ILLINOIS FED. AID PROJECT				