

DATE	
BY	
SURVEYED	
PLOTTED	
NOTE BOOK	
AREAS CHECKED	
NO.	

DATE	
BY	
ORIGINAL SURVEY	
PLOTTED	
NOTE BOOK	
AREAS CHECKED	
NO.	

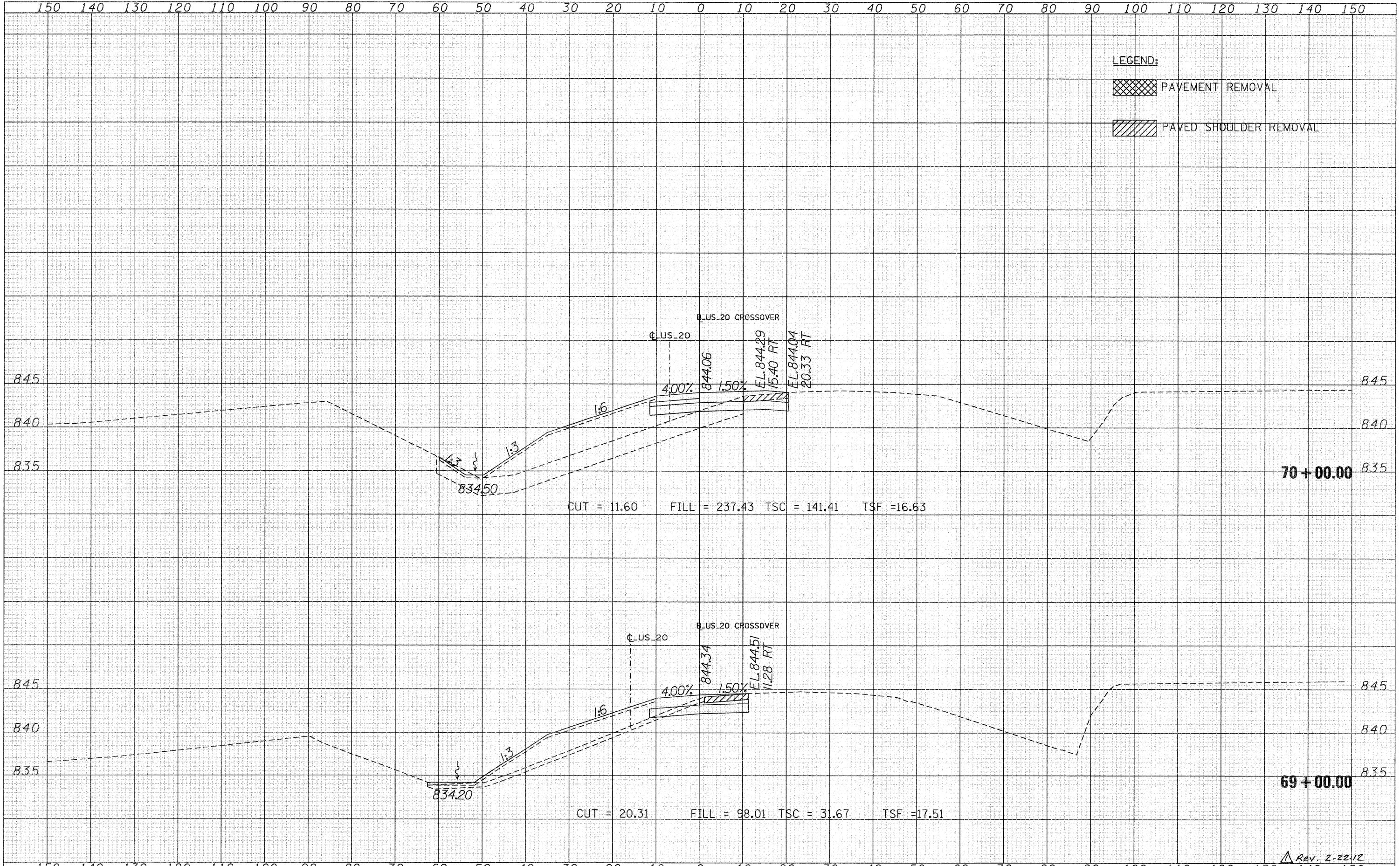

**LEGEND:**  
 PAVEMENT REMOVAL  
 PAVED SHOULDER REMOVAL

FILE NAME =	USER NAME = MMS	DESIGNED -	REVISED -	<b>STATE OF ILLINOIS DEPARTMENT OF TRANSPORTATION</b>	<b>CROSS SECTIONS US 20 CROSSOVER</b>				F.A.P. RTE.	SECTION	COUNTY	TOTAL SHEETS	SHEET NO.	
T:\J6814A\Civil\PAV_Xhta\28PAV_XDXS-shoots.dgn		DRAWN -	REVISED -		SCALE:	SHEET NO.	OF	SHEETS	STA. 69+00.00	TO STA. 70+00.00	301	177-2-1	STEPHENSON	211 124
		PLLOT SCALE = 18.00' / IN.	CHECKED -		REVISED -									CONTRACT NO. 64860
		PLLOT DATE = 9/28/11	DATE -		REVISED -									ILLINOIS FED. AID PROJECT

Rev. 2-22-12