

DATE	
BY	
FINAL SURVEY	
SURVEYED	
PLOTTED	
NOTE BOOK	
AREAS CHECKED	
NO.	

DATE	
BY	
ORIGINAL SURVEY	
SURVEYED	
PLOTTED	
NOTE BOOK	
AREAS CHECKED	
NO.	

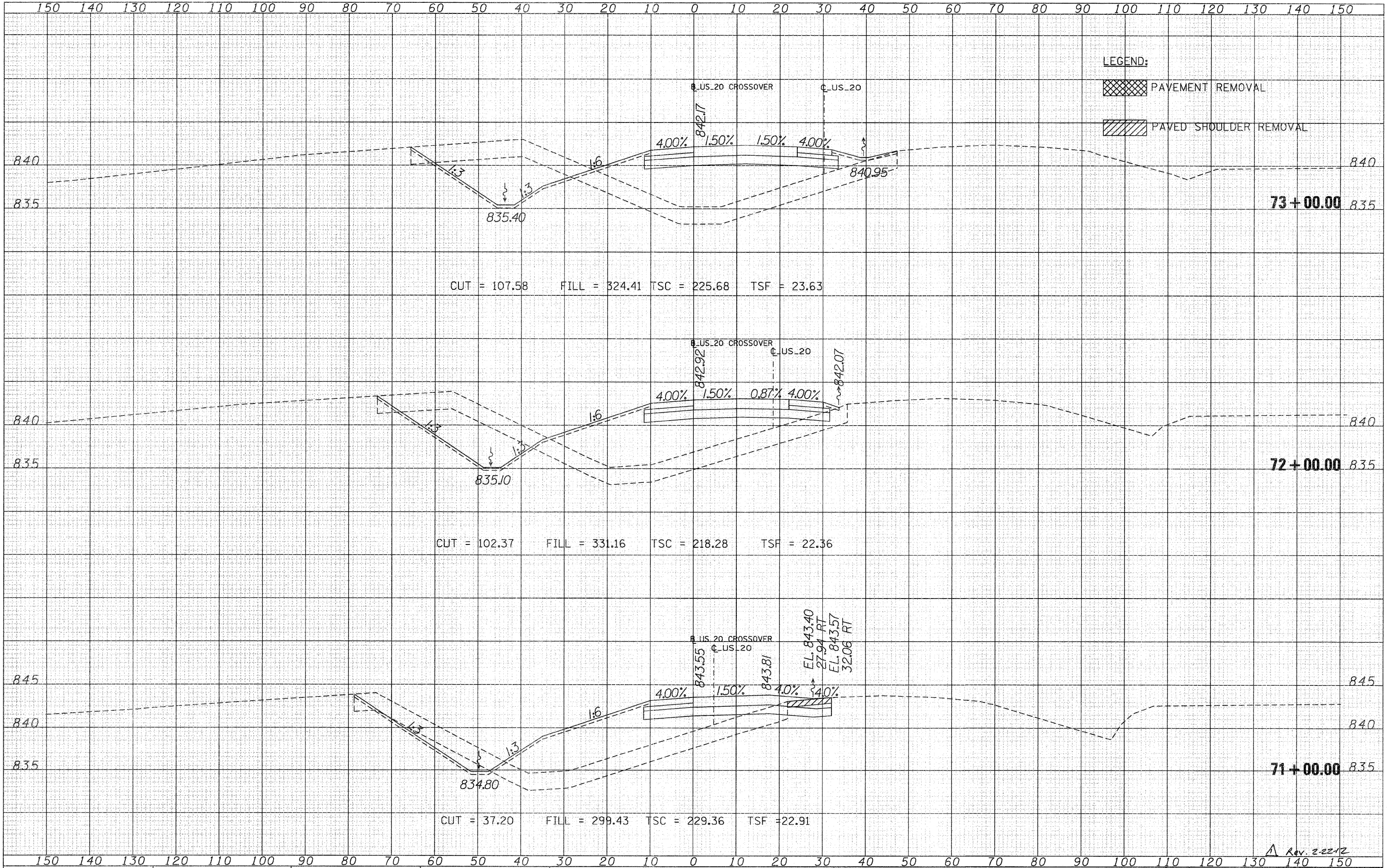

LEGEND:
 PAVEMENT REMOVAL
 PAVED SHOULDER REMOVAL

FILE NAME =	USER NAME = MMS	DESIGNED -	REVISED -	STATE OF ILLINOIS DEPARTMENT OF TRANSPORTATION	CROSS SECTIONS US 20 CROSSOVER				F.A.P. RTE.	SECTION	COUNTY	TOTAL SHEETS	SHEET NO.	
T:\J8814A\Cv1\PAV_Xahsa\28PAV.XDGS-sheets.dgn		DRAWN -	REVISED -		SCALE:	SHEET NO.	OF	SHEETS	STA. 71+00.00	TO STA. 73+00.00	301	177-2-1	STEPHENSON	211 125
		PLOT SCALE = 10.00' / IN.	REVISED -											
		PLOT DATE = 9/28/11	REVISED -											CONTRACT NO. 64860
													ILLINOIS FED. AID PROJECT	

Rev. 2-22-12