

Bench Mark: Point # 62 Iron rod in cap. Sta. 574+18.79, Elev. 797.29, Offset 63.34 Right.  
 North = 2063790.44, East = 2432334.40.  
 Existing Structure: None The existing adjacent structure (SN 089-0055) is Eastbound only.

STATE OF ILLINOIS  
 DEPARTMENT OF TRANSPORTATION

ROUTE NO.	SECTION	COUNTY	TOTAL SHEETS	SHEET NO.	SHEET NO. 1
FAP 301	177-2	STEPHENSON	211	100	24 SHEETS
FED. ROAD DIST. NO. 7	ILLINOIS	FED. AID PROJECT-			

Contract No.

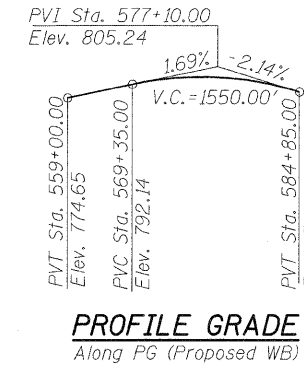
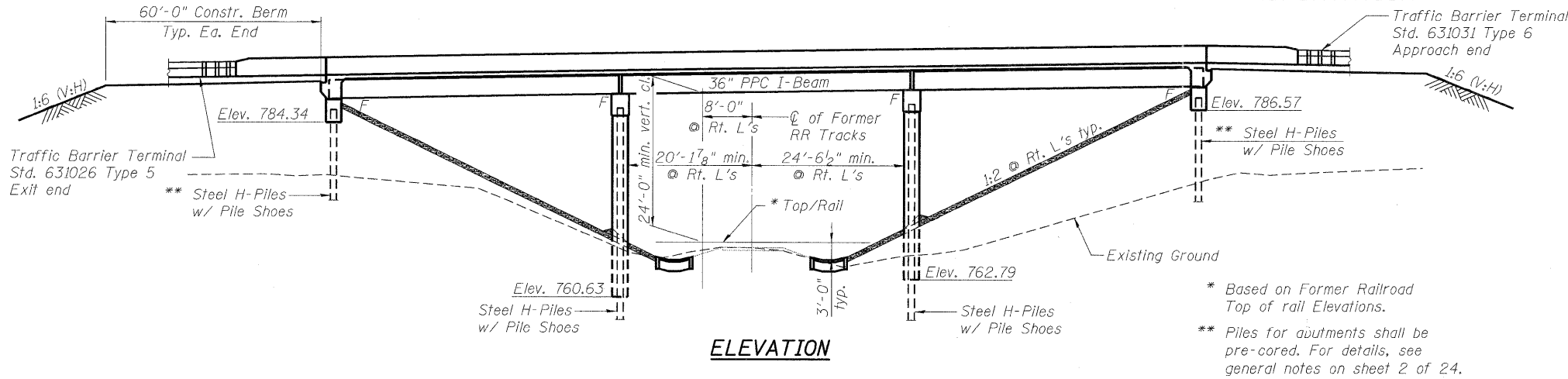

**TOP OF RAIL ELEVATIONS  
 FORMER CENTRAL  
 WISCONSIN R.R.**  
 (From Existing 1985 Design Plans)

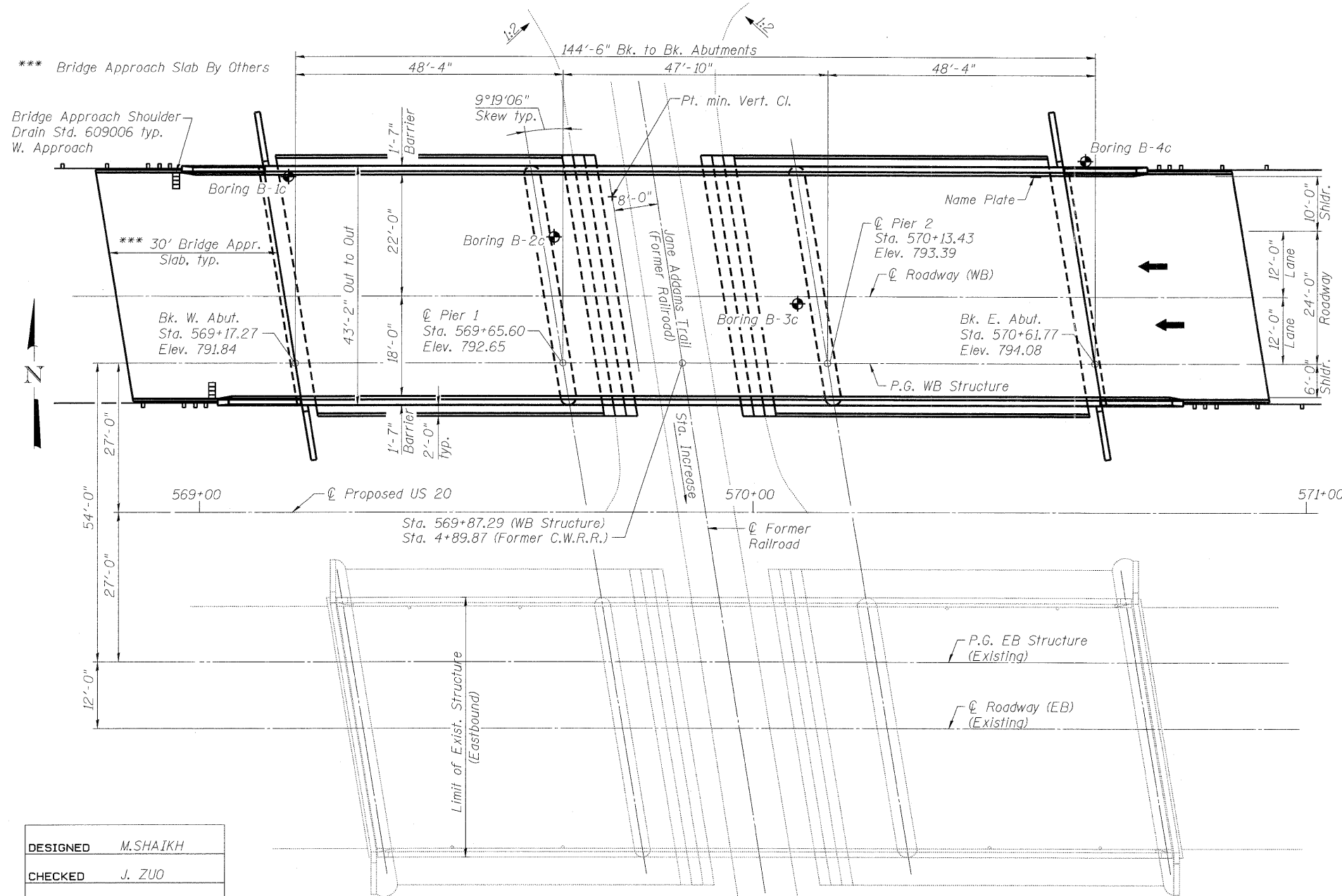

**LOADING HS20-44**  
 Allow 50#/sq. ft. for future wearing surface

**DESIGN SPECIFICATIONS**  
 2002 AASHTO

**DESIGN STRESSES**  
**FIELD UNITS**  
 $f'_c = 3,500$  psi  
 $f_y = 60,000$  psi (Reinforcement)

**PRECAST PRESTRESSED UNITS**  
 $f'_c = 6,000$  psi  
 $f'_{ci} = 5,000$  psi  
 $f'_s = 270,000$  psi ( $1/2$ "  $\phi$ , low relaxation strands)  
 $f_{si} = 201,960$  psi ( $1/2$ "  $\phi$ , low relaxation strands)

**SEISMIC DATA**  
 Seismic Performance Category (SPC) = A  
 Bedrock Acceleration Coefficient (A) = 0.032g  
 Site Coefficient (S) = 1.0

Note:  
 Jane Addams Trail Bridge (SN 089-0083) built as a part of Contract No. 64799.

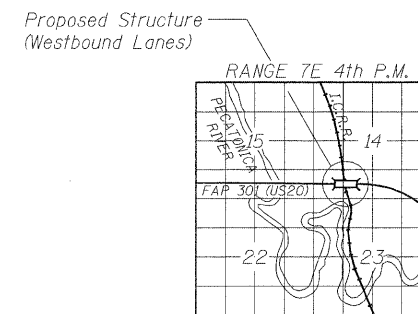

DESIGNED	M. SHAIKH
CHECKED	J. ZUO
DRAWN	D.C. PATEL
CHECKED	J. GRAINAWI

**PARSONS  
 BRINCKERHOFF**  
 280 West Monroe St.  
 Suite 900  
 Chicago, IL 60606  
 (312) 782-8160

**GENERAL PLAN AND ELEVATION  
 U.S. ROUTE 20 OVER  
 JANE ADDAMS TRAIL  
 F.A.P. ROUTE 301 SECTION 177-2VB-1  
 STEPHENSON COUNTY  
 STATION 569+87.29  
 STRUCTURE NO. 089-0083**

FOR INFORMATION ONLY  
 CONTRACT 64860