

STATE OF ILLINOIS
DEPARTMENT OF TRANSPORTATION

ROUTE NO.	SECTION	COUNTY	TOTAL SHEETS	SHEET NO.	SHEET NO. 5 24 SHEETS
FAP 301	177-2	STEPHENSON	211	101	
FED. ROAD DIST. NO. 7	ILLINOIS	FED. AID PROJECT-			

Contract No.

NORTH CURB LINE

Location	Station	Offset	Theoretical Grade Elevations
W. End of West Appr. Slab	568+81.62	-34.42	791.02
A	568+91.62	-34.42	791.19
B	569+01.62	-34.42	791.36
E. End of West Appr. Slab	569+11.62	-34.42	791.53

NORTH EDGE OF PAVEMENT

Location	Station	Offset	Theoretical Grade Elevations
W. End of West Appr. Slab	568+83.33	-24.00	791.27
A	568+93.33	-24.00	791.44
B	569+03.33	-24.00	791.60
E. End of West Appr. Slab	569+13.33	-24.00	791.77

☉ ROADWAY (WB)

Location	Station	Offset	Theoretical Grade Elevations
W. End of West Appr. Slab	568+85.30	-12.00	791.49
A	568+95.30	-12.00	791.66
B	569+05.30	-12.00	791.82
E. End of West Appr. Slab	569+15.30	-12.00	791.99

SOUTH EDGE OF PAVEMENT & P.G. (WB)

Location	Station	Offset	Theoretical Grade Elevations
W. End of West Appr. Slab	568+87.27	0.00	791.33
A	568+97.27	0.00	791.50
B	569+07.27	0.00	791.67
E. End of West Appr. Slab	569+17.27	0.00	791.84

SOUTH CURB LINE

Location	Station	Offset	Theoretical Grade Elevations
W. End of West Appr. Slab	568+88.32	6.42	791.22
A	568+98.32	6.42	791.39
B	569+08.32	6.42	791.55
E. End of West Appr. Slab	569+18.32	6.42	791.72

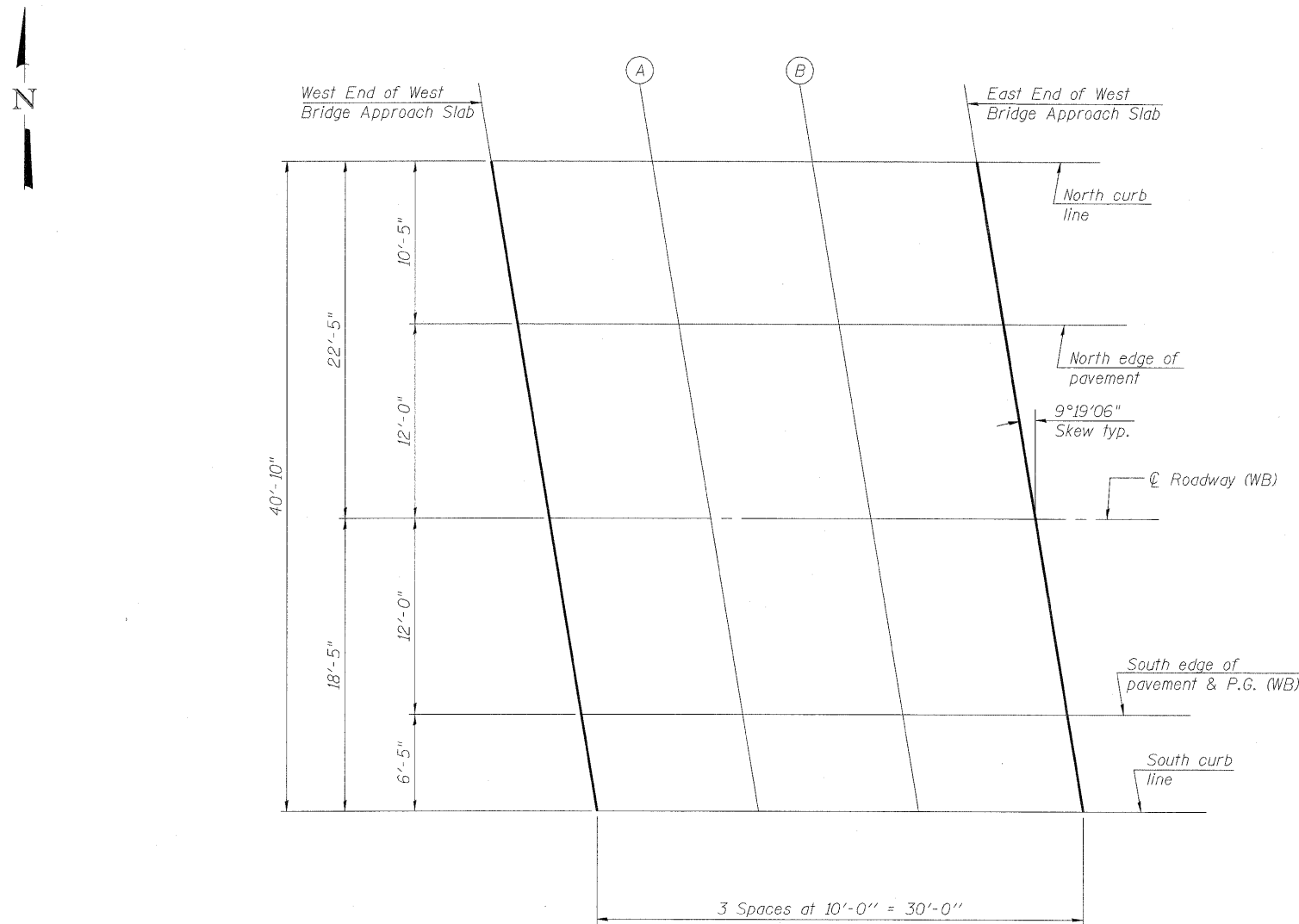

PLAN
(West Bridge Approach Slab)

DESIGNED	H. ALKHATIB
CHECKED	S. CHELBIAN
DRAWN	D. C. PATEL
CHECKED	J. GRAINAWI

**TOP OF WEST APPROACH
SLAB ELEVATIONS**
F.A.P. ROUTE 301 SECTION 177-2VB-1
STEPHENSON COUNTY
STATION 569+87.29
STRUCTURE NO. 089-0083

**PARSONS
BRINCKERHOFF**
280 West Monroe St.
Suite 900
Chicago, IL 60606
(312) 782-6160

CONTRACT 64860

T:\16814\Struct\Cadd\PreFinal\US20 Bridge 089-0083 (Jane Adams Trail Bridge)\000000-64799-000-000-005.dgn
05-DEC-2011 13:17