

NOTES:
 1. TEMPORARY CONCRETE BARRIER OFFSETS ARE MEASURED TO THE TRAFFIC SIDE OF THE WALL.

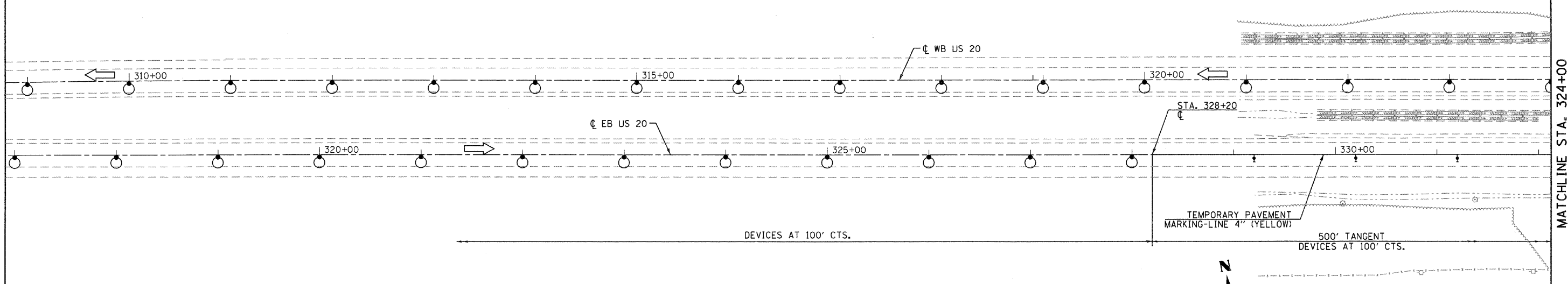

LEGEND

- ARROW BOARD
- WORK AREA
- SIGN
- DIRECTION INDICATOR BARRICADE WITH STEADY BURN MONODIRECTIONAL LIGHT
- TYPE II BARRICADE, DRUM, OR VERTICAL BARRICADE WITH STEADY BURN MONODIRECTIONAL LIGHT
- TEMPORARY CONCRETE BARRIER
- MONODIRECTIONAL BARRIER WALL/GUARDRAIL MARKER
- IMPACT ATTENUATOR
- DIRECTION OF TRAFFIC
- TEMPORARY PAVEMENT
- DRUMS WITH STEADY BURNING MONODIRECTIONAL LIGHT
- TYPE III BARRICADE
- MILL AND RESURFACE

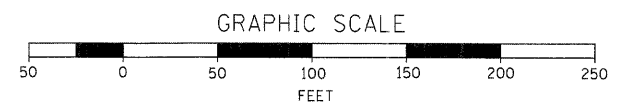
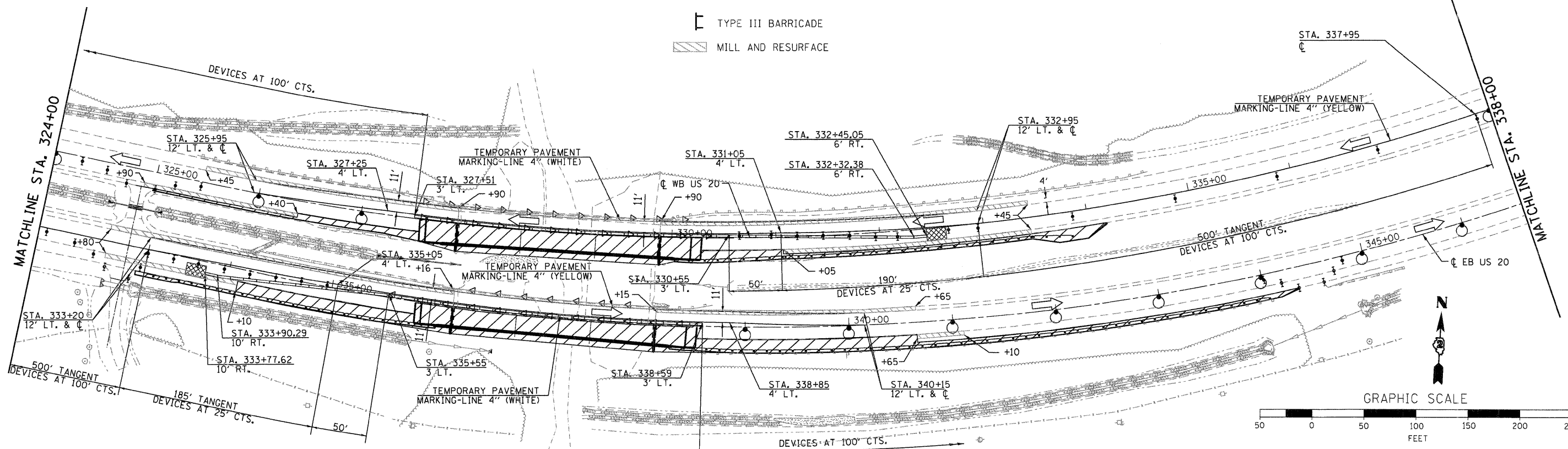
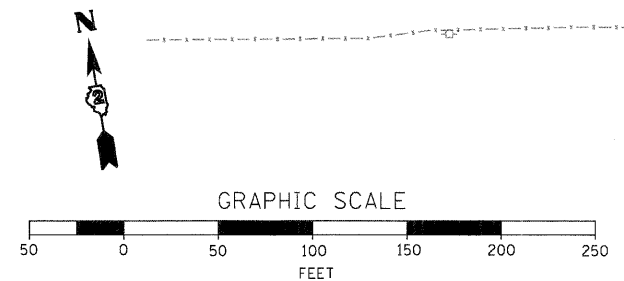

USER NAME = gjameson	DESIGNED -	REVISED -
FILE NAME = Z03207-ahf-staging-SH00K005.dgn	REVISIONS	REVISIONS
PLOT DATE = 12/6/2011	DRAWN -	REVISED -
PLOT TIME = 10:18:44 AM	CHECKED -	REVISED -

WHKS & CO.
 ENGINEERING
 1701 ROUTE 35 NORTH
 EAST DUBUQUE, IL 61025
 (815) 747-8833
 DESIGN FIRM #184001036

STATE OF ILLINOIS
 DEPARTMENT OF TRANSPORTATION

US 20 TRAFFIC CONTROL PLANS (STAGE 1)
 SN 043-0004 & SN 043-0005
 SCALE: 1"=50' SHEET NO. 1 OF 2 SHEETS STA. 310+00 TO STA. 338+00

F.A.P. RTE.	SECTION	COUNTY	TOTAL SHEETS	SHEET NO.
301	(43B,44B,44HB,45B)D	JO DAVIESS	309	64
				CONTRACT NO. 64C94
ILLINOIS FED. AID PROJECT				