

- ↑ ARROW BOARD
- ▨ WORK AREA
- ⊥ SIGN
- ↑ DIRECTION INDICATOR BARRICADE WITH STEADY BURN MONODIRECTIONAL LIGHT
- ⊥ TYPE II BARRICADE, DRUM, OR VERTICAL BARRICADE WITH STEADY BURN MONODIRECTIONAL LIGHT

**LEGEND**

- ▬ TEMPORARY CONCRETE BARRIER
- ◁ MONODIRECTIONAL BARRIER WALL/GUARDRAIL MARKER
- ▩ IMPACT ATTENUATOR
- ← DIRECTION OF TRAFFIC
- ▬ TEMPORARY PAVEMENT
- DRUMS WITH STEADY BURNING MONODIRECTIONAL LIGHT
- ⊥ TYPE III BARRICADE
- ▨ MILL AND RESURFACE

NOTES:  
 1. TEMPORARY CONCRETE BARRIER WALL OFFSETS ARE MEASURED TO THE TRAFFIC SIDE OF THE WALL

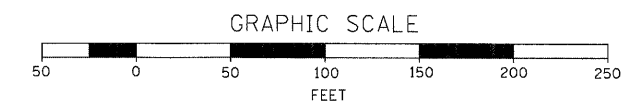
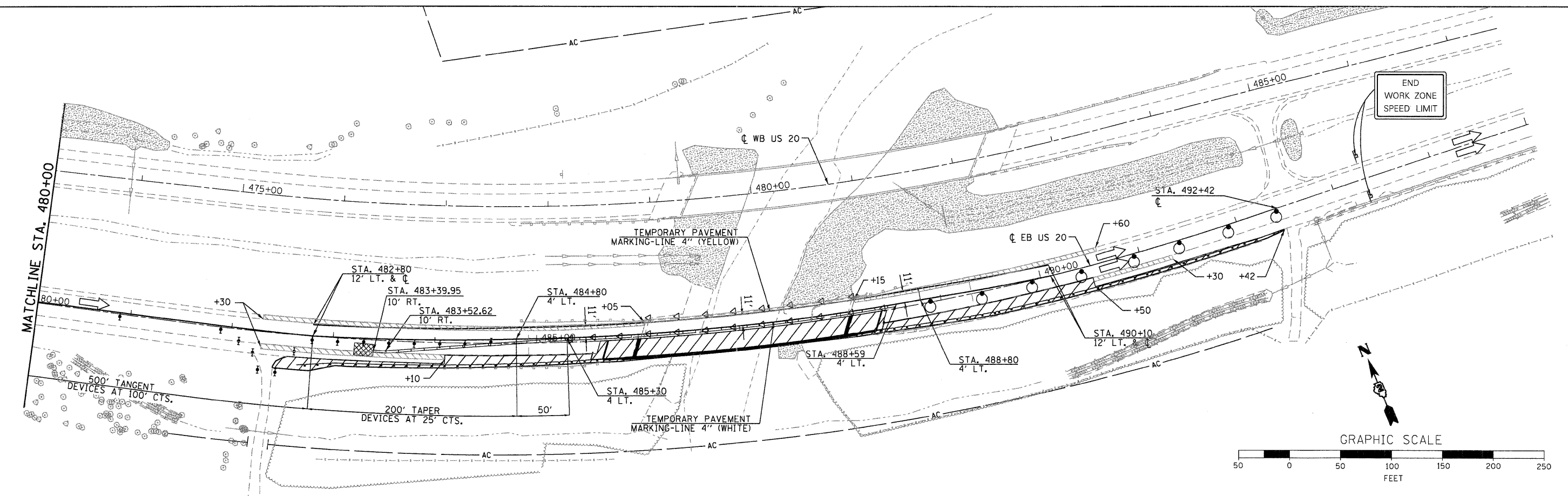
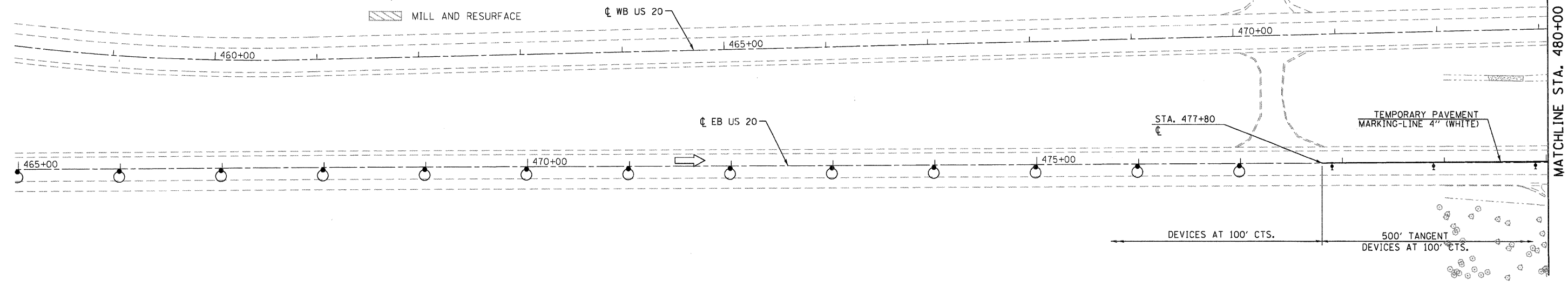

USER NAME = gjameson	DESIGNED -	REVISED -
FILE NAME = 203207-shr-staging	CHECKED -	REVISED -
PLOT DATE = 12/6/2011	DRAWN -	REVISED -
PLOT TIME = 10:19:07 AM	CHECKED -	REVISED -

**WHKS & CO.**  
 ENGINEERING  
 1701 ROUTE 35 NORTH  
 EAST DUBUQUE, IL 61025  
 (815) 747-8833  
 DESIGN FIRM #184001036

**STATE OF ILLINOIS**  
**DEPARTMENT OF TRANSPORTATION**

**US 20 TRAFFIC CONTROL PLANS (STAGE 1)**  
**SN 043-0007 (EB)**  
 SCALE: 1"=50' SHEET NO. 1 OF 1 SHEETS STA. 465+00 TO STA. 495+00

F.A.P. RTE. 301	SECTION (43B,44B,44HB,45B)D	COUNTY JO DAVIESS	TOTAL SHEETS 309	SHEET NO. 74
CONTRACT NO. 64C94				ILLINOIS FED. AID PROJECT