

Bench Mark: Chiseled "□" NW wingwall of the WB Structure, 19.09' Lt. at Sta. 327+81.07 - Elev. 676.68.

Existing Structure: S.N. 043-0004 & S.N. 043-0005 built in 1965 as F.A. Route 6 (S.B.I. Rte. 5), Section 44-B. Each structure consists of a 3 span reinforced concrete deck on continuous WF steel beams supported by 2 reinforced concrete stub abutments founded on steel piles and 2 reinforced concrete single hammerhead piers founded on spread footings. The bridge deck was repaired in 1970-71, 1994, and 2001. Structural steel was cleaned and painted 1987. The slopewalls were repaired in 1984. 197'-8" back-to-back abutments and 35'-8" out-to-out deck. Concrete deck to be removed and replaced using stage construction.

No salvage

SCOPE OF WORK

1. Remove and replace existing concrete deck.
2. Remove and replace existing slope wall with riprap.
3. Replace steel rocker bearings at abutments with elastomeric bearings.
4. Remove and replace end diaphragms.
5. Replace Approach slabs.
6. Clean and paint existing structural steel.
7. Clean, paint and reuse fixed and expansion bearings at piers.
8. Make new deck composite full length of bridge.
9. Reconfigure existing abutments and wingwalls to semi-integral.

INDEX OF SHEETS

1. General Plan & Elevation
2. General Data
3. Stage Construction Details
4. Temporary Sheet Piling
5. Temporary Concrete Barrier for Stage Construction
- 6.-10. Top of Slab Elevations
11. W.B. Approach Slab Elevations
12. E.B. Approach Slab Elevations
13. Superstructure
- 14.-15. Superstructure Details
- 16.-17. Bridge Approach Slab Details
18. Framing Plan
19. Structural Steel Details
20. Bearing Details
21. West Abutment Concrete Removal
22. East Abutment Concrete Removal
23. West Abutment (S.N. 043-0005)
24. East Abutment (S.N. 043-0005)
25. West Abutment (S.N. 043-0004)
26. East Abutment (S.N. 043-0004)
27. Bar Splicer Assembly and Mechanical Splicer Details

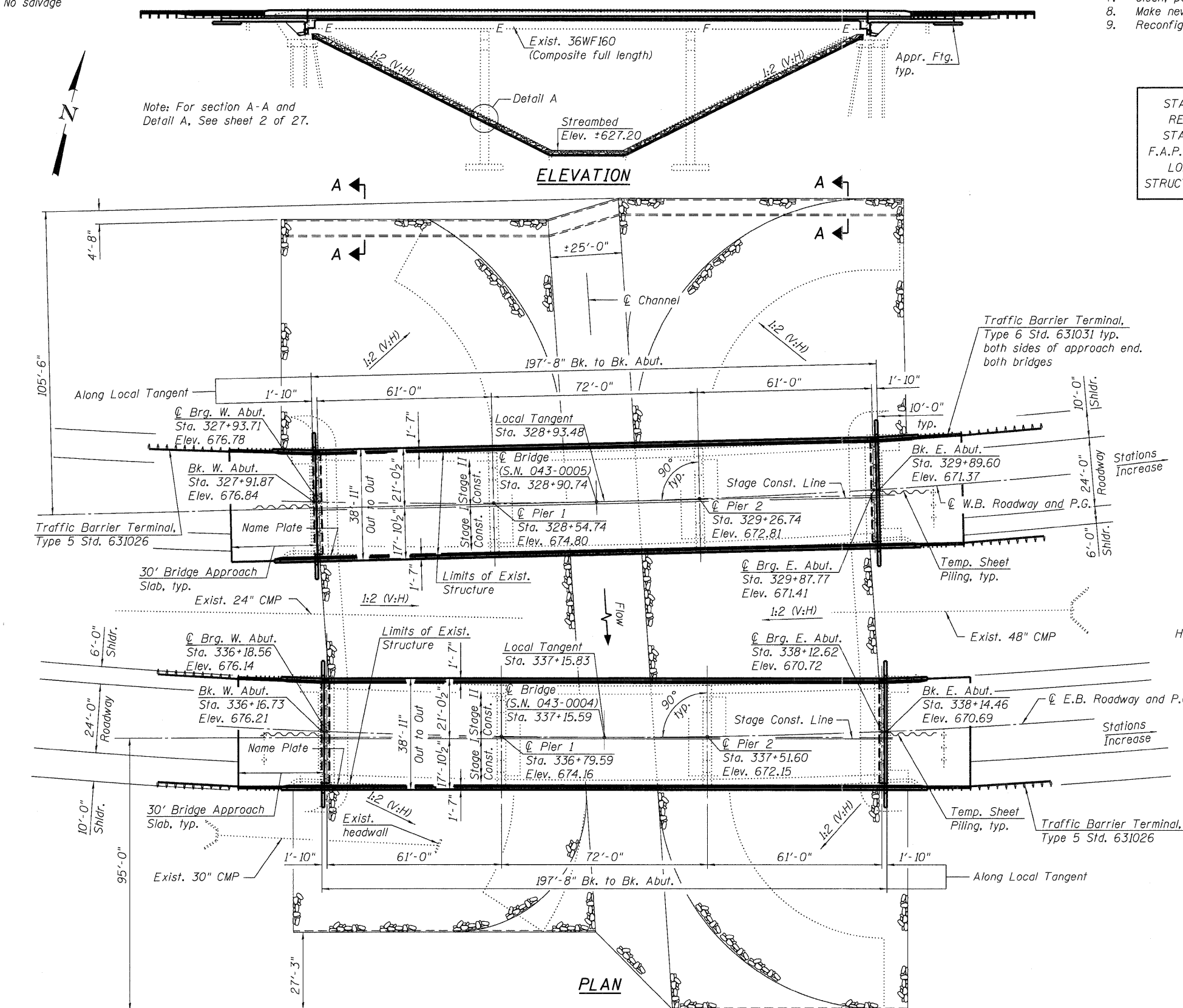

STATION 328+90.74 REBUILT 20 BY STATE OF ILLINOIS F.A.P. RT. 301 SEC. 44B LOADING HS20-44 STRUCTURE NO. 043-0005	STATION 337+15.59 REBUILT 20 BY STATE OF ILLINOIS F.A.P. RT. 301 SEC. 44B LOADING HS20-44 STRUCTURE NO. 043-0004
---	---

NAME PLATES

See Std. 515001
Existing Name Plate shall be cleaned and relocated next to new Name Plate. Cost included with Name Plates.

LOADING HS20-44

Allow 25#/sq. ft. for future wearing surface.

DESIGN SPECIFICATIONS

2002 AASHTO

DESIGN STRESSES

FIELD UNITS (New Construction)

$f'_c = 3,500$ psi
 $f_y = 60,000$ psi (reinforcement)
 $f_y = 36,000$ psi (structural steel)

FIELD UNITS (Existing Construction)

$f'_c = 3,500$ psi
 $f_y = 40,000$ psi (reinforcement)
 $f_y = 33,000$ psi (structural steel)

SEISMIC DATA

Seismic Performance Category (SPC) = A
Horizontal Bedrock Acceleration Coefficient (A) = 0.03g
Site Coefficient (S) = 1.5

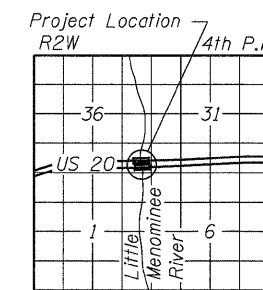
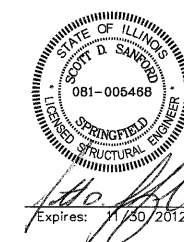
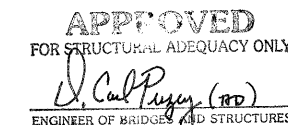

LOCATION SKETCH

GENERAL PLAN & ELEVATION
U.S. ROUTE 20 OVER
LITTLE MEMONINEE RIVER
F.A.P. ROUTE 301 - SEC. 44B
JO DAVIESS COUNTY
STATION 328+90.74 (W.B.)
STATION 337+15.59 (E.B.)
STRUCTURE NO. 043-0005 (W.B.)
STRUCTURE NO. 043-0004 (E.B.)