

DATE	07/11
BY	CHAMIN & ASSOCIATES
PLANNED	
PLOTTED	
ALIGNED	
CHECKED	
NO. 03/11	
NOTE BOOK	
FILE NAME	D366A48-SHT-PLNPRF-245-260.DGN

DATE	07/11
BY	CHAMIN & ASSOCIATES
PLANNED	
PLOTTED	
ALIGNED	
CHECKED	
NO. 03/11	
NOTE BOOK	
FILE NAME	D366A48-SHT-PLNPRF-245-260.DGN

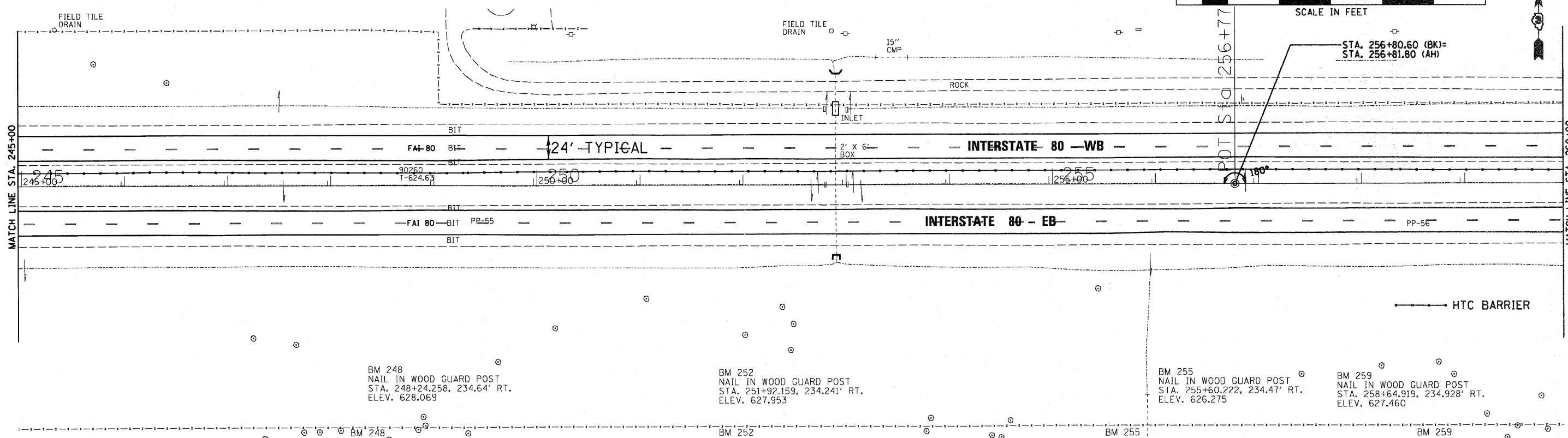
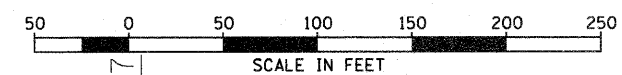

BM 248  
NAIL IN WOOD GUARD POST  
STA. 248+24.258, 234.64' RT.  
ELEV. 628.069

BM 252  
NAIL IN WOOD GUARD POST  
STA. 251+92.159, 234.241' RT.  
ELEV. 627.953

BM 255  
NAIL IN WOOD GUARD POST  
STA. 255+60.222, 234.47' RT.  
ELEV. 626.275

BM 259  
NAIL IN WOOD GUARD POST  
STA. 258+64.919, 234.928' RT.  
ELEV. 627.460

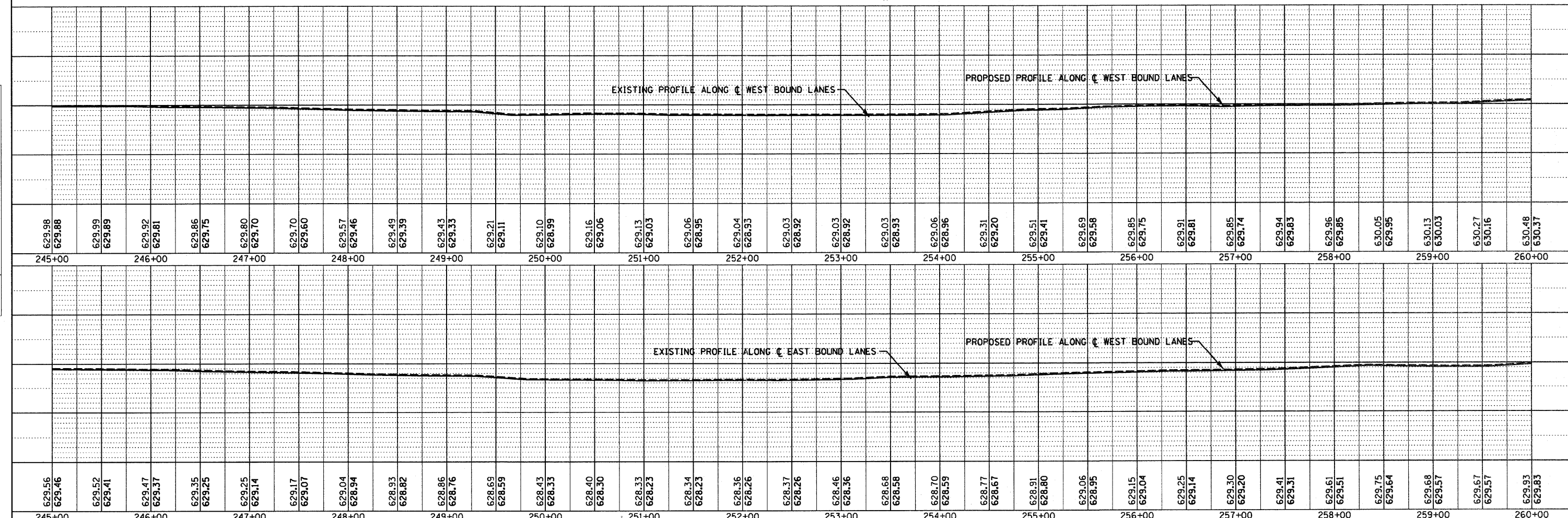

FILE NAME =	D366A48-SHT-PLNPRF-245-260.DGN	USER NAME =		DESIGNED -		REVISED -		<b>STATE OF ILLINOIS</b> <b>DEPARTMENT OF TRANSPORTATION</b>	<b>PLAN &amp; PROFILE - I-80</b> SCALE: 1"=50'    SHEET NO.    OF    SHEETS    STA. 245+00 TO STA. 260+00	F.A.I. RTE.    SECTION    COUNTY    TOTAL SHEETS    SHEET NO. I-80 (50-2,4)RS-5 & (50-3)RS-6    LASALLE    109    39	CONTRACT NO. 66A48 ILLINOIS FED. AID PROJECT
PLLOT SCALE =	1"=50'	DRAWN -	LAG	REVISED -							
PLLOT DATE =	05/11	CHECKED -	DJD	REVISED -							