

EXIST. CURVE EXCL-1  
 PI STA. = 55+36.33  
 $\Delta$  = 29° 16' 25" (RT)  
 D = 16° 30' 00"  
 R = 347.25'  
 T = 90.69'  
 L = 177.42'  
 E = 11.65'  
 e = -----  
 T.R. = -----  
 S.E. RUN = -----  
 P.C. STA. = 54+45.64  
 P.T. STA. = 56+23.05

EXIST. CURVE EXCL-2  
 PI STA. = 58+55.11  
 $\Delta$  = 10° 30' 35" (RT)  
 D = 3° 30' 00"  
 R = 1,637.01'  
 T = 150.56'  
 L = 300.28'  
 E = 6.91'  
 e = -----  
 T.R. = -----  
 S.E. RUN = -----  
 P.C. STA. = 57+04.55  
 P.T. STA. = 60+04.82

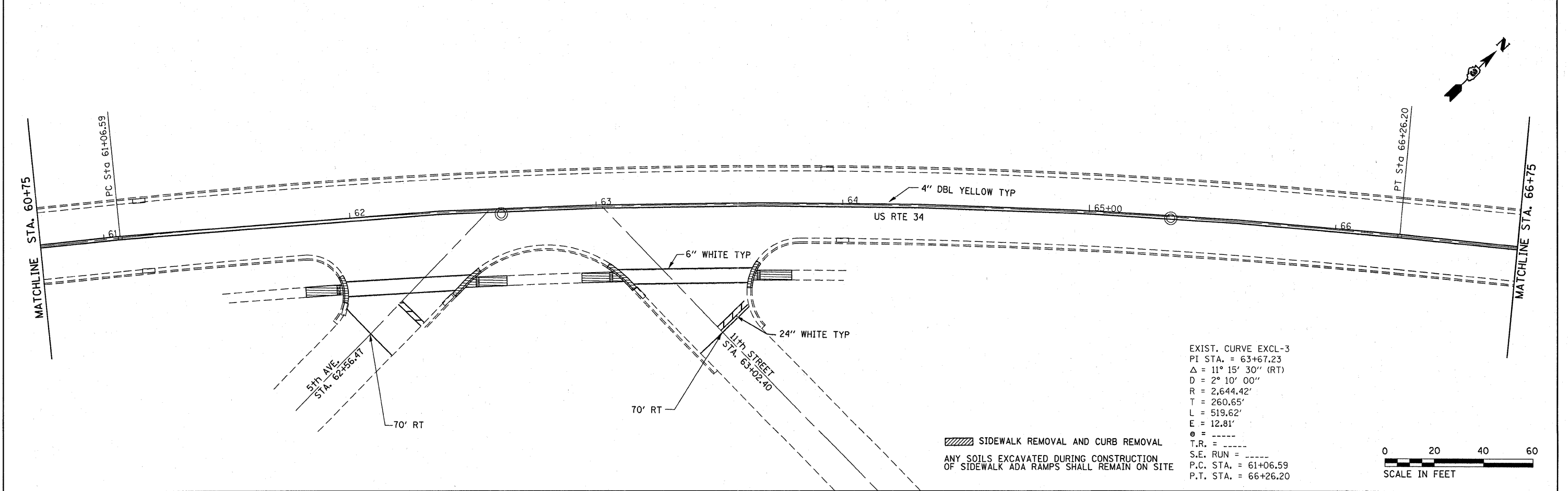

EXIST. CURVE EXCL-3  
 PI STA. = 63+67.23  
 $\Delta$  = 11° 15' 30" (RT)  
 D = 2° 10' 00"  
 R = 2,644.42'  
 T = 260.65'  
 L = 519.62'  
 E = 12.81'  
 e = -----  
 T.R. = -----  
 S.E. RUN = -----  
 P.C. STA. = 61+06.59  
 P.T. STA. = 66+26.20

▨ SIDEWALK REMOVAL AND CURB REMOVAL  
 ANY SOILS EXCAVATED DURING CONSTRUCTION  
 OF SIDEWALK ADA RAMPS SHALL REMAIN ON SITE

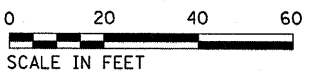

FILE NAME =	USER NAME = quigleyml	DESIGNED -	REVISED -	<b>STATE OF ILLINOIS DEPARTMENT OF TRANSPORTATION</b>	<b>PLAN VIEW US 34 IN MENDOTA</b>			F.A.P. RTE: 587	SECTION (20)XRS-2	COUNTY LASALLE	TOTAL SHEETS 16	SHEET NO. 16
c:\pwork\pwork\quigleyml\0253613\036816-plen1.dgn	PLOT SCALE = 20,0000' / in.	DRAWN -	REVISED -		SCALE:	SHEET NO.	OF	SHEETS	STA. 54+75	TO STA. 66+75	CONTRACT NO. 66B16	
PLOT DATE = 11/30/2011	DATE -	CHECKED -	REVISED -		ILLINOIS FED. AID PROJECT							
		DATE -	REVISED -									