

GENERAL NOTES

REINFORCEMENT BARS DESIGNATED (E) SHALL BE EPOXY COATED.

WATERPROOFING MEMBRANE SHALL BE APPLIED TO THE DESIGNATED AREAS ON THE BACKSIDE OF THE WINGWALL AS DETAILED.

TRAFFIC CONTROL AND PROTECTION PLAN FOR THIS LOCATION SHALL BE ACCORDING TO TRAFFIC CONTROL AND PROTECTION STANDARD(S) 701321 AND 704001.

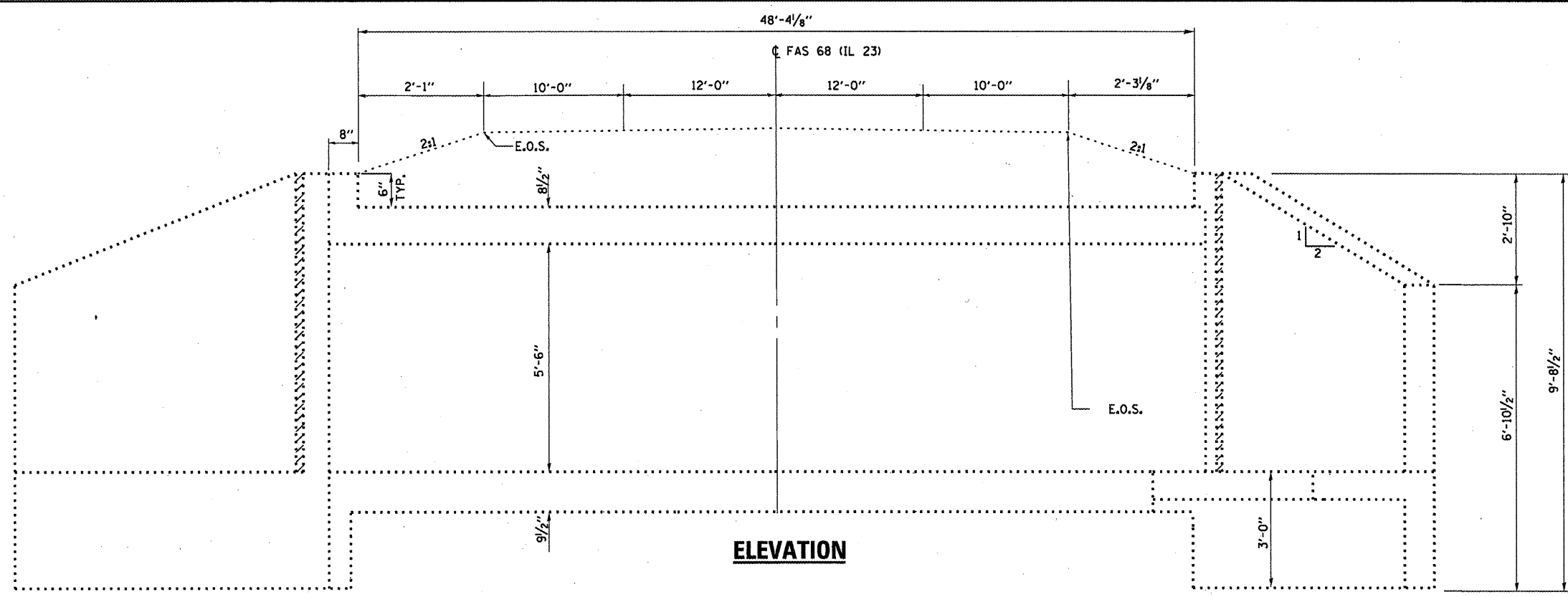

ELEVATION

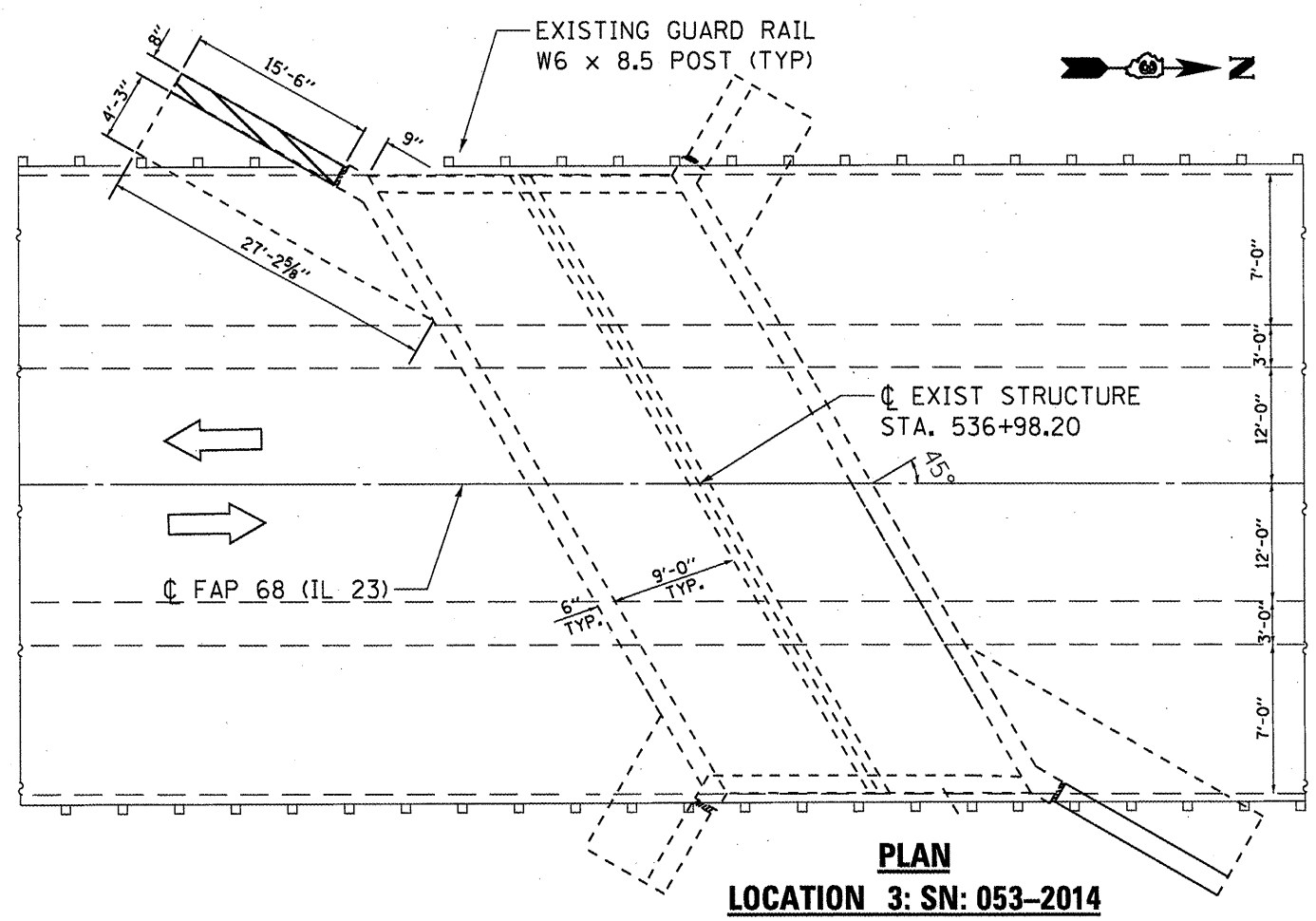

**PLAN
LOCATION 3: SN: 053-2014**

 **DAMAGED WING WALL
TO BE REPLACED**

TOTAL BILL OF MATERIAL

ITEM	UNIT	TOTAL
STRUCTURE EXCAVATION	CU YD	9
EARTH EXCAVATION	CU YD	15
FURNISHED EXCAVATION	CU YD	24
AGGREGATE SHOULDERS, TYPE B	CU YD	3.0
CONCRETE REMOVAL	CU YD	2.0
CONCRETE BOX CULVERTS	CU YD	2.0
REINFORCEMENT BARS (EPOXY COATED)	POUND	237
SHEET WATERPROOFING MEMBRANE SYSTEM	SQ YD	6.0
TEMPORARY SOIL RETENTION SYSTEM	SQ FT	576
REMOVE & REERECT STEEL PLATE BEAM GUARD RAIL, TYPE A	FOOT	37.5
STRUCTURAL REPAIR OF CONCRETE (DEPTH EQUAL TO OR LESS THAN 5 INCHES)	SQ FT	18.0

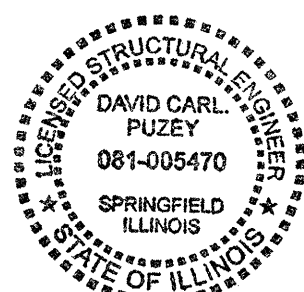

David Carl Puzey 1/31/12
Expires 11/30/12