

**GENERAL NOTES**

REINFORCEMENT BARS DESIGNATED (E) SHALL BE EPOXY COATED.  
 WATERPROOFING MEMBRANE SHALL BE APPLIED TO THE DESIGNATED AREAS ON THE BACKSIDE OF THE WINGWALL AS DETAILED.

**ELEVATION**

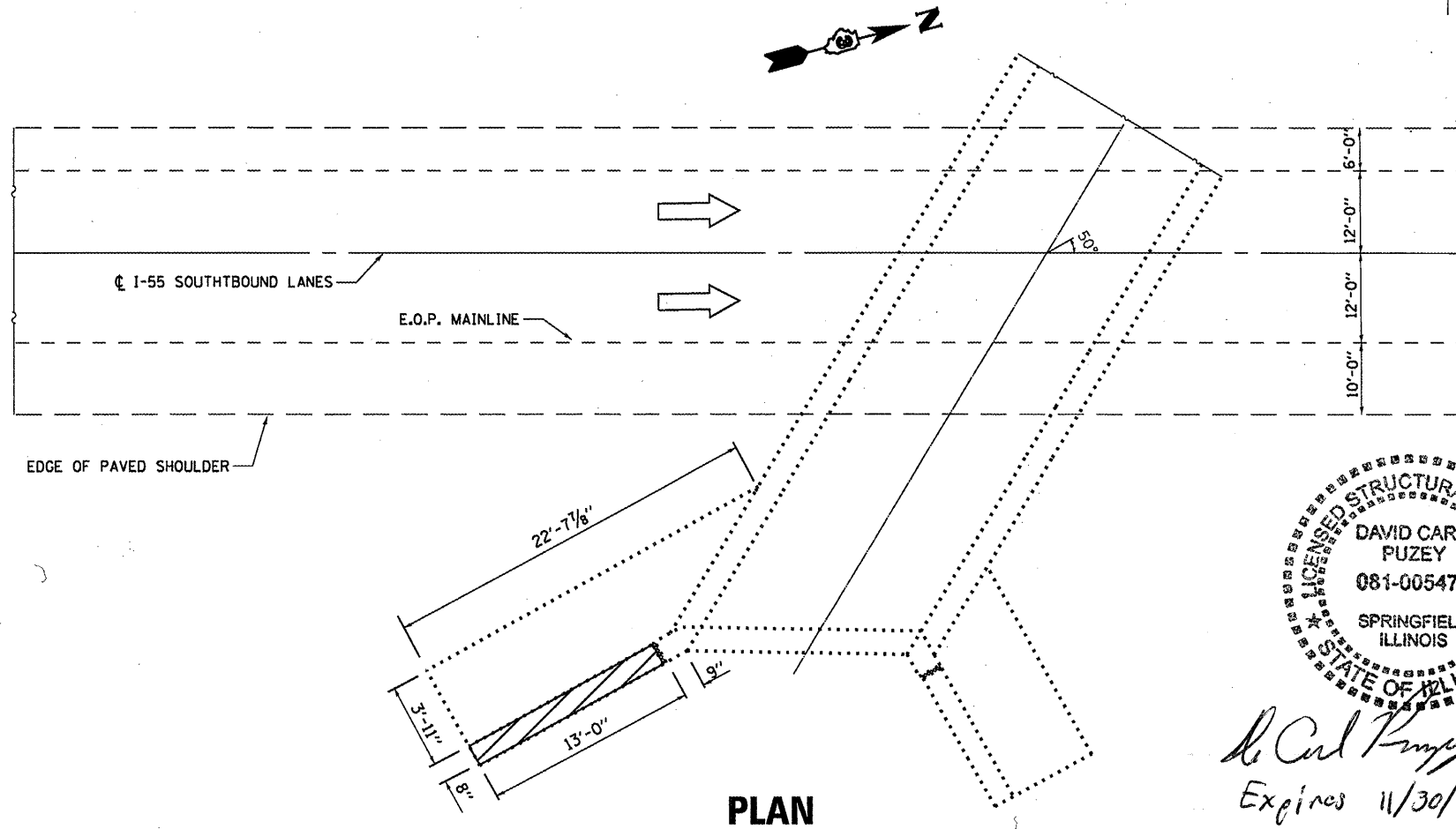

**DAMAGED WING WALL TO BE REPLACED**

**PLAN**

**TOTAL BILL OF MATERIAL**

ITEM	UNIT	TOTAL
STRUCTURE EXCAVATION	CU YD	26.0
FURNISHED EXCAVATION	CU YD	26.0
CONCRETE REMOVAL	CU YD	1.6
CONCRETE BOX CULVERTS	CU YD	1.6
REINFORCEMENT BARS (EPOXY COATED)	POUND	155.0
SHEET WATERPROOFING MEMBRANE SYSTEM	SQ YD	5.0



*David Carl Puze* 1/31/12  
 Expires 11/30/12

FILE NAME =	USER NAME = potelyj	DESIGNED - YOGESH PATEL	REVISED -
c:\pwork\poidot\potelyj\20266589\036642-sheets.dgn		DRAWN - YOGESH PATEL	REVISED -
	PLOT SCALE = 1/8" = 1' / in.	CHECKED - RON WOODSHANK	REVISED -
	PLOT DATE = 12/27/2011	DATE -	REVISED -

STATE OF ILLINOIS  
 DEPARTMENT OF TRANSPORTATION

**GENERAL PLAN AND ELEVATION  
 FOR LOCATION 6: SN 032-2519**

SCALE: SHEET NO. 2 OF 5 SHEETS STA. TO STA.

F.A.P. RTE. VAR.	SECTION VARIOUS	COUNTY VARIOUS	TOTAL SHEETS 40	SHEET NO. 34
			CONTRACT NO. 66B42	
ILLINOIS FED. AID PROJECT				