

CURVE: RTE 8 PROP 3
 PI STA. = 260+19.91
 $\Delta = 5^\circ 01' 07''$ (LT)
 $D = 0^\circ 41' 55''$
 $R = 8,202.10'$
 $T = 359.44'$
 $L = 718.43'$
 $E = 7.87'$
 P.C. STA = 256+60.46
 P.T. STA = 263+78.89

CURVE: RTE 8 EX 3
 PI STA. = 261+01.28
 $\Delta = 5^\circ 01' 33''$ (LT)
 $D = 1^\circ 00' 00''$
 $R = 6,237.6'$
 $T = 251.47'$
 $L = 502.61'$
 $E = 5.52'$
 P.C. STA. = 258+49.79
 P.T. STA. = 263+52.41

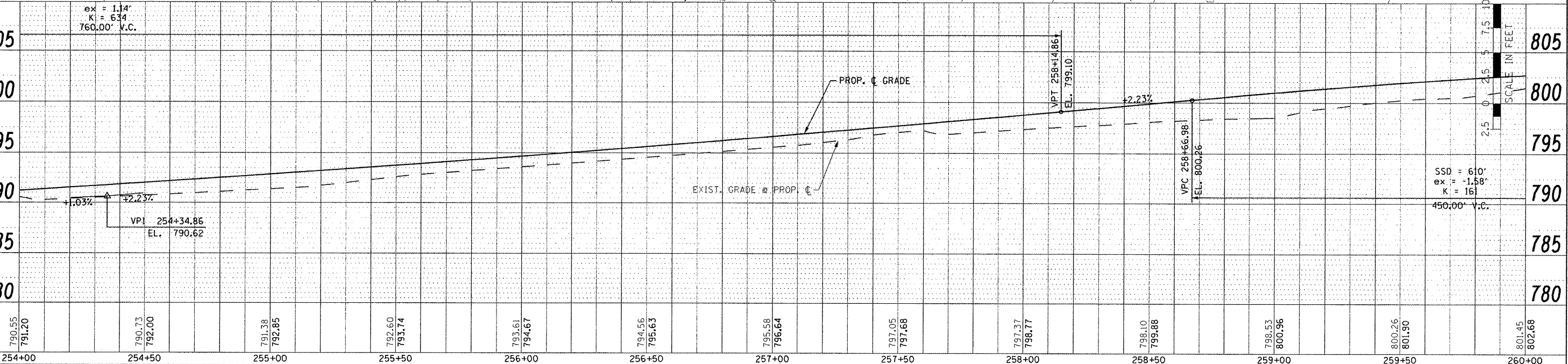
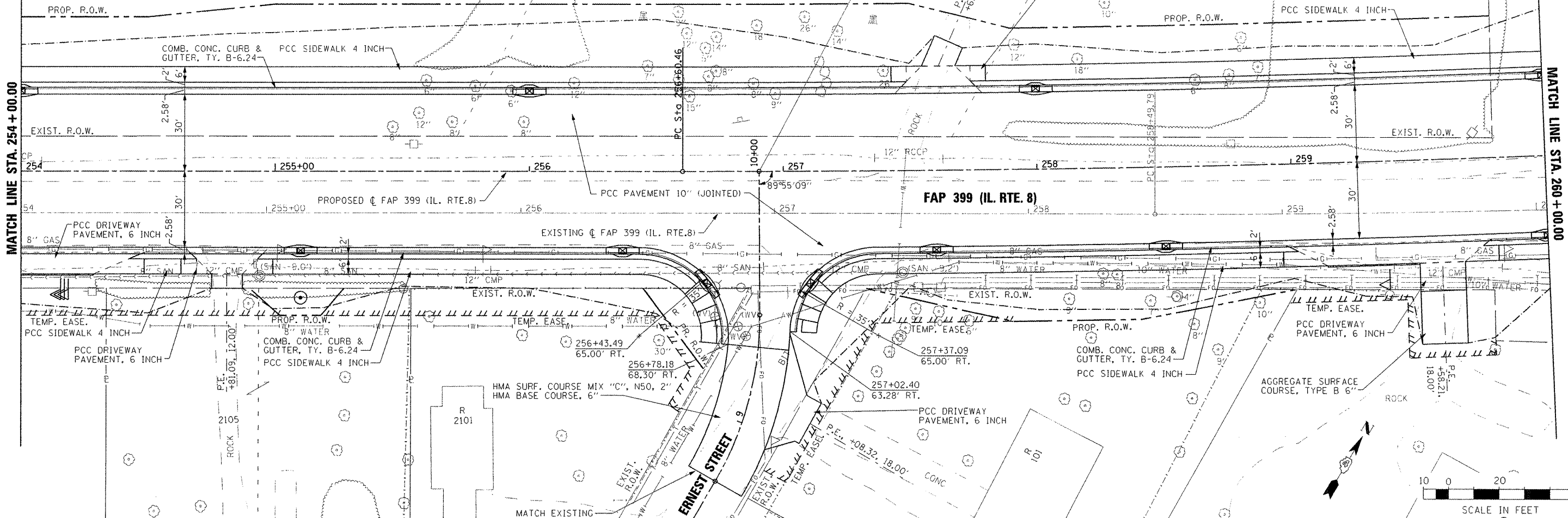

PLAN	SURVEYED	DATE
NOTE BOOK	NO. OF SHEETS	
NO. OF SHEETS	NO. OF SHEETS	
NO. OF SHEETS	NO. OF SHEETS	

PROF. P.L.	REVISIONS	DATE
NO. OF SHEETS	NO. OF SHEETS	
NO. OF SHEETS	NO. OF SHEETS	
NO. OF SHEETS	NO. OF SHEETS	

FILE NAME	USER NAME = ISDT	DESIGNED	REVISED	STATE OF ILLINOIS DEPARTMENT OF TRANSPORTATION	FAP 399 (IL. RTE. 8) ROADWAY PLAN AND PROFILE	F.A.P. RTE.	SECTION	COUNTY	TOTAL SHEETS	SHEET NO.
SCALE = 42.0000' / IN.	CHECKED	REVISED	399			36 R-7	TAZEWELL	390	63	
DATE = 10/31/2011	DATE	REVISED	CONTRACT NO. 68370							
SCALE: AS SHOWN SHEET NO. OF SHEETS STA. 254+00.00 TO STA. 260+00.00						ILLINOIS FED. AID PROJECT				