

**TEMPORARY SOIL RETENTION SYSTEM DETAIL**  
NOT TO SCALE

TEMPORARY SOIL RETENTION SYSTEM	
LOCATION	AREA
7.5' RT STA 208+83.5 TO 209+09.5	225

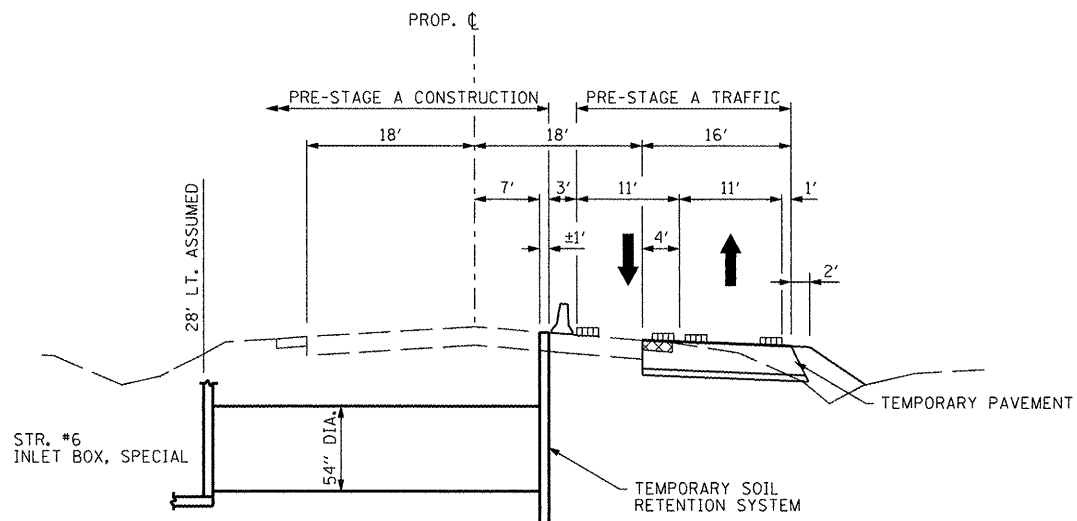

**MAINTENANCE OF TRAFFIC CROSS SECTION - PRE-STAGE A**  
STA. 208+96

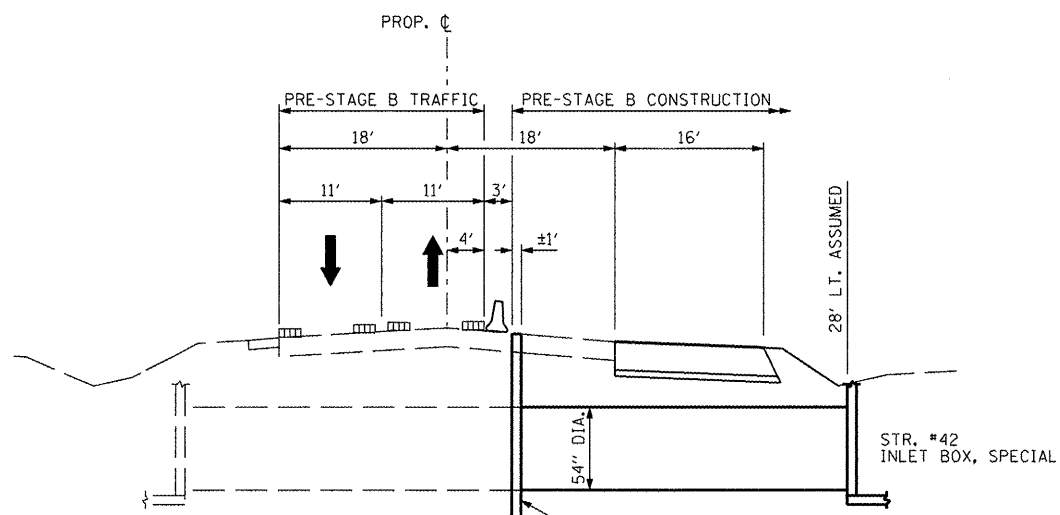

**MAINTENANCE OF TRAFFIC CROSS SECTION - PRE-STAGE B**  
STA. 208+96

**LEGEND**

- EXISTING PAVEMENT MARKING
- TEMPORARY PAVEMENT MARKING
- PROPOSED PAVEMENT MARKING
- DRUM, WITH STEADY BURNING LIGHT
- TEMPORARY CONCRETE BARRIER
- CONSTRUCTION THIS STAGE
- VERTICAL PANEL WITH STEADY BURNING LIGHT
- EXISTING TRAFFIC LANE IN USE
- TRAFFIC LANE

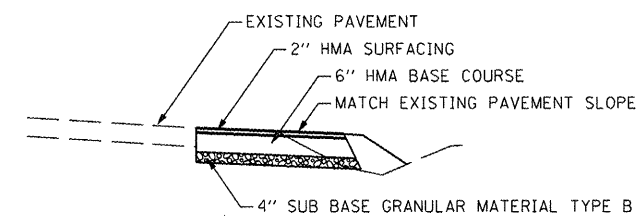

**TEMPORARY PAVEMENT DETAIL, HMA OPTION**  
NOT TO SCALE

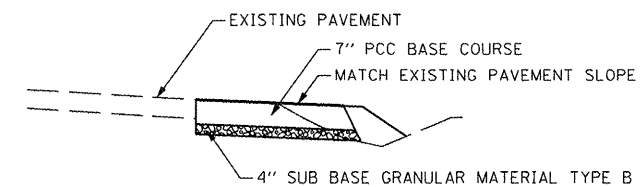

**TEMPORARY PAVEMENT DETAIL, PCC OPTION**  
NOT TO SCALE

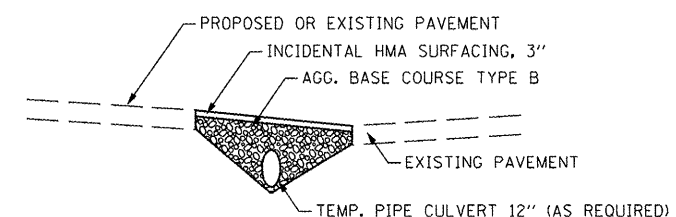

**TEMPORARY ACCESS TO SIDE STREETS**  
NOT TO SCALE

NOTE:  
SEE SHEET 31 FOR SCHEDULE

FILE NAME =	USER NAME = IDOT	DESIGNED -	REVISED -
ks:\projects\200803566\dgn\04-Rte8-sh-t-5	aging-Typ-1-1.dgn	DRAWN -	REVISED -
	PLOT SCALE = 20:624 FT / IN.	CHECKED -	REVISED -
	PLOT DATE = 10/21/2011	DATE = 10-21-11	REVISED -

**STATE OF ILLINOIS**  
**DEPARTMENT OF TRANSPORTATION**

**FAP 399 (IL RTE. 8)**  
**MAINT. OF TRAFFIC - TYP. SECT. PRE-STAGE & SOIL RETENTION SYSTEM**

SCALE: AS SHOWN SHEET NO. OF SHEETS STA. TO STA.

F.A.P. RTE.	SECTION	COUNTY	TOTAL SHEETS	SHEET NO.
399	36 R-7	TAZEWELL	390	77
CONTRACT NO. 68370			ILLINOIS FED. AID PROJECT	