

DATE	
BY	
PLAN	SURVEYED
	ALIGNED
	CHECKED
	PT. OF WAY CHECKED
	NO. _____
	ADD FILE NAME
	NO. _____

DATE	
BY	
PROFILE	SURVEYED
	PLOTTED
	CHECKED
	NO. _____
	ADD FILE NAME
	NO. _____

STRUCTURE #131
STA. 263+75.00, 30.0' LT
INLET, TYPE G-1
RIM ELEV = 803.07
INV ELEV = 799.57 (12" E)

STRUCTURE #132
STA. 265+10.00, 30.0' LT
INLET, TYPE G-1
RIM ELEV = 802.36
INV ELEV = 798.90 (12" W)
INV ELEV = 798.70 (12" E)

STRUCTURE #130
STA. 260+00.00, 30.0' LT
INLET, TYPE G-1
RIM ELEV = 802.08
INV ELEV = 798.58 (12" N)

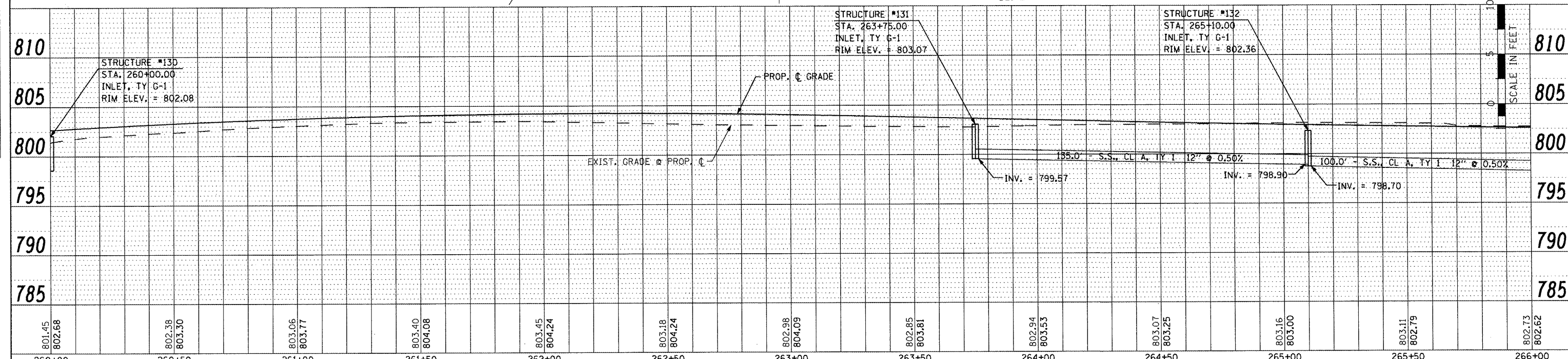
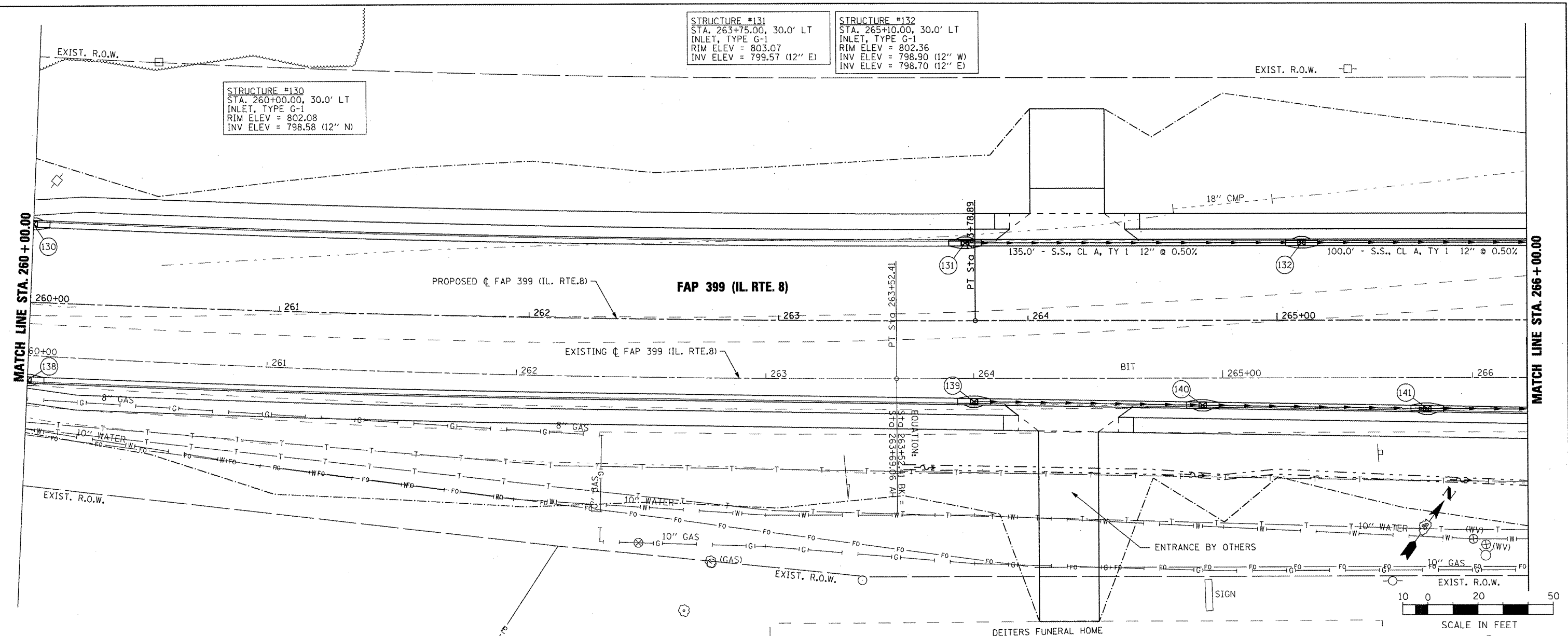

FILE NAME =	USER NAME = IDOT	DESIGNED -	REVISED -	STATE OF ILLINOIS DEPARTMENT OF TRANSPORTATION FAP 399 (IL. RTE. 8) DRAINAGE PLAN AND PROFILE - NORTH				F.A. RTE.	SECTION	COUNTY	TOTAL SHEETS	SHEET NO.
x:\projects\288983566\dgn\04-Rte8-shd-DRAIN-11.NORTH.dgn		DRAWN -	REVISED -					399	36 R-7	TAZEWELL	390	187
PLOT SCALE = 40.0000' / IN.		CHECKED -	REVISED -					CONTRACT NO. 68370				
PLOT DATE = 10/21/2011		DATE -	REVISED -					ILLINOIS FED. AID PROJECT				
				SCALE: AS SHOWN				SHEET NO. OF SHEETS STA. 260+00.00 TO STA. 266+00.00				