

DATE	
BY	
REVISIONS	
NO.	
DESCRIPTION	
DATE	
BY	
REVISIONS	
NO.	
DESCRIPTION	
DATE	
BY	
REVISIONS	
NO.	
DESCRIPTION	

DATE	
BY	
REVISIONS	
NO.	
DESCRIPTION	
DATE	
BY	
REVISIONS	
NO.	
DESCRIPTION	
DATE	
BY	
REVISIONS	
NO.	
DESCRIPTION	

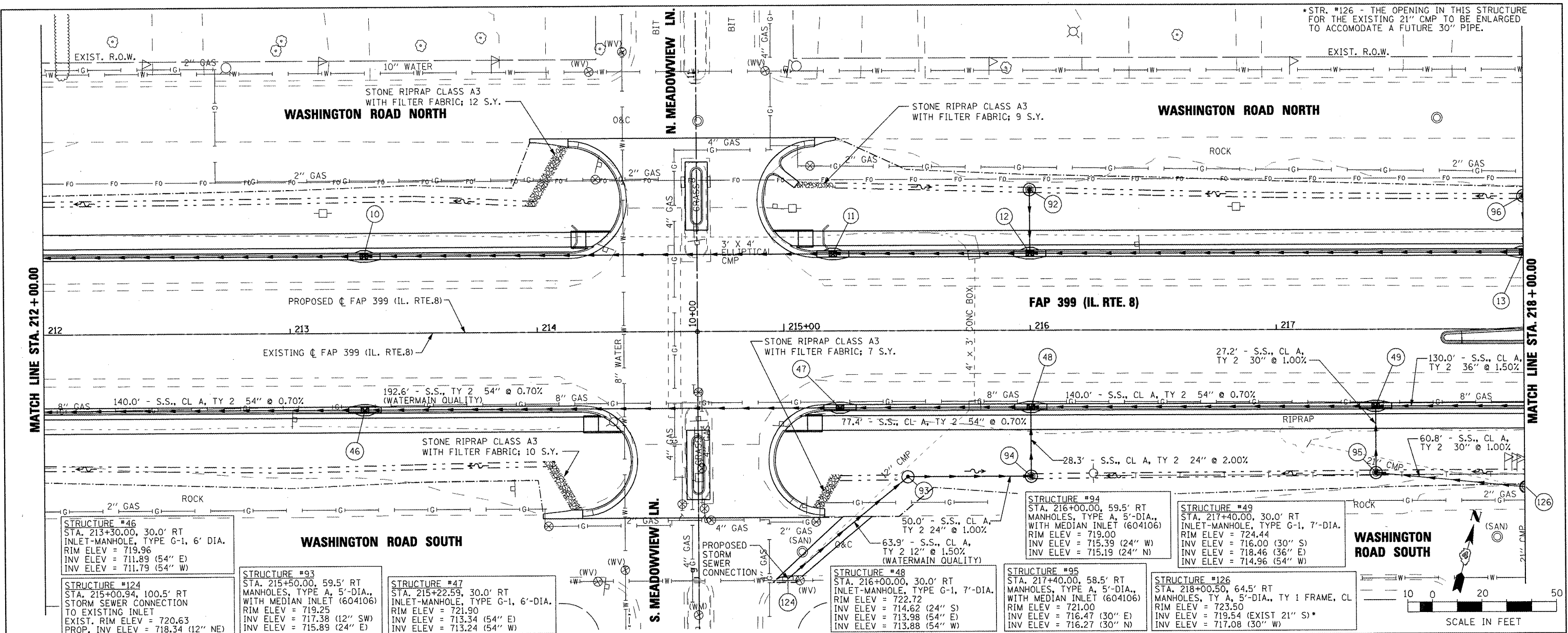

*STR. #126 - THE OPENING IN THIS STRUCTURE FOR THE EXISTING 21" CMP TO BE ENLARGED TO ACCOMMODATE A FUTURE 30" PIPE.

STRUCTURE #46
STA. 213+30.00, 30.0' RT
INLET-MANHOLE, TYPE G-1, 6' DIA.
RIM ELEV = 719.96
INV ELEV = 711.89 (54" E)
INV ELEV = 711.79 (54" W)

STRUCTURE #124
STA. 215+00.94, 100.5' RT
STORM SEWER CONNECTION
TO EXISTING INLET
EXIST. RIM ELEV = 720.63
PROP. INV ELEV = 718.34 (12" NE)

STRUCTURE #93
STA. 215+50.00, 59.5' RT
MANHOLES, TYPE A, 5'-DIA.,
WITH MEDIAN INLET (604106)
RIM ELEV = 719.25
INV ELEV = 717.38 (12" SW)
INV ELEV = 715.89 (24" E)

STRUCTURE #47
STA. 215+22.59, 30.0' RT
INLET-MANHOLE, TYPE G-1, 6'-DIA.
RIM ELEV = 721.90
INV ELEV = 713.34 (54" E)
INV ELEV = 713.24 (54" W)

STRUCTURE #48
STA. 216+00.00, 30.0' RT
INLET-MANHOLE, TYPE G-1, 7'-DIA.
RIM ELEV = 722.72
INV ELEV = 714.62 (24" S)
INV ELEV = 713.98 (54" E)
INV ELEV = 713.88 (54" W)

STRUCTURE #94
STA. 216+00.00, 59.5' RT
MANHOLES, TYPE A, 5'-DIA.,
WITH MEDIAN INLET (604106)
RIM ELEV = 719.00
INV ELEV = 715.39 (24" W)
INV ELEV = 715.19 (24" N)

STRUCTURE #95
STA. 217+40.00, 58.5' RT
MANHOLES, TYPE A, 5'-DIA.,
WITH MEDIAN INLET (604106)
RIM ELEV = 724.44
INV ELEV = 716.47 (30" E)
INV ELEV = 716.27 (30" N)

STRUCTURE #49
STA. 217+40.00, 30.0' RT
INLET-MANHOLE, TYPE G-1, 7'-DIA.
RIM ELEV = 724.44
INV ELEV = 716.00 (30" S)
INV ELEV = 718.46 (36" E)
INV ELEV = 714.96 (54" W)

STRUCTURE #126
STA. 218+00.50, 64.5' RT
MANHOLES, TYPE A, 5'-DIA., TY 1 FRAME, CL
RIM ELEV = 723.50
INV ELEV = 719.54 (EXIST 21" S)
INV ELEV = 717.08 (30" W)

WASHINGTON ROAD SOUTH

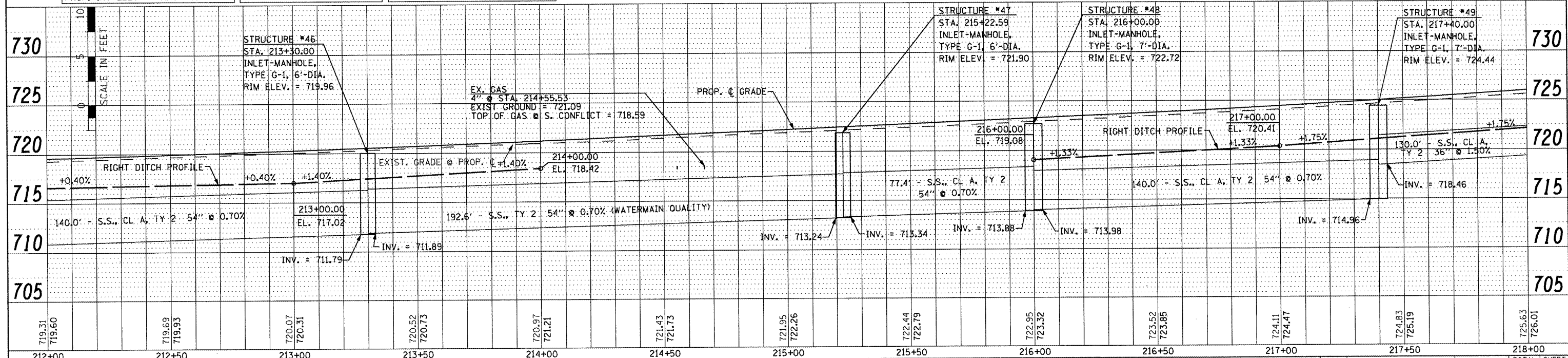
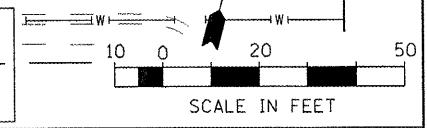

FILE NAME =	USER NAME = IDDT	DESIGNED -	REVISED -	STATE OF ILLINOIS DEPARTMENT OF TRANSPORTATION				FAP 399 (IL RTE. 8) DRAINAGE PLAN AND PROFILE - SOUTH				F.A. RTE.	SECTION	COUNTY	TOTAL SHEETS	SHEET NO.					
kr\projects\200803566\dgn\04-Rte8-shd-DRAIN-3_SOUTH.dgn		DRAWN -	REVISED -									399	36 R-7	TAZEWELL	390	191					
PLOT SCALE = 40.0000' / IN.		CHECKED -	REVISED -									SCALE: AS SHOWN				SHEET NO. OF SHEETS STA. 212+00.00 TO STA. 218+00.00				CONTRACT NO. 68370	
PLOT DATE = 10/21/2011		DATE -	REVISED -									ILLINOIS FED. AID PROJECT									