

STRUCTURE #150
 STA. 251+24.76, 43.18' RT
 SAN. MH, TY. A, 4'-DIA., TY. 1 F, CL
 RIM ELEV = 787.00
 INV ELEV = 777.25 (8" N)
 INV ELEV = 777.15 (8" E)
 INV ELEV = 777.15 (8" W)

STRUCTURE #151
 STA. 11+25.00, 0.00' LT
 SAN. MH, TY. A, 4'-DIA., TY. 1 F, CL
 RIM ELEV = 788.00
 INV ELEV = 778.20 (8" N)
 INV ELEV = 778.10 (8" S)

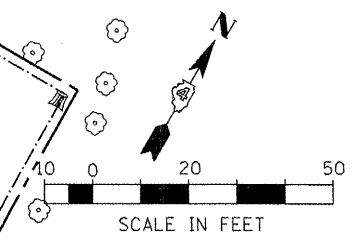

MATCH LINE STA. 248 + 00.00

MATCH LINE STA. 254 + 00.00

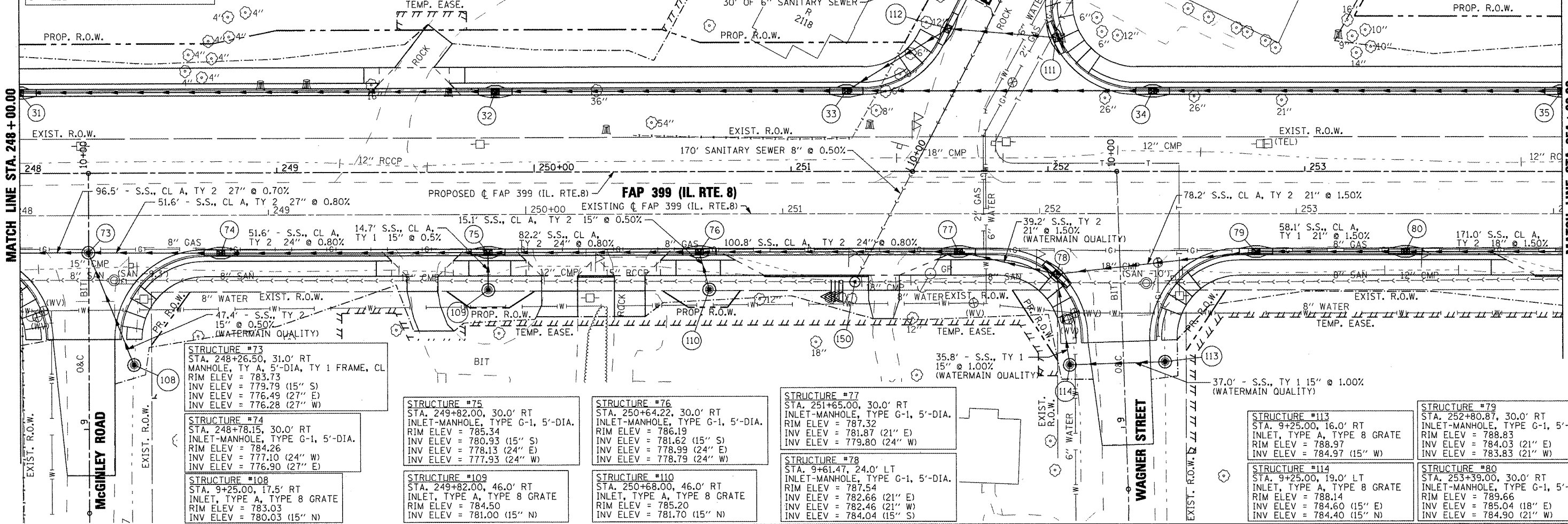

STRUCTURE #73
 STA. 248+26.50, 31.0' RT
 MANHOLE, TY A, 5'-DIA, TY 1 FRAME, CL
 RIM ELEV = 783.73
 INV ELEV = 779.79 (15" S)
 INV ELEV = 776.49 (27" E)
 INV ELEV = 776.28 (27" W)

STRUCTURE #74
 STA. 248+78.15, 30.0' RT
 INLET-MANHOLE, TYPE G-1, 5'-DIA.
 RIM ELEV = 784.26
 INV ELEV = 777.10 (24" W)
 INV ELEV = 776.90 (27" E)

STRUCTURE #108
 STA. 9+25.00, 17.5' RT
 INLET, TYPE A, TYPE 8 GRATE
 RIM ELEV = 783.03
 INV ELEV = 780.03 (15" N)

STRUCTURE #75
 STA. 249+82.00, 30.0' RT
 INLET-MANHOLE, TYPE G-1, 5'-DIA.
 RIM ELEV = 785.34
 INV ELEV = 780.93 (15" S)
 INV ELEV = 778.13 (24" E)
 INV ELEV = 777.93 (24" W)

STRUCTURE #109
 STA. 249+82.00, 46.0' RT
 INLET, TYPE A, TYPE 8 GRATE
 RIM ELEV = 784.50
 INV ELEV = 781.00 (15" N)

STRUCTURE #76
 STA. 250+64.22, 30.0' RT
 INLET-MANHOLE, TYPE G-1, 5'-DIA.
 RIM ELEV = 786.19
 INV ELEV = 781.62 (15" S)
 INV ELEV = 778.99 (24" E)
 INV ELEV = 778.79 (24" W)

STRUCTURE #110
 STA. 250+68.00, 46.0' RT
 INLET, TYPE A, TYPE 8 GRATE
 RIM ELEV = 785.20
 INV ELEV = 781.70 (15" N)

STRUCTURE #77
 STA. 251+65.00, 30.0' RT
 INLET-MANHOLE, TYPE G-1, 5'-DIA.
 RIM ELEV = 787.32
 INV ELEV = 781.87 (21" E)
 INV ELEV = 779.80 (24" W)

STRUCTURE #78
 STA. 9+61.47, 24.0' LT
 INLET-MANHOLE, TYPE G-1, 5'-DIA.
 RIM ELEV = 787.54
 INV ELEV = 782.66 (21" E)
 INV ELEV = 782.46 (21" W)
 INV ELEV = 784.04 (15" S)

STRUCTURE #113
 STA. 9+25.00, 16.0' RT
 INLET, TYPE A, TYPE 8 GRATE
 RIM ELEV = 788.97
 INV ELEV = 784.03 (21" E)
 INV ELEV = 783.83 (21" W)

STRUCTURE #114
 STA. 9+25.00, 19.0' LT
 INLET, TYPE A, TYPE 8 GRATE
 RIM ELEV = 788.14
 INV ELEV = 784.60 (15" E)
 INV ELEV = 784.40 (15" N)

STRUCTURE #79
 STA. 252+80.87, 30.0' RT
 INLET-MANHOLE, TYPE G-1, 5'-DIA.
 RIM ELEV = 788.83
 INV ELEV = 784.03 (21" E)
 INV ELEV = 783.83 (21" W)

STRUCTURE #80
 STA. 253+39.00, 30.0' RT
 INLET-MANHOLE, TYPE G-1, 5'-DIA.
 RIM ELEV = 789.66
 INV ELEV = 785.04 (18" E)
 INV ELEV = 784.90 (21" W)

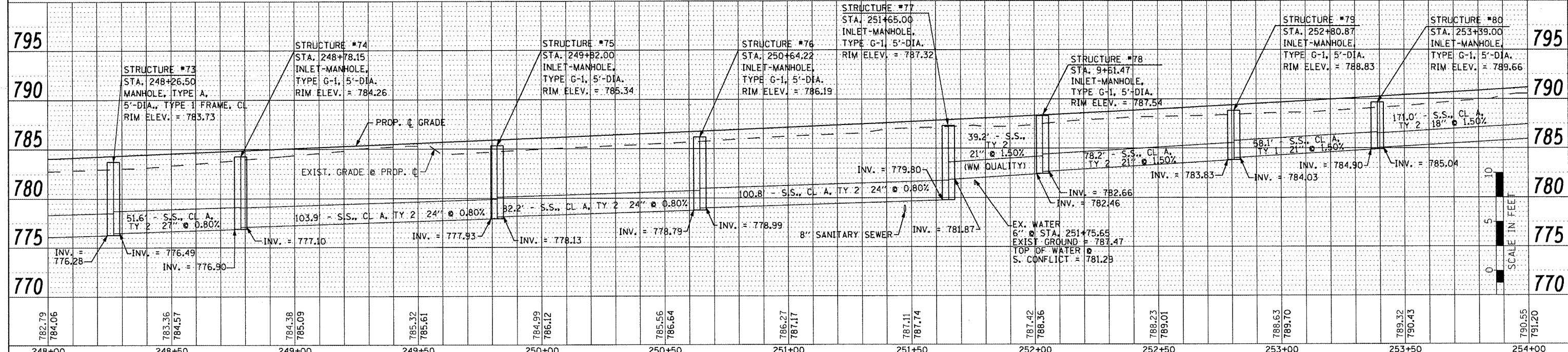

FILE NAME =	USER NAME = IDOT	DESIGNED -	REVISED -	STATE OF ILLINOIS DEPARTMENT OF TRANSPORTATION				FAP 399 (IL RTE. 8) DRAINAGE PLAN AND PROFILE - SOUTH				F.A. RTE.	SECTION	COUNTY	TOTAL SHEETS	SHEET NO.	
sr\projects\200803566\dgn\04-Rse8-shd-DRAIN-9_SOUTH.dgn		DRAWN -	REVISED -									399	36 R-7	TAZEWELL	390	197	
PLOT SCALE = 40.0000' / IN.		CHECKED -	REVISED -									CONTRACT NO. 68370					
PLOT DATE = 10/21/2011		DATE -	REVISED -									ILLINOIS FED. AID PROJECT					
SCALE: AS SHOWN												SHEET NO. OF SHEETS		STA. 248+00.00 TO STA. 254+00.00			