

DATE	
BY	
SURVEYED	
ALIGNED	
CHECKED	
RT. OF WAY	
CHECKED	
NO. OF	
ADD FILE	
NO.	

DATE	
BY	
SURVEYED	
PLOTTED	
CHECKED	
NO. OF	
STRUCTURE	
NOTATIONS	
CHKD	

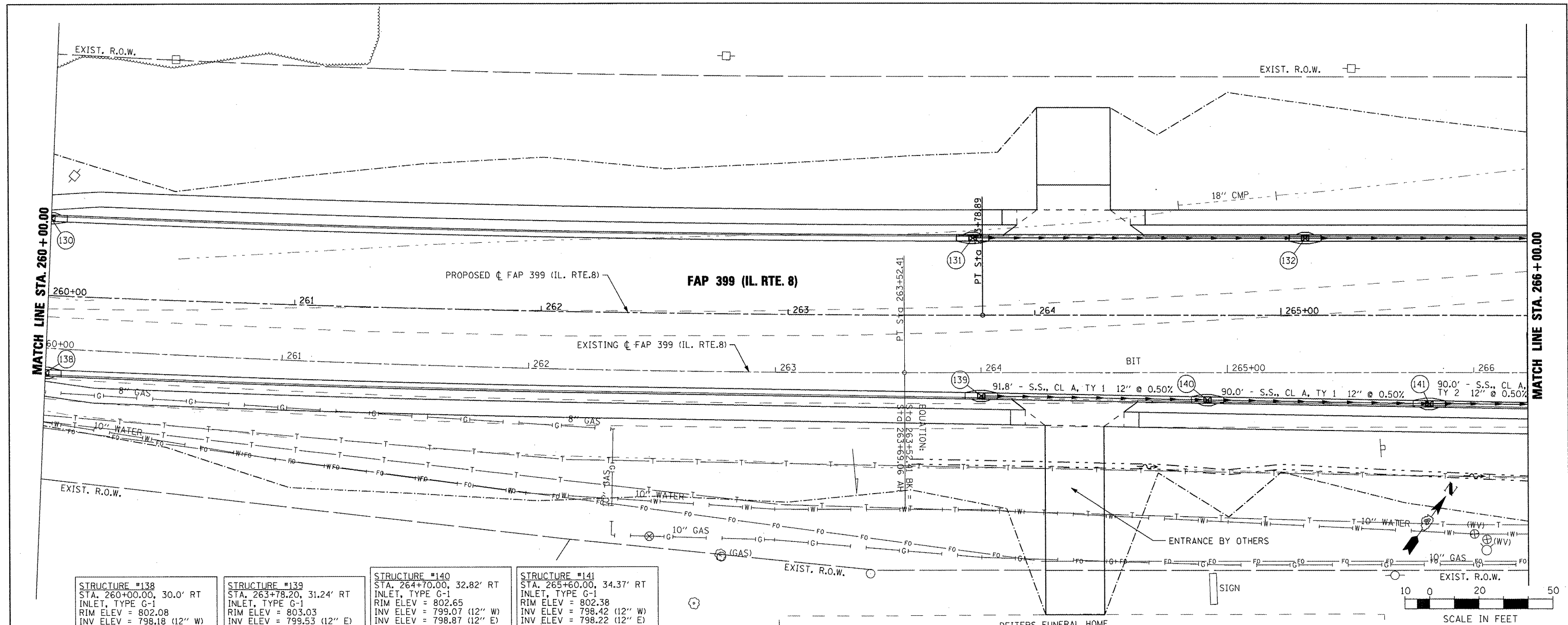

<b>STRUCTURE #138</b> STA. 260+00.00, 30.0' RT INLET, TYPE G-1 RIM ELEV. = 802.08 INV ELEV. = 798.18 (12" W)	<b>STRUCTURE #139</b> STA. 263+78.20, 31.24' RT INLET, TYPE G-1 RIM ELEV. = 803.03 INV ELEV. = 799.53 (12" E)	<b>STRUCTURE #140</b> STA. 264+70.00, 32.82' RT INLET, TYPE G-1 RIM ELEV. = 802.65 INV ELEV. = 799.07 (12" W) INV ELEV. = 798.87 (12" E)	<b>STRUCTURE #141</b> STA. 265+60.00, 34.37' RT INLET, TYPE G-1 RIM ELEV. = 802.38 INV ELEV. = 798.42 (12" W) INV ELEV. = 798.22 (12" E)
--	---	---	---

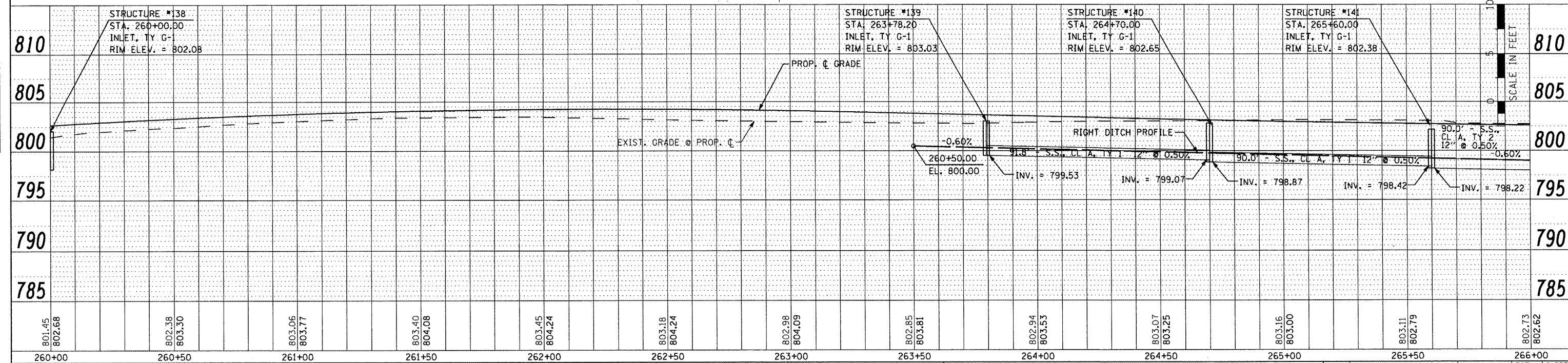

FILE NAME =	USER NAME = 100T	DESIGNED -	REVISED -	<b>STATE OF ILLINOIS DEPARTMENT OF TRANSPORTATION</b>	<b>FAP 399 (IL. RTE. 8) DRAINAGE PLAN AND PROFILE - SOUTH</b>			F.A. RTE. = 399	SECTION = 36 R-7	COUNTY = TAZEWELL	TOTAL SHEETS = 390	SHEET NO. = 199
xi\projects\200803566\dgn\D4-Rte8-shd-DRAIN-11.SOUTH.dgn		DRAWN -	REVISED -		SCALE: AS SHOWN	SHEET NO. OF SHEETS	STA. 260+00.00 TO STA. 266+00.00	ILLINOIS FED. AID PROJECT				
		CHECKED -	REVISED -									
		DATE -	REVISED -									