

STRUCTURE #142
STA. 266+50.00, 34.79' RT
INLET, TYPE G-1
RIM ELEV = 802.11
INV ELEV = 797.77 (12" W)
INV ELEV = 797.57 (12" E)

STRUCTURE #143
STA. 267+40.00, 34.43' RT
INLET, TYPE G-1
RIM ELEV = 801.84
INV ELEV = 797.12 (12" W)
INV ELEV = 796.92 (15" E)

STRUCTURE #144
STA. 268+30.00, 36.3' RT
INLET, TYPE G-1
RIM ELEV = 801.57
INV ELEV = 796.47 (15" W)
INV ELEV = 796.27 (15" E)

STRUCTURE #145
STA. 269+27.00, 43.23' RT
INLET-MANHOLE, TYPE G-1, 4'-DIA.
RIM ELEV = 801.08
INV ELEV = 796.10 (12" E)
INV ELEV = 795.77 (15" W)
INV ELEV = 794.35 (EXIST 24" S)
INV ELEV = 794.35 (EXIST 24" N)

STRUCTURE #146
STA. 270+10.00, 46.66' RT
INLET, TYPE G-1
RIM ELEV = 800.85
INV ELEV = 796.71 (12" E)
INV ELEV = 796.51 (12" W)

STRUCTURE #147
STA. 270+90.00, 47.19' RT
INLET, TYPE G-1
RIM ELEV = 800.61
INV ELEV = 797.11 (12" W)

DATE	
BY	
REVISIONS	
PLANNED	
CHECKED	
DATE	
NO.	

DATE	
BY	
REVISIONS	
PLANNED	
CHECKED	
DATE	
NO.	

MATCH LINE STA. 266+00.00

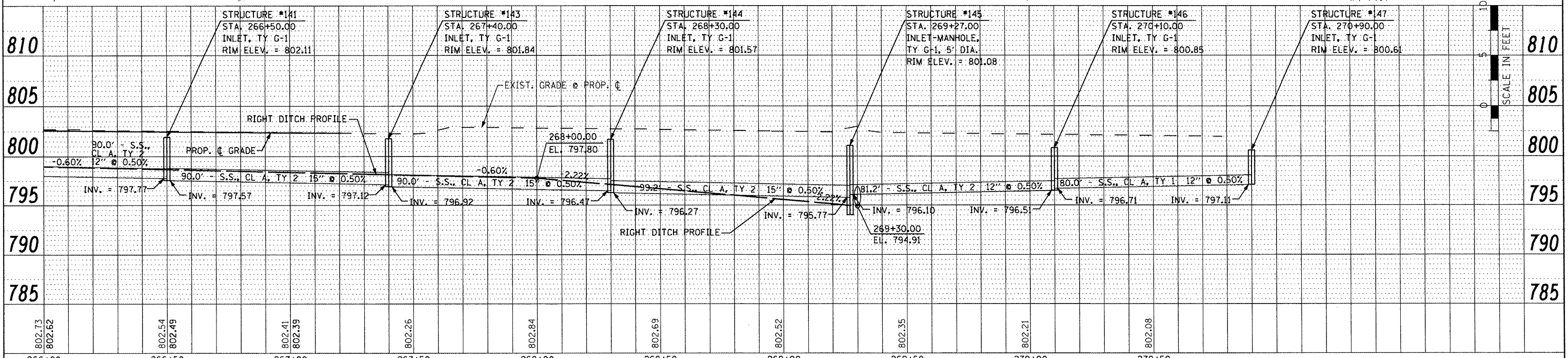
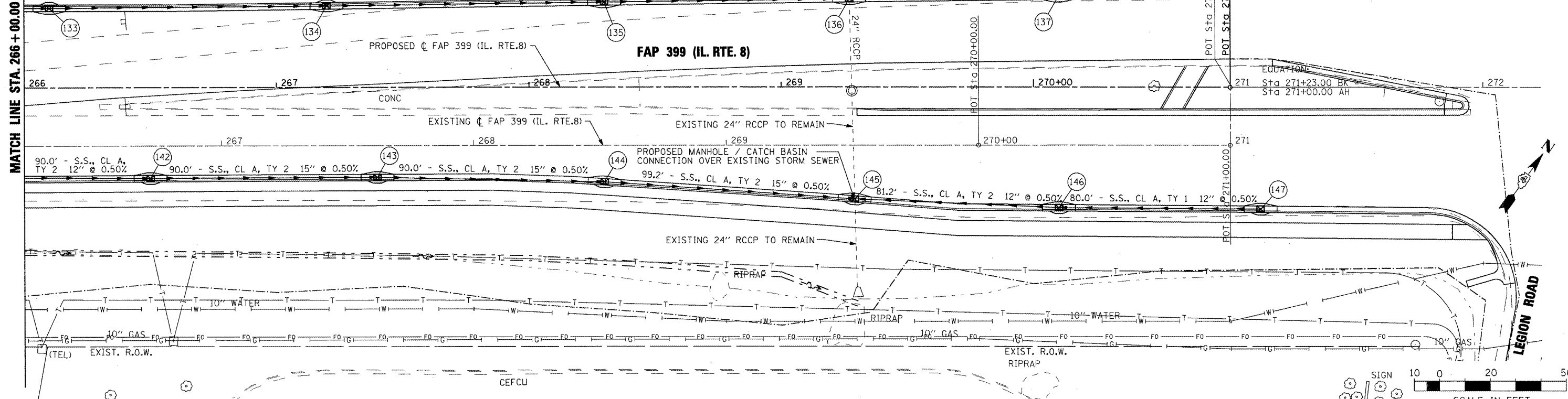

FILE NAME =	USER NAME = IDDT	DESIGNED -	REVISED -	STATE OF ILLINOIS DEPARTMENT OF TRANSPORTATION		FAP 399 (IL. RTE. 8) DRAINAGE PLAN AND PROFILE - SOUTH		F.A. RTE.	SECTION	COUNTY	TOTAL SHEETS	SHEET NO.
x:\p\ra\jeats\220883566\dgn\04-rte8-sht-DRAIN-12_SOUTH.dgn		DRAWN -	REVISED -					399	36 R-7	TAZEWELL	390	200
	PLOT SCALE = 48.0000' / IN.	CHECKED -	REVISED -									
	PLOT DATE = 10/21/2011	DATE -	REVISED -									CONTRACT NO. 68370
												ILLINOIS FED. AID PROJECT