

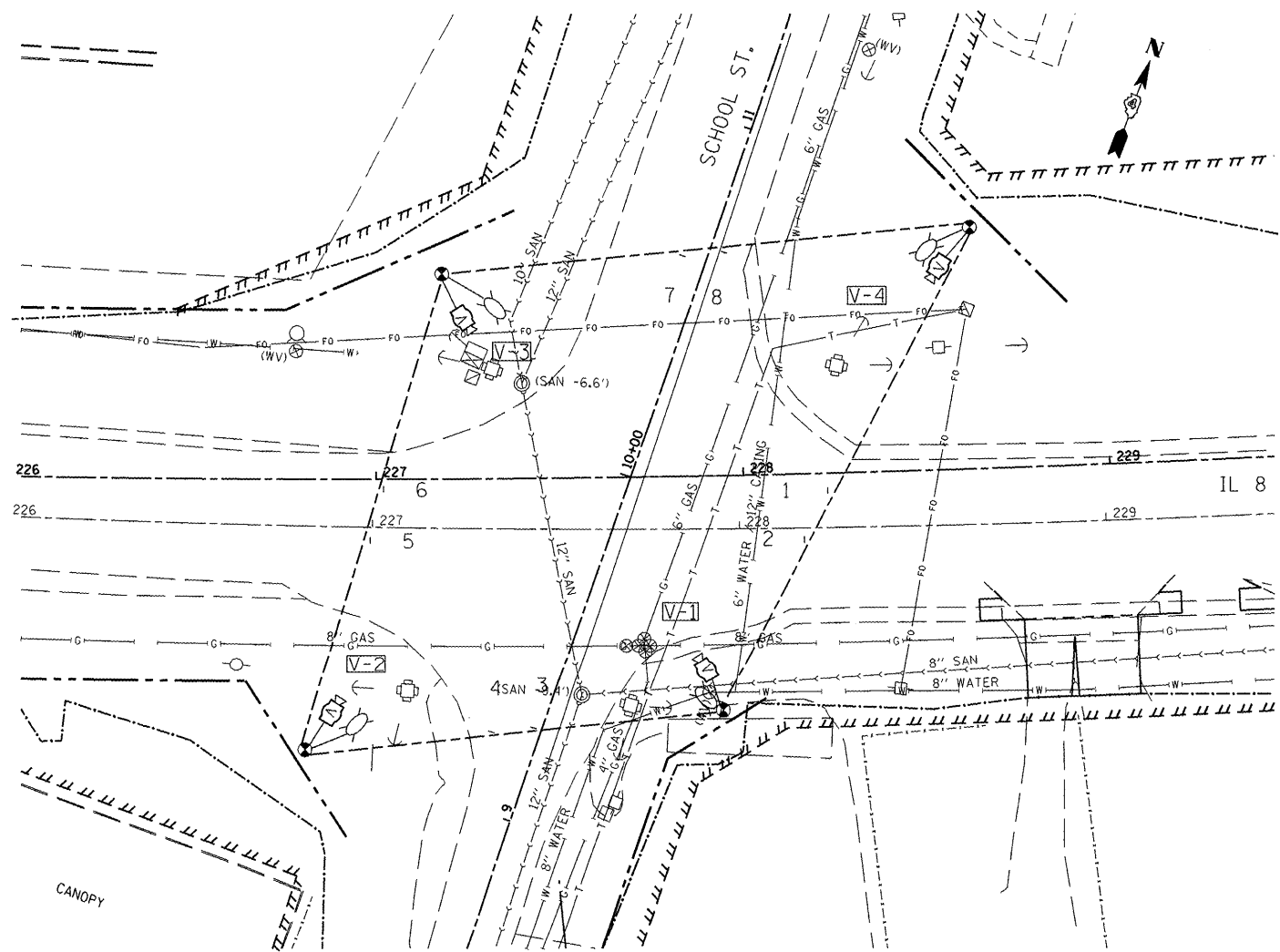

TEMPORARY TRAFFIC SIGNAL CONSTRUCTION NOTES

- T1. THE CONTRACTOR SHALL PROVIDE AND INSTALL EQUIPMENT WITH RESPECT TO THE TEMPORARY TRAFFIC SIGNAL INSTALLATION. THIS SHALL INCLUDE ALL CABLES, SIGNAL HEADS, CONDUIT, CONTROLLER AND CABINET, WOOD POLES, GUY WIRE, VIDEO DETECTION, SERVICE, 4 250W HPS LUMINAIRES WITH PHOTOCELL CONTROL, AND ALL OTHER EQUIPMENT REQUIRED FOR THE INSTALLATION.
- T2. A FOUR CAMERA VEHICLE VIDEO DETECTION SYSTEM SHALL BE USED TO PROVIDE DETECTION FOR THE TEMPORARY TRAFFIC SIGNAL INSTALLATION. THE DEPARTMENT SHALL FURNISH A FOUR CAMERA VIDEO DETECTION SYSTEM (CAMERAS WITH BRACKETS AND PROCESSOR) FOR USE WITH THE TEMPORARY INSTALLATION. THE CONTRACTOR SHALL FURNISH ALL CABLE, HARDWARE, BRACKETS, AND ACCESSORIES REQUIRED FOR A COMPLETELY FUNCTIONAL SYSTEM.
- T3. THE EXISTING CONTROLLER IS A NEMA TS-2, FULL ACTUATED, MICROPROCESSOR BASED CONTROLLER THAT IS CAPABLE OF SUPPLYING 225 SECONDS OF CYCLE LENGTH AND INDIVIDUAL PHASE LENGTH SETTINGS UP TO 99 SECONDS.
- T4. ALL TRAFFIC SIGNAL EQUIPMENT SCHEDULED FOR REMOVAL MAY BE USED FOR TEMPORARY TRAFFIC SIGNALS. ANY MAINTENANCE OF THIS EQUIPMENT WHEN USED FOR TEMPORARY TRAFFIC SIGNALS SHALL BE THE RESPONSIBILITY OF THE CONTRACTOR. ALL EQUIPMENT (EXISTING AND PROVIDED BY THE DEPARTMENT) SHALL BE DELIVERED IN GOOD WORKING CONDITION UPON REMOVAL OF THE TEMPORARY TRAFFIC SIGNAL INSTALLATION.
- T5. AERIAL TRAFFIC SIGNAL CABLE SHALL BE FURNISHED AND INSTALLED AS SHOWN ON THE PLAN SHEETS. ALL EXISTING TRAFFIC SIGNAL CABLE WILL BE REMOVED. EXISTING TRAFFIC SIGNAL HEADS MAY BE USED IN THE TEMPORARY INSTALLATION.
- T6. THE TEMPORARY TRAFFIC SIGNAL SPAN WIRES AND CABLES SHALL BE ATTACHED TO THE WOOD POLES IN A MANNER APPROVED BY THE ENGINEER. ALL CABLES SHALL MAINTAIN A 18 FT. MINIMUM CLEARANCE ABOVE THE HIGHEST POINT OF THE ROADWAY.
- T7. ALL TRAFFIC SIGNAL SECTIONS SHALL HAVE 12" LENSES.
- T8. THE TEMPORARY TRAFFIC SIGNAL HEADS SHALL BE PLACED AS INDICATED ON THE PLANS OR DIRECTED BY THE ENGINEER.
- T9. THE CONTRACTOR SHALL FURNISH ENOUGH SLACK CABLE TO RELOCATE THE HEADS TO ANY POSITION REQUIRED FOR CONSTRUCTION STAGING. THE TEMPORARY TRAFFIC SIGNALS SHALL REMAIN IN OPERATION DURING ALL SIGNAL HEAD RELOCATIONS.
- T10. THE CONTRACTOR SHALL PROVIDE ALL LABOR, EQUIPMENT, AND MATERIALS REQUIRED TO RELOCATE THE TEMPORARY TRAFFIC SIGNAL HEADS IN ACCORDANCE WITH THE PROPOSED CONSTRUCTION STAGING.
- T11. THE TRAFFIC SIGNAL INSTALLATION SHALL CONFORM TO ALL APPLICABLE MUTCD STANDARDS.
- T12. THE CONTRACTOR SHALL BE RESPONSIBLE FOR MODIFYING THE VIDEO DETECTION SYSTEM TO ACCOMODATE CONSTRUCTION STAGING (INCLUDING CAMERA AIMING AND PROGRAMMING).
- T13. ALL LABOR, MATERIALS, AND EQUIPMENT REQUIRED TO COMPLY WITH THESE REQUIREMENTS SHALL BE INCLUDED IN THE PRICE FOR TEMPORARY TRAFFIC SIGNAL INSTALLATION.



THE CONTRACTOR SHALL COORDINATE THE PLACEMENT OF WOOD POLES, GUY WIRES, AND OTHER TEMPORARY TRAFFIC SIGNAL EQUIPMENT WITH THE ENGINEER TO PREVENT CONFLICTS WITH CONSTRUCTION STAGING, PROPOSED TRAFFIC SIGNAL STRUCTURES, AND OVERHEAD UTILITIES.

TEMPORARY TRAFFIC SIGNAL LEGEND

- TEMPORARY TRAFFIC SIGNAL SPAN WIRE AND CABLE
- ⊗ TEMPORARY WOOD POLE
- ⊣ TEMPORARY TRAFFIC SIGNAL HEAD
- ⊣ TEMPORARY TRAFFIC SIGNAL HEAD WITH BACKPLATE
- ⊣ TEMPORARY PEDESTRIAN SIGNAL HEAD
- ⊣ TEMPORARY VIDEO CAMERA (FURNISHED BY DEPT.)
- ⊗ TEMPORARY LUMINAIRE, 250W HPS, MULTI-MOUNT, 45 FT. MOUNTING HEIGHT

FILE NAME =	USER NAME = IDOT	DESIGNED - LOC	REVISED -
X:\Projects\20080356\DDN\04-Rte8-sht-T	S-School.dgn	DRAWN - MBB	REVISED -
	PLOT SCALE = 77.341 FT / IN.	CHECKED - LOC	REVISED -
	PLOT DATE = 10/21/2011	DATE -	REVISED -

**STATE OF ILLINOIS
DEPARTMENT OF TRANSPORTATION**

**FAP 399 (IL RTE. 8)
TEMPORARY TRAFFIC SIGNALS - IL RTE. 8 AND SCHOOL ST.**

SCALE: 1"=20' SHEET NO. 3 OF 7 SHEETS STA. TO STA.

F.A.P. RTE.	SECTION	COUNTY	TOTAL SHEETS	SHEET NO.
399	36 R-7	TAZEWELL	390	257
				CONTRACT NO. 68370
ILLINOIS FED. AID PROJECT				