

DATE	
BY	
DESIGNED	
DRAWN	
CHECKED	
DATE	
REVISIONS	
NO.	

DATE	
BY	
DESIGNED	
DRAWN	
CHECKED	
DATE	
REVISIONS	
NO.	

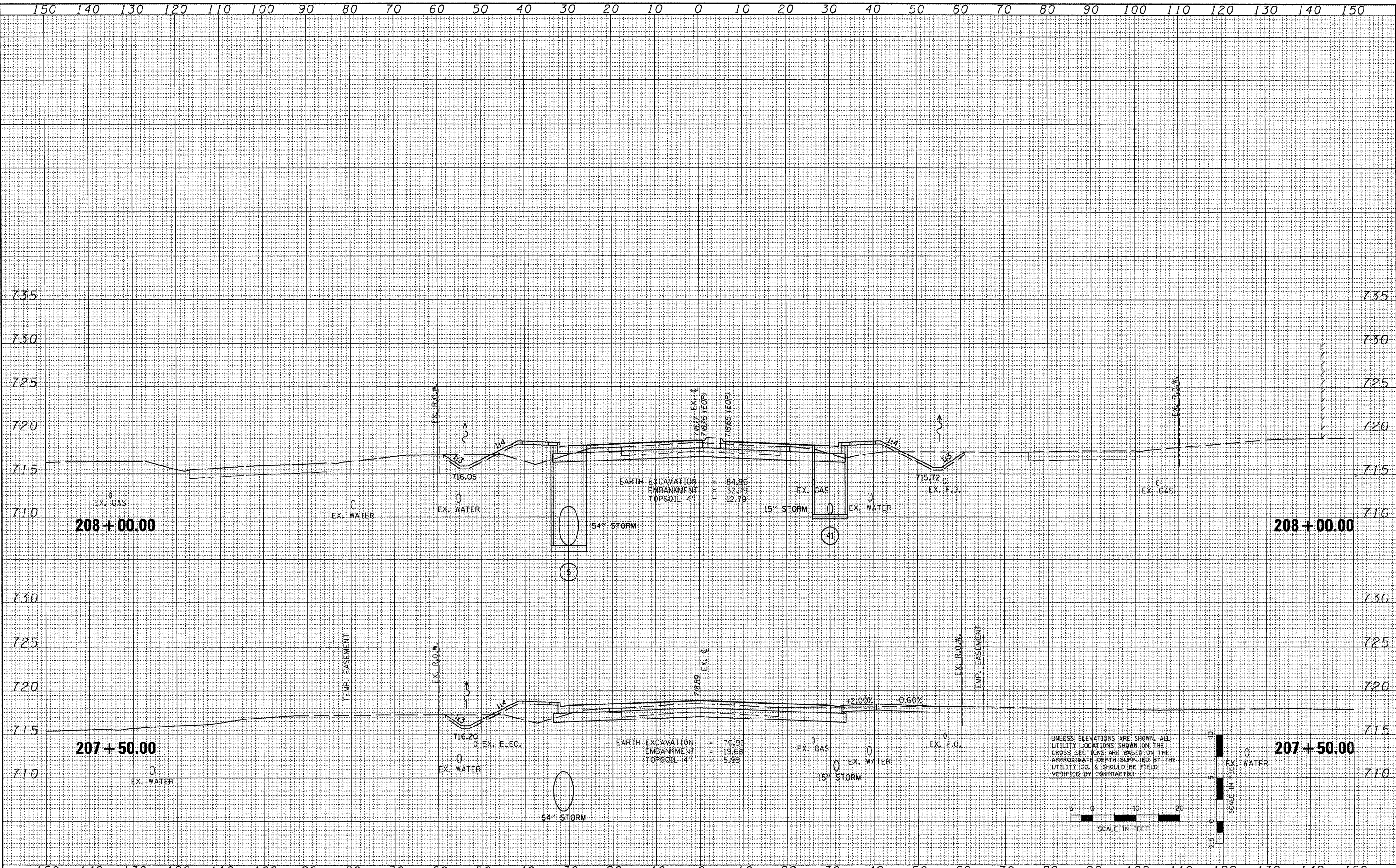

UNLESS ELEVATIONS ARE SHOWN, ALL UTILITY LOCATIONS SHOWN ON THE CROSS SECTIONS ARE BASED ON THE APPROXIMATE DEPTH SUPPLIED BY THE UTILITY CO. & SHOULD BE FIELD VERIFIED BY CONTRACTOR.

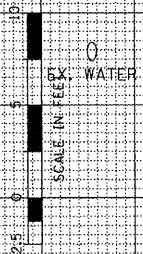
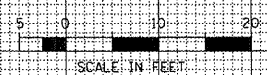

FILE NAME = w:\projects\20080356\dgn\gpk\X5-IL-R18-sheets.dgn

USER NAME = IDOT  
 PLOT SCALE = 20.7420 / IN.  
 PLOT DATE = 10/21/2011

DESIGNED	-	REVISED	-
DRAWN	-	REVISED	-
CHECKED	-	REVISED	-
DATE	- 10-21-11	REVISED	-

**STATE OF ILLINOIS  
 DEPARTMENT OF TRANSPORTATION**

**FAP 399 (IL RTE. 8)  
 CROSS SECTIONS**

SCALE: SHEET NO. OF SHEETS STA. 207+50.00 TO STA. 208+00.00

F.A.P. RTE. 399	SECTION 36 R-7	COUNTY TAZEWELL	TOTAL SHEETS 390	SHEET NO. 311
ILLINOIS FED. AID PROJECT			CONTRACT NO. 68370	